

Quick Start Guide

*HMSC7075
Wireless
Keypad Kit*



MOTOROLA
intelligence everywhere



Introduction

Congratulations on your purchase of the Motorola Wireless Keypad Kit. This module enables you to arm or disarm your entire Motorola *homesight*TM system at once upon entry or exit of your home. Its security design ensures that only a registered Keypad Key can set the system.

Using Your Home/Away Module

Position the Keypad module at an entrance to the house, near the garage door, laundry room door, or front door.

- 1 Touch your Keypad Key to the Keypad port momentarily to make digital identification.
- 2 The Keypad emits one short beep to let you know the key was read.
- 3 The status LED turns red if the key was not accepted.
- 4 The status LED turns green to let you know the key was accepted.
- 5 Push either the Home or Away button, as is appropriate. The button will flash while the system responds.
- 6 When the system finishes responding, the Keypad will beep twice and the Home/Away Port will briefly remain lighted before turning off and becoming disabled. The Keypad port will blink from there on to assist you in locating it in the dark.

Feature Locator

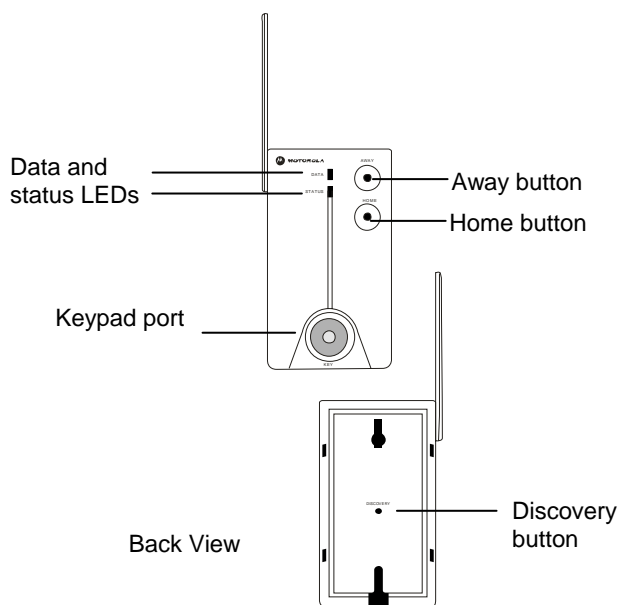

How It Works

The Wireless Keypad can communicate with the Wireless System Controller to a distance of up to 60 feet indoors, and 200 feet outdoors. The controller then relays the Home or Away setting to the Motorola *homesight*TM program, arming or disarming devices.

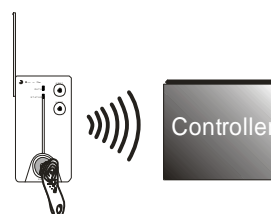

Package Contents

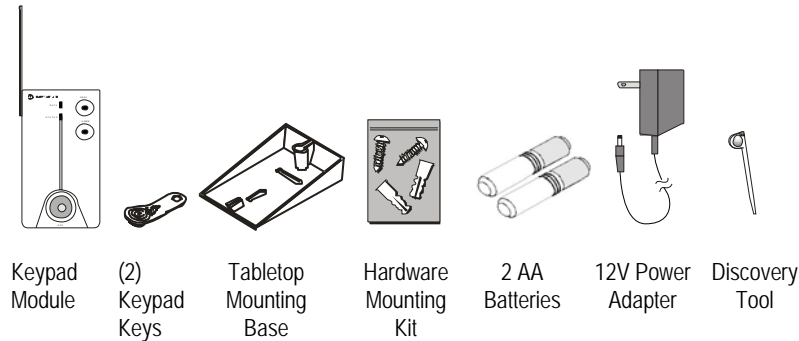

Installation Overview

To install your Keypad module:

- 1** Choose an appropriate location for the Keypad module as described in Installation Hints.
- 2** Install batteries or plug the AC adapter into the wall and the module.
- 3** Register the module with your Wireless System Controller using a process called discovery. Refer to your Wireless System Controller documentation for instructions on how to discover your Wireless Keypad.
- 4** Touch your Keypad Key(s) to the Keypad port and click on Settings/Key Management in the Motorola *homesight*™ software to see that the key has been registered.
- 5** Mount the module, using either the tabletop base, or by following the instructions for wall mounting.

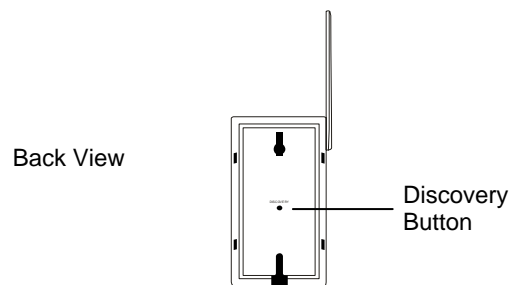

Installation Hints

The Motorola Wireless Keypad module is constructed of UV-resistant ABS plastic.

Please consider the following points when mounting the module:

- If installing the Wireless Keypad outside, it should be shielded from the elements, such as underneath a porch roof. Do not install the module where it is subjected directly to the elements.
- Typically, the module's wireless reception is good up to 60–200 feet from the Wireless System Controller depending on indoor or outdoor use and the number of obstacles. These can include metal framing, thick walls, and other wireless devices operating at 418 MHz. It is recommended that different positions be tried for optimal results.
- If battery operation is preferred, pry off the back cover by lifting the cover at the bottom area where the AC power supply would be connected. Lift and slide the cover down to remove it, and install the batteries.

Installing Your Wireless Keypad

Your module can either be mounted on a wall or sit on a horizontal surface using the included tabletop mount adapter.

Wall Mount Your Wireless Keypad

Warning: When mounting near a window, drilling too close to the glass could break the glass and possibly cause it to shatter. The window extends deeper into the frame than can be seen; therefore, ensure your screw is beyond the glass before drilling.

- 1 Using the holes on the drilling template found later in this guide, mark the position of the holes to be drilled.

For drywall or other composite surfaces use a 7/32" drill bit. Drill a hole for each of the mounting screws and insert a plastic wall anchor into each hole.

For other solid surfaces, use a 1/16" drill bit. Drill a pilot hole for each of the mounting screws.

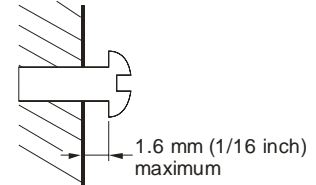

- 2 Using the screws provided, secure the module to the wall. When mounting the screws to the wall, leave 1/16" (1.6 mm) space between the screw head and the wall. Using the mounting holes, slide the module down on to the screws until it is firmly seated.

Wall Mount Drilling Template

Mounting tools: Screwdriver, electric drill or awl. On hard surfaces, Motorola recommends that you pre-drill 1/2 inch deep pilot holes with a drill bit slightly smaller than the module mounting screws before securing the module to the surface. When mounting a module on soft surfaces like sheetrock, use an awl to punch holes in the material slightly smaller than the plastic anchors included in the hardware mounting kit.

The illustration is drawn to a one-to-one scale, which means that it provides the exact dimensions required to mount the unit.

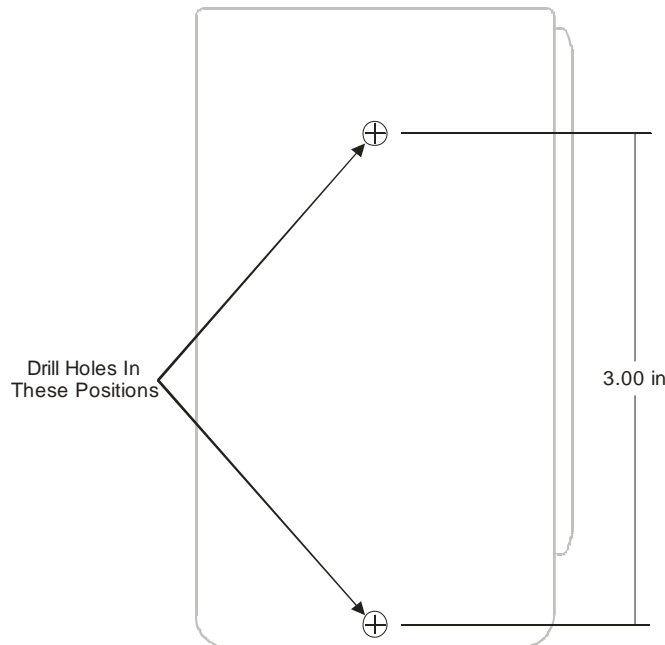
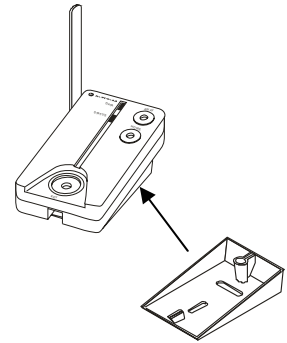

Table Mount Your Wireless Keypad

The module can be placed on any horizontal surface.

- 1** Make sure you have completed the discovery process.
- 2** Ensure that fresh batteries have been installed or that the AC adapter is connected.
- 3** Attach the tabletop adapter by pressing it on to the underside of the Keypad module.



Troubleshooting

Problem

Module will not register with the Wireless System Controller

Solution

- Ensure that the module's AC adapter is plugged in or has fresh batteries.
- Ensure that the Wireless System Controller is powered and online.
- Ensure that you are pressing the Discovery button.
- Reposition the module closer to the Wireless System Controller.
- Try another location.

The Wireless System Controller does not recognize the module during discovery mode

Make sure your Wireless System Controller indicates discovery mode and that the module is powered with fresh batteries. Press the Discovery button found inside of the battery compartment. If this continues to fail, you will need to try another location for the module. You may also try a hard reset by holding down the Discovery button while powering on the module. After resetting the module, please try to discover it again.

The status LED turns red when I touch the key to the Keypad port.

The key was not accepted by the system. Try registering the key again.

Features and Specifications

- Device signal communication
- LED in module illuminates when activity occurs
- Home and Away LEDs light when either is activated
- Weather resistant
- Hardware and base provided for either wall or table mounting
- AC power adapter included

| | |
|------------------------------------|---|
| Communication frequency: | 418 MHz |
| Typical range outdoors: | 200 feet (60 m) |
| Typical range indoors: | 60 feet (18 m) |
| Dimensions: | 3.94"L x 2.32"W x 1.10"H (100mm x 59mm x 28mm) |
| Operational temperature/ humidity: | 32° to 104° F with 10% to 80% humidity with all components operating within manufacturer thermal limits |
| Storage temperature: | -25° C to 75° C |

Regulatory Information

CAUTION: Changes or modifications not expressly approved by Motorola for compliance could void the user's authority to operate the equipment.

FCC Compliance Class B Digital Device

This equipment has been tested and found to comply with the limits for a Class B digital device, pursuant to Part 15 of the FCC Rules. These limits are designed to provide reasonable protection against harmful interference in a residential environment. This equipment generates, uses, and can radiate radio frequency energy and, if not installed and used in accordance with the instructions, may cause harmful interference to radio communications. However, there is no guarantee that interference will not occur in a particular installation. If this equipment does cause harmful interference to radio or television reception, which can be determined by turning the equipment off and on, the user is encouraged to try to correct the interference by one of the following measures:

- Reorient or relocate the receiving antenna.
- Increase the separation between the equipment and receiver.
- Connect the equipment into an outlet on a circuit different from that to which the receiver is connected.
- Consult the dealer or an experienced radio/TV technician for help.

FCC Declaration of Conformity

Motorola, Inc., Connected Home Solutions, 101 Tournament Drive, Horsham, PA 19044, 1-215-323-1000, declares under sole responsibility that the HMVC3075 complies with 47 CFR Parts 2 and 15 of the FCC Rules as Class B digital devices.

Industry Canada ICES-003 Statement

This Class B digital apparatus complies with Canadian ICES-003.

Cet appareil numérique de la classe B est conforme à la norme NMB-003 du Canada.

Restrictions on Use of Wireless Devices

In some situations or environments, the use of wireless devices may be restricted by the proprietor of the building or responsible representatives of the organization. If you are uncertain of the applicable policy for the use of wireless equipment in a specific organization or environment, you are encouraged to ask for authorization to use the device prior to turning on the equipment.

The manufacturer is not responsible for any radio or television interference caused by unauthorized modification of the devices included with this product, or the substitution or attachment of connecting cables and equipment other than specified by the manufacturer. Correction of interference caused by such unauthorized modification, substitution, or attachment is the responsibility of the user.

FCC Certification

This product contains a radio transmitter and accordingly has been certified as compliant with 47 CFR Part 15 of the FCC Rules for intentional radiators. Products that contain a radio transmitter are labeled with FCC ID and the FCC logo.

This device complies with Part 15 of FCC Rules. Operation of the device is subject to the following two conditions: (1) This device may not cause harmful interference, and (2) this device must accept any interference that may cause undesired operation.

Canada—Industry Canada (IC)

The wireless radio of this device complies with RSS 210 and RSS 102 of Industry Canada.

The use of this device in a system operating either partially or completely outdoors may require the user to obtain a license for the system according to the Canadian regulations.

Limited Warranty

Wireless Keypad

Motorola, Inc., Connected Home Solutions ("Motorola")

Limited Warranty. Motorola warrants to you, the original end user customer, that (A) the Product, excluding Software, will be materially free from defects in materials and workmanship under normal use, and (B) with respect to Software, (i) the media on which the Software is provided will be free from defects in material and workmanship under normal use, and (ii) the Software will perform materially as described in its documentation. This Limited Warranty to you, the original end user customer, continues (A) for Software and the media upon which it is provided, for a period of ninety (90) days from the date of purchase from Motorola or an authorized Motorola reseller, and (B) for the Product (excluding Software), for a period of one (1) year from the date of purchase from Motorola or from an authorized Motorola reseller. To take advantage of this Limited Warranty or to obtain technical support, you must call the Motorola toll-free phone number (below). Motorola's sole and exclusive obligation under this Limited Warranty for retail sales shall be to repair or replace any Product or Software that does not meet this Limited Warranty. All warranty claims must be made within the applicable Warranty Period.

General Information. The warranties described in this Section shall not apply: (i) to any Product subjected to accident, misuse, neglect, alteration, Acts of God, improper handling, improper transport, improper storage, improper use or application, improper installation, improper testing or unauthorized repair; or (ii) to cosmetic problems or defects which result from normal r and tear under ordinary use, and do not affect the performance or use of the Product. Motorola's warranties apply only to a Product that is manufactured by Motorola and identified by Motorola owned trademark, trade name or product identification logos affixed to the Product. Motorola does not warrant to you, the end user, or to anyone else that the Software will perform error free or without bugs. MOTOROLA IS NOT RESPONSIBLE FOR, AND PROVIDES "AS IS" ANY SOFTWARE SUPPLIED BY 3RD PARTIES. EXCEPT AS EXPRESSLY STATED IN THIS SECTION ("WARRANTY INFORMATION"), THERE ARE NO WARRANTIES OF ANY KIND RELATING TO THE PRODUCT, EXPRESS, IMPLIED OR STATUTORY, INCLUDING BUT NOT LIMITED TO IMPLIED WARRANTIES OF MERCHANTABILITY, FITNESS FOR A PARTICULAR PURPOSE, OR THE WARRANTY AGAINST INFRINGEMENT PROVIDED IN THE UNIFORM COMMERCIAL CODE. Some states do not allow for the exclusion of implied warranties, so the above exclusion may not apply to you.

What additional provisions should I be aware of? Because it is impossible for Motorola to know the purposes for which you acquired this Product or the uses to which you will put this Product, you assume full responsibility for the selection of the Product for its installation and use. While every reasonable effort has been made to insure that you will receive a Product that you can use and enjoy, Motorola does not warrant that the functions of the Product will meet your requirements or that the operation of the Product will be uninterrupted or error-free. MOTOROLA IS NOT RESPONSIBLE FOR PROBLEMS OR DAMAGE CAUSED BY THE INTERACTION OF THE PRODUCT WITH ANY OTHER SOFTWARE OR HARDWARE. ALL WARRANTIES ARE VOID IF THE PRODUCT IS OPENED, ALTERED, AND/OR DAMAGED.

THESE ARE YOUR SOLE AND EXCLUSIVE REMEDIES for any and all claims that you may have arising out of or in connection with this Product, whether made or suffered by you or another person and whether based in contract or tort.

THIS PRODUCT IS INTENDED ONLY FOR USE TO FACILITATE HOME MONITORING AND CONTROL AND IS NOT INTENDED TO BE A SUBSTITUTE FOR A HOME SECURITY SYSTEM. MOTOROLA HEREBY DISCLAIMS ANY LIABILITY WHATSOEVER THAT MAY ARISE FROM THE USE OR INABILITY TO USE THIS PRODUCT AS A HOME SECURITY SYSTEM. IN NO EVENT SHALL MOTOROLA BE LIABLE TO YOU OR ANY OTHER PARTY FOR ANY DIRECT, INDIRECT, GENERAL, SPECIAL, INCIDENTAL, CONSEQUENTIAL, EXEMPLARY OR OTHER DAMAGES ARISING OUT OF THE USE OR INABILITY TO USE THE PRODUCT (INCLUDING, WITHOUT LIMITATION, DAMAGES FOR INJURY, LOSS OF PROPERTY, BUSINESS PROFITS, BUSINESS INTERRUPTION, LOSS OF INFORMATION OR ANY OTHER PECUNIARY LOSS), OR FROM ANY BREACH OF WARRANTY, EVEN IF MOTOROLA HAS BEEN ADVISED OF THE POSSIBILITY OF SUCH DAMAGES. IN NO CASE SHALL MOTOROLA'S LIABILITY EXCEED THE AMOUNT YOU PAID FOR THE PRODUCT.

THIS PRODUCT EMPLOYS WIRELESS TECHNOLOGY AND, IN SOME CASES, MAY FACILITATE TRANSMISSION OF DATA OR VIDEO OVER THE INTERNET IN CONNECTION WITH ITS USE. THE CUSTOMER SHOULD UNDERSTAND THAT ALL WIRELESS TRANSMISSIONS MAY BE SUBJECT TO INTERCEPTION AND THAT DATA TRANSMISSION OVER THE INTERNET CANNOT BE GUARANTEED TO BE 100% SECURE. AS A RESULT, MOTOROLA CANNOT ENSURE OR WARRANT THE SECURITY OF ANY VIDEO OR DATA TRANSMITTED BY OR THROUGH THIS PRODUCT, WHETHER OR NOT TRANSMITTED VIA THE INTERNET, AND THE CUSTOMER USES SUCH PRODUCT AT HIS OR HER OWN RISK.

These matters are governed by the laws of the Commonwealth of Pennsylvania, without regard to conflict of laws principles and excluding the provisions of the United Nations Convention on Contracts for the International Sale of Goods.

Please call the Motorola toll-free number, 1-877-466-8646, for technical support or warranty service.

Battery Life

For your Motorola *homesight*[™] devices that require batteries, use high-quality, non-corrosive batteries designed for use in electronic equipment. **Do not use rechargeable batteries in any Motorola *homesight*[™] device.**

Registration

Register your product at:

<http://broadbandregistration.motorola.com>

Visit our website at:

<http://www.motorola.com/homemonitoring>



Copyright © 2005 by Motorola, Inc.

All rights reserved. No part of this publication may be reproduced in any form or by any means or used to make any derivative work (such as translation, transformation or adaptation) without written permission from Motorola, Inc.

Motorola reserves the right to revise this publication and to make changes in content from time to time without obligation on the part of Motorola to provide notification of such revision or change. Motorola provides this guide without warranty of any kind, either implied or expressed, including, but not limited to, the implied warranties of merchantability and fitness for a particular purpose. Motorola may make improvements or changes in the product(s) described in this manual at any time.

MOTOROLA and the Stylized M Logo are registered in the US Patent & Trademark Office. All other product or service names are the property of their respective owners.

520387-001

5/2005

MGBI

Free Manuals Download Website

<http://myh66.com>

<http://usermanuals.us>

<http://www.somanuals.com>

<http://www.4manuals.cc>

<http://www.manual-lib.com>

<http://www.404manual.com>

<http://www.luxmanual.com>

<http://aubethermostatmanual.com>

Golf course search by state

<http://golfingnear.com>

Email search by domain

<http://emailbydomain.com>

Auto manuals search

<http://auto.somanuals.com>

TV manuals search

<http://tv.somanuals.com>