

PHILIPS

NORELCO

Stubble
Trimmer



QT4021

Rechargeable
Cordless/Cord

Register your product and get support at
www.philips.com/norelco All Manuals Search And Download

IMPORTANT SAFETY INSTRUCTIONS

When using an electrical appliance, basic safety precautions should always be followed, including the following:

Read all instructions before using this appliance.

DANGER

To reduce the risk of electric shock:

1. Do not reach for a trimmer that has fallen into water. Unplug immediately.
2. Do not use while bathing or in a shower.
3. Do not place or store trimmer where it can fall or be pulled into a tub or sink. Do not place in or drop into water or other liquid.
4. Always unplug this trimmer from the electrical outlet immediately after using, except when trimmer is (re)charging.
5. Unplug trimmer before cleaning.

WARNING

To reduce the risk of burns, fire, electric shock or injury to persons:

1. Close supervision is necessary when this appliance is used by, on, or near children or invalids.
2. Use this trimmer for its intended household use as described in this manual. Do not use attachments not recommended by Philips Electronics North America Corporation.
3. Never operate this trimmer if it has a damaged cord or plug, if it is not working properly, if it has been dropped, damaged, or dropped into water. For assistance call 1-800-243-3050.
4. Do not rinse or immerse the trimmer in water or any other liquid.
5. Keep the trimmer, cord and any attachments away from heated surfaces.
6. Never drop or insert any object into any opening.
7. Do not operate, charge or plug in trimmer outdoors or where aerosol (spray) products are being used or where oxygen is being administered.
8. Always check cutters, cutting unit and comb before using the trimmer. Do not use the trimmer if cutters, cutting unit or comb are damaged, as injury may occur.
9. Always attach plug to trimmer first, then to outlet. To disconnect, turn on/off switch to "OFF" position, then remove plug from outlet.
10. To prevent possible damage to the cord, do not wrap cord around the trimmer.
11. Never put trimmer in direct sunlight or store at a temperature above 140°F.
12. This trimmer is for use on human hair only. Do not use this trimmer for any other purpose.
13. Always store your trimmer, attachments and power plug in a moisture-free area. Make sure the cord is disconnected from the trimmer.

SAVE THESE INSTRUCTIONS

IMPORTANT: The power plug contains a transformer. Do not cut off the power plug to replace it with another plug as this will cause a hazardous condition.

Registration

Congratulations on your purchase and welcome to Philips Norelco!

To fully benefit from the support that Philips Norelco offers, register your product at

www.philips.com/norelco

Features

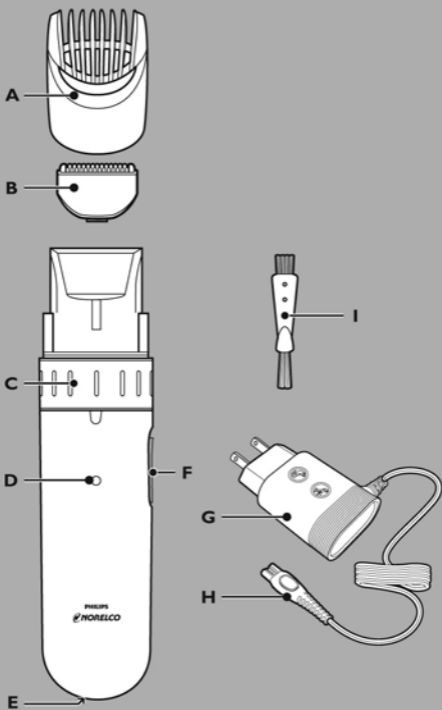

- A Guide Comb Attachment
- B Cutter Blades
- C Precision Patented Zoom Lock with 9 Pre-Select Settings
- D Charging Light
- E Socket for Appliance Plug
- F On/Off Switch
- G Adaptor
- H Appliance Plug
- I Cleaning Brush

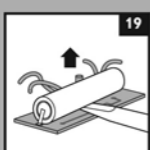
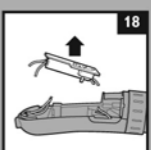
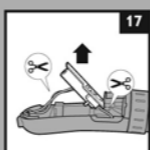
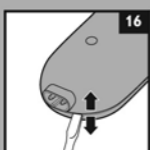
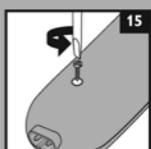
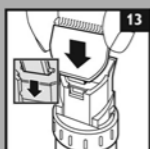
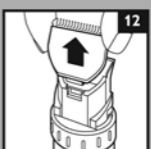
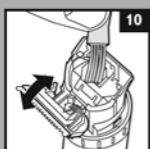
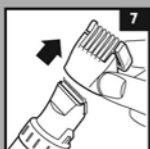
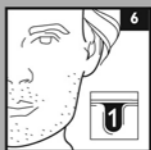
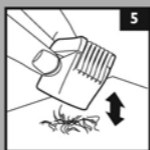
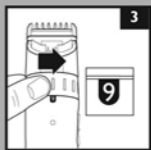
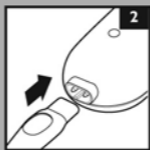
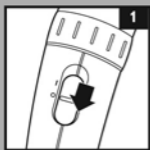

Put It To The Test

Like many new products, your Philips Norelco Stubble Trimmer may take a little getting used to. If you are using an electric Trimmer for the first time, or if you've been using a different brand, take the time to acquaint yourself with your new Trimmer.

Your Trimmer features an unique stubble look setting combined with an adjustable Zoom Lock to make beard trimming goof-proof.

Throw your scissors away and put your new Trimmer to the test. We guarantee precise, professional results or Philips Norelco will refund you the full purchase price as long as the

To Charge/Recharge

- ▶ Fully charge Trimmer before using for the first time or after non-use for a long period of time.
 - ▶ Battery performance is best if you recharge only when the battery is (almost) completely empty.
 - ▶ Charging, recharging, or using the Trimmer at temperatures below 40°F or higher than 95°F adversely affects lifespan of the battery.
 - ▶ Continuously recharging Trimmer will reduce lifespan of battery.
- 1** Be certain Trimmer is OFF (fig. 1).
 - 2** Insert the appliance plug directly into the Trimmer (fig. 2) and plug the adaptor into any 120VAC outlet. Use only the cord provided.
- ▶ An adaptor plug may be necessary for cord usage in some foreign countries. Use an attachment plug adaptor of the proper configuration for power outlet.
- 3** The Charging Light on the appliance will light to indicate the Trimmer is charging.
- ▶ It will take approximately 10 hours to fully charge the Trimmer for a cordless trimming time of up to 35 minutes.
- NOTE: After the Trimmer is fully charged, the Charging Light will remain lit.
- 4** Disconnect the cord and unplug from electrical outlet.

Optimize the working life of the battery

- ▶ After the Trimmer has been charged for the first time, do not recharge the Trimmer between trimming sessions. Continue using it until the battery is completely empty.
- ▶ Do not charge for more than 24 hours.
- ▶ Do not keep cord permanently plugged in.
- ▶ Discharge/run down the battery completely twice a year by letting the motor run until it stops.
- ▶ If the Trimmer hasn't been used for a long period of time, it must be recharged for a full 10 hours.

Corded Trimming

- ▶ Only use the Trimmer corded when the battery is empty.
 - ▶ Trimmer does not recharge during corded trimming.
- 1** Connect cord provided to Trimmer and plug Trimmer into electrical outlet.
 - 2** If battery is completely empty, wait a few minutes before switching Trimmer ON.
 - 3** Slide ON/OFF switch ON to begin trimming.
 - 4** Turn Trimmer OFF and unplug.

Cordless Trimming

- 1** Charge according to directions. Unplug Trimmer from outlet and remove cord.
- 2** Slide ON/OFF switch ON to begin trimming.
- 3** If the charge runs out while trimming, simply connect cord provided to Trimmer and outlet to continue trimming.

Cleaning

- ▶ Clean the comb attachment after each use.
- ▶ Always switch Trimmer OFF, unplug and remove power supply cord from Trimmer before cleaning.
- ▶ Do not use compressed air, abrasive cleaning agents, scourers or liquids such as alcohol, benzene, bleach or acetone to clean the Trimmer and attachments.
- ▶ Never clean, replace or remove Trimmer comb with motor ON.
- ▶ Never rinse or immerse the Trimmer in water or any other liquid.
- ▶ Do not apply pressure to cutters.
- ▶ Do not touch cutters with hard objects as this may damage them.
- ▶ Use a soft, dry cloth to clean Trimmer handle.

During Use:

- ▶ If cut hairs have accumulated in the Guide Comb area, turn Trimmer off, pull Guide Comb Attachment off Trimmer and remove hairs by shaking and/or blowing.

After Each Use:

- 1 Make sure the Trimmer is switched OFF and disconnected from the electrical outlet.
- 2 Remove the Guide Comb Attachment.
- 3 Open the cutting unit (fig. 9).
- 4 Clean the cutting unit and the inside of the Trimmer with the brush supplied (fig. 10).
- 5 Push the cutting unit back into place on the Trimmer until you hear a click (fig. 11).

Replacing The Cutting Unit

If your cutters become damaged or worn, do not continue using the Trimmer. Replace cutters immediately.

- 1 Open the cutting unit.
- 2 Remove the old cutting unit by pulling it upwards (fig. 12).
- 3 Place the two notches of the new cutting unit into the guiding slots (fig. 13).
- 4 Push the cutting unit back onto the Trimmer until you hear a 'click'.

This Trimmer has no other user-serviceable parts. For assistance call 1-800-243-3050.

Assistance

For assistance, call toll free:

1-800-243-3050

or visit our website:

www.philips.com/norelco

Information is available 24 hours a day,
7 days a week.

Storage

- ▶ Be sure Trimmer is turned OFF. Remove cord from outlet and Trimmer before storing in a safe, dry location where it will not be crushed, banged, or subject to damage.
- ▶ Do not wrap cord around Trimmer when storing.
- ▶ Store cord in a safe location where it will not be cut or damaged.
- ▶ Do not place or store Trimmer where it can fall or be pulled into a tub or sink, water or other liquid.

Battery Removal

- ▶ This Philips Norelco Trimmer contains a rechargeable Nickel Metal Hydride battery which must be disposed of properly (fig. 14).
 - ▶ Battery should only be removed when Trimmer is to be discarded.
 - ▶ For assistance, call toll free: 1-800-243-3050 or visit our website, www.philips.com/norelco.
- 1** Unplug electrical cord from outlet and Trimmer before dismantling Trimmer.
 - 2** Allow Trimmer to run until the battery is empty/depleted.
 - 3** Turn Trimmer OFF.
 - 4** Use a screwdriver to remove the housing of the Trimmer (fig. 15).
 - 5** Separate the housing parts with a screwdriver (fig. 16).
 - 6** Cut the wires close to the battery holder with household scissors (fig. 17).
 - 7** Remove the battery holder with the rechargeable battery (fig. 18).
 - 8** Use a screwdriver to pry the battery off the printed circuit board (fig. 19).
 - 9** Do not attempt to replace battery. Insulate battery ends by covering with tape and/or place battery in a small plastic bag.
 - 10** Discard your Trimmer. Do not attempt to plug electrical cord into the outlet or recharge the Trimmer after the battery has been removed.
 - 11** Contact your local town or city officials for battery disposal information or call 1-800-8-BATTERY or www.rbrc.com for battery drop-off locations.

Full Two-Year Warranty

Philips Electronics North America Corporation warrants each new Philips Norelco product, Model QT4021 against defects in materials or workmanship for a period of two years (cutters for up to 4 years) from the date of purchase, and agrees to repair or replace any defective product without charge.

IMPORTANT: This warranty does not cover damage resulting from accident, misuse or abuse, lack of reasonable care, the affixing of any attachment not provided with the product or loss of parts or subjecting the product to any but the specific voltage.* Use of unauthorized replacement parts will void this warranty.

PHILIPS ELECTRONICS NORTH AMERICA CORPORATION WILL NOT PAY FOR WARRANTY SERVICE PERFORMED BY A NON-AUTHORIZED REPAIR SERVICE AND WILL NOT REIMBURSE THE CONSUMER FOR DAMAGE RESULTING FROM WARRANTY SERVICE PERFORMED BY A NON-AUTHORIZED REPAIR SERVICE.

NO RESPONSIBILITY IS ASSUMED FOR ANY SPECIAL, INCIDENTAL OR CONSEQUENTIAL DAMAGES.

In order to obtain warranty service, simply go to www.philips.com/norelco or call 1-800-243-3050 for assistance. It is suggested that for your protection you return shipments of product by insured mail, insurance prepaid. Damage occurring during shipment is not covered by this warranty. **NOTE:** No other warranty, written or oral, is authorized by Philips Electronics North America Corporation. This warranty gives you specific legal rights, and you may also have other rights which vary from state to state. Some states do not allow the exclusion or limitation of incidental or consequential damages, so the above exclusion and limitations may not apply to you.

*Read enclosed instructions carefully.

Manufactured for:

Philips Consumer Lifestyle

A Division of Philips Electronics North America Corporation

1600 Summer Street – 5th Floor, Stamford, CT 06905-5125

Norelco is a Registered Trademark of Philips Electronics North America Corporation.

Zoom Lock is a Trademark of Philips Electronics North America Corporation.

PHILIPS is a Registered Trademark of Koninklijke Philips Electronics N.V.

© 2009 Philips Electronics North America Corporation. All Rights Reserved.

PHILIPS

NORELCO

45-DAY MONEY-BACK GUARANTEE

If you are not fully satisfied with your Philips Norelco Trimmer, send the product back along with dated sales receipt and we'll refund you the full purchase price.

The Trimmer must be shipped prepaid by insured mail, insurance prepaid, and have the original sales receipt, indicating purchase price and the date of purchase, enclosed. We cannot be responsible for lost mail. The Trimmer must be postmarked no later than 45 days after the date of purchase. Philips Norelco reserves the right to verify the purchase price of the Trimmer and limit refunds not to exceed suggested retail price.

To obtain Money-Back Guarantee Return Authorization Form, call 1-800-243-3050 for assistance. Please allow 4-6 weeks for delivery of check.

Free Manuals Download Website

<http://myh66.com>

<http://usermanuals.us>

<http://www.somanuals.com>

<http://www.4manuals.cc>

<http://www.manual-lib.com>

<http://www.404manual.com>

<http://www.luxmanual.com>

<http://aubethermostatmanual.com>

Golf course search by state

<http://golfingnear.com>

Email search by domain

<http://emailbydomain.com>

Auto manuals search

<http://auto.somanuals.com>

TV manuals search

<http://tv.somanuals.com>