

SHARP®

MODEL

EC-6312P

VACUUM CLEANER OPERATION MANUAL

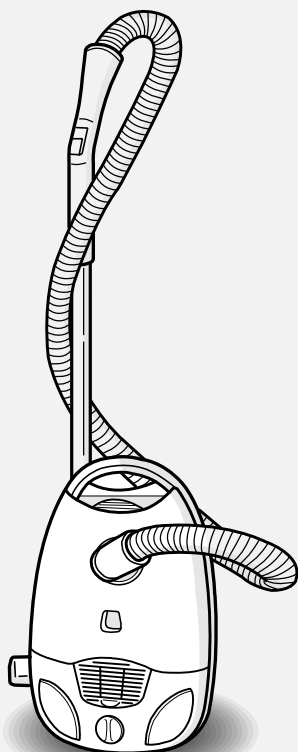

CONTENTS

PAGE

•IMPORTANT SAFETY INSTRUCTIONS.....	2
•PRECAUTIONS (Important)	3
•OPERATING INSTRUCTIONS AND PARTS LIST	4
•HOW TO EMPTY THE BAG	5
•MAINTENANCE	6
•BEFORE REQUESTING SERVICE ...	7
•DESCRIPTION OF ACCESSORIES ...	7
•WARRANTY	9

SPECIFICATIONS

FEATURES MODEL	Voltage (AC)	Power consumption	Dust disposal system	Accessories
EC-6312P	120V	1200W	Paper bag	Floor nozzle, Telescopic Pipe Hose Assembly Crevice tool, Soft brush

IMPORTANT SAFETY INSTRUCTIONS

When using an electrical appliance, basic precautions should always be followed including the following:

Read all instructions carefully before using this vacuum cleaner.

WARNING / To reduce the risk of fire, electric shock, or injury:

- 1 Do not use outdoors or on wet surfaces.
- 2 Do not leave vacuum cleaner unattended when plugged in. Unplug from outlet when not in use and before user-servicing.
- 3 Close supervision is necessary when used by or near children.
Do not allow this vacuum to be used as a toy. Use only as intended as described in this manual.
- 4 Use only the manufacturer's recommended attachments and paper bag.
- 5 Never operate this vacuum cleaner if it has a damaged cord or plug, if it is not working properly, if it has been dropped, damaged, exposed to weather or dropped into water. Return the vacuum cleaner to a Sharp Authorized Servicer in the United States for examination and repair.
- 6 Do not pull or carry this vacuum cleaner by the power cord. Do not use the power cord as a handle, close a door on the cord, or pull the cord around sharp edges or corners. Keep cord away from heated surfaces.
- 7 Never disconnect the plug by pulling on the cord. To disconnect from an outlet, grasp the plug, not the cord.
- 8 Never operate this vacuum cleaner with any air opening blocked. Keep the air openings free of dust, lint, hair and any other similar material.
When the secondary filter becomes dirty, rinse in warm water. Filters should be completely dry before reusing.
- 9 Never drop or insert any object into any opening.
- 10 Keep hair, face, fingers and loose clothing away from all openings, and any moving parts.
- 11 Do not use this vacuum to pick up lit cigarettes, hot ashes, matches or similar materials, razor blades, needles, pins or other sharp objects.
- 12 Never operate this vacuum cleaner without the paper bag and filter in place.
- 13 Before removing the plug from the outlet, turn the switch to the "OFF" position.
- 14 Use extra caution when cleaning on stairs.
- 15 Never handle plug, cord or vacuum cleaner with wet hands.
- 16 Do not use in the presence of flammable or combustible liquids or fumes.
- 17 Do not place heavy objects on the vacuum cleaner.
- 18 Do not step on the hose or pull the hose forcibly.
- 19 Do not pick up objects such as waste paper or cloth which may clog the hose.
- 20 Do not expose this vacuum cleaner to high temperatures while operating or storing.
- 21 Store this vacuum cleaner in a dry place.
- 22 Use the carrying handle on the top of the body to carry this vacuum cleaner.
- 23 Before servicing this vacuum cleaner, allow all metal parts to cool.
- 24 Rewind the cord by holding the plug to prevent any injury.

SAVE THESE INSTRUCTIONS

This vacuum cleaner is intended for household use only.

WARNING

Operate vacuum cleaner only at the voltage specified on the nameplate.

PRECAUTIONS (Important)

- Do not vacuum an area which contains moistures, water or inflammable matter, needles, pins, razor blades, etc.

- Keep the vacuum cleaner away from heat sources such as a heater during operation or after use.

Direct heat may damage the vacuum.

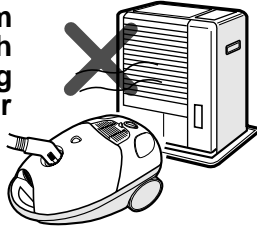

- Do not pull the power cord out beyond the red tape.

When connecting or disconnecting the power cord, hold the plug, not the power cord.

When pressing the cord rewind button, hold the plug, as the cord may rapidly retract, causing injury.

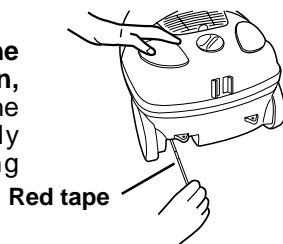

- Do not step on the hose or place heavy objects on it. Do not pull the hose forcibly.

The hose may be damaged.

- Do not operate the vacuum with the suction port or exhaust port blocked.

The motor will overheat.

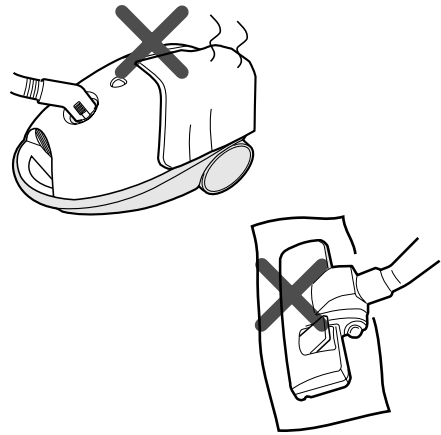

CAUTION: To reduce the risk of electric shock, this vacuum cleaner has a polarized plug (one blade is wider than the other.) This plug will fit in a polarized outlet only one way. If the plug does not properly fit in the outlet, reverse the plug. If it still does not fit, contact a qualified electrician to install the proper outlet. Do not change the plug in any way.



If the cord of this appliances is damaged, it must only be replaced by the repair shop appointed by SHARP. In order to avoid hazard.

OPERATING INSTRUCTIONS AND PART LIST

ON / OFF SWITCH

With the cord plugged into an electrical outlet, start or stop the vacuum cleaner by pressing the switch.

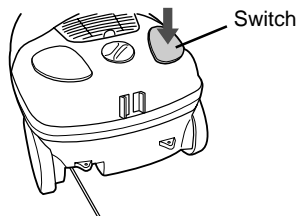

CORD REWIND BUTTON

To rewind the cord, press the cord rewind button while holding the plug. If cord is not retracted completely, pull it out a little and press the cord rewind button again.

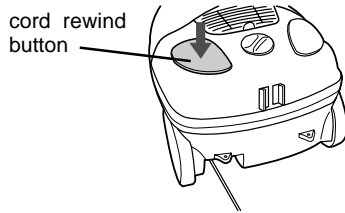

ACCESSORIES

- 1 Crevice tool
Use for door tracks, narrow spots, etc.
- 2 Soft brush with crevice tool.
Use for carved furniture, table tops, etc.

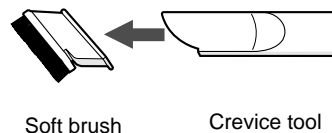

TELESCOPIC PIPE

When extend or shorten, push the button.

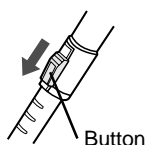

Accessories

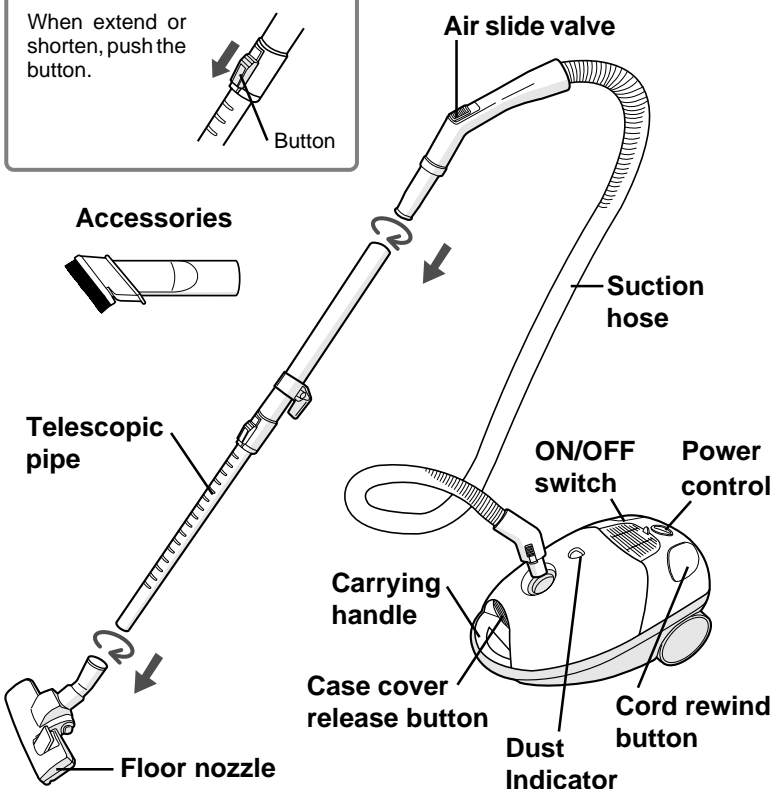

POWER CONTROL

To control suction power, turn the power control knob.

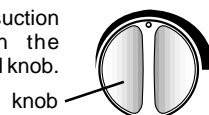

- Low:**
For curtains and delicate materials.
- Medium:**
For deep-pile velvet carpets and delicate carpeting.
- High:**
For ordinary carpets and floors.

AIR SLIDE VALVE

Open the controller on the hose handle to control the air or to release any items suck in the nozzle.

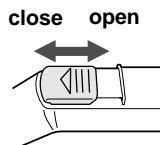

DUST INDICATOR

If dust indicator change to "red", the bag is full and must be changed or dispose the dust.

FLOOR NOZZLE

2-STEP FLOOR NOZZLE

Ideal for the daily cleaning of carpets and hard floors.

- Press the lever (A) for cleaning hard floors.
- Press the lever (B) for cleaning carpets.

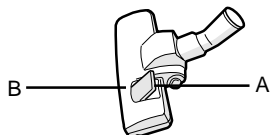

HOW TO TIDY UP

1. Rewind the power cord first, then wind the suction hose around the extension pipe.
2. Insert the holder in the hole on the body as shown.

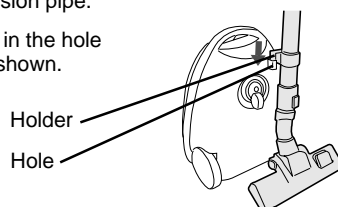

HOW TO DISPOSE THE DUST BAG

When the dust indicator turns red, dispose the dust as shown below.

If the vacuum cleaner takes in excessive amounts of fiber (thread, cottony material etc.), the indicator may not turn red even if the paper bag is filled.

HOW TO DISPOSE THE DUST BAG

Before open the case cover, make sure to take off the hose.

1 Open the case cover as shown.

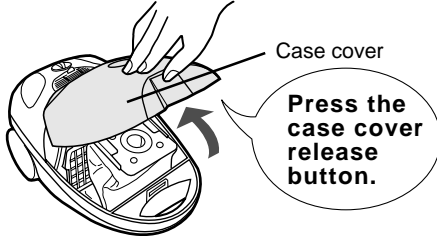

2 Take the plate of dust bag from the fixing plate.

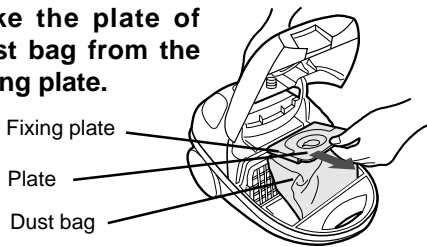

3 Pick the plate of dust bag and lift it up slowly.

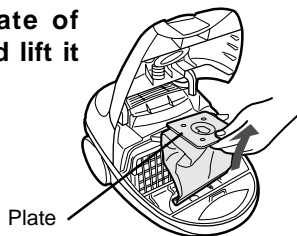

HOW TO SET THE DUST BAG

Use genuine SHARP dust bags.

1 Insert the plate of dust bag into the groove till end of fixing plate firmly.

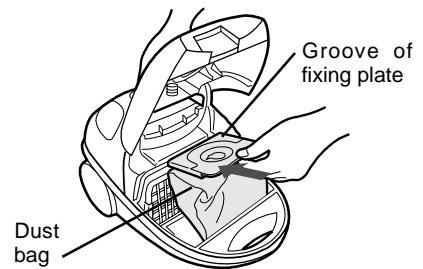

2 Close the case cover until it clicks.



Note

- The case cover cannot be closed without dust bag. Do not push the case cover hardly.
- To avoid damaging motor, never use a broken dust bag, or never operate the vacuum cleaner without the dust bag.
- To keep the suction power highly efficient and lengthen a life of motor, please dispose the dust frequently.

MAINTENANCE

CLEANING THE UNIT

When cleaning the unit, use a dampened cloth with luke-warm water.

Never clean or spray with a liquid such as insecticide, benzine, thinner or oil.

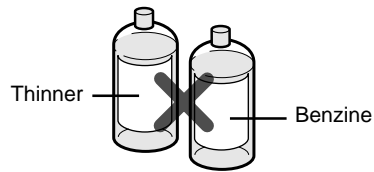

CLEANING THE MOTOR PRE-FILTER

When the filter becomes dirty, wash it gently with water.

- Pull up the holder and pull out the pre-filter.
- After drying completely, set the filter to the body properly.
Do not operate the vacuum cleaner without the pre-filter.

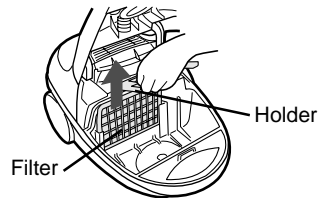

CLEANING THE AIR OUTLET FILTER

When the filter become dirty, wash the filter in the air outlet gently with water.

Push (← ①) the knob of cover, pull up (↑ ②) the cover and remove the filter.

To close, press the cover until it snaps into place.

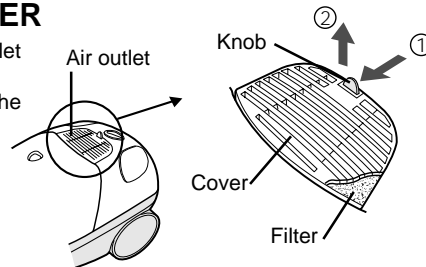

BEFORE REQUESTING SERVICE

If you experience any difficulties with your vacuum cleaner, use this Troubleshooting Guide first before asking for service.

NOTE Always remember to have the vacuum cleaner turned OFF and the plug disconnected from the power outlet before working on the vacuum cleaner.

TROUBLESHOOTING GUIDE

Problem	Check	Possible remedy
Motor does not start when the power switch is in the ON position.	<ul style="list-style-type: none"> • Make sure the vacuum cleaner is plugged in and the outlet is working. 	<ul style="list-style-type: none"> • Make sure the vacuum is plugged into an outlet. Plug into another outlet.
Decrease in suction. Bag check indicator changes to orange without bag full.	<ul style="list-style-type: none"> • Check to see if paper bag is filled with dust or fine dust has clogged paper bag. • Check to see if hose, telescopic pipe or floor nozzle is clogged. 	<ul style="list-style-type: none"> • Replace the paper bag. • Remove any foreign object that may have become jammed in the floor nozzle, hose or telescopic pipe.
Suction is weak or decreases suddenly.	<ul style="list-style-type: none"> • Does the paper bag need to be replaced? • Check to see if hose, telescopic pipe floor nozzle, inner pipe or dust cups are clogged. 	<ul style="list-style-type: none"> • Replace the paper bag. • Remove any foreign objects that may have become jammed in the floor nozzle, hose, pipe or dust cups etc.
Cord will not rewind.	<ul style="list-style-type: none"> • Is the cord entangled? 	<ul style="list-style-type: none"> • Pull the cord out about 2~3 feet and press the cord rewind button again.

Please request service if the problem still persists or if the problem is not defined in the Troubleshooting guide.

DESCRIPTION OF ACCESSORIES

For replacement accessories, contact your local dealer, call the Sharp Accessories and Supply Center at 1-800-642-2122, or visit SHARP's web site (<http://www.sharp-usa.com>).

ITEM	PART DESCRIPTION	PART NUMBER
①	PAPER BAG	EC-05PC4(5PCS IN 1PACK)

For other parts, please contact your nearest Sharp Dealer. If your dealer does not stock these parts, you may order them by calling 1-800-BE-SHARP.

ITEM	PART DESCRIPTION	PART NUMBER
②	SECONDARY FILTER	SHPPAR7434
③	TELESCOPIC PIPE	SHPPAR7444
④	HOSE ASSEMBLY	SHPPAR7430
⑤	CREVICE TOOL	SHPPAR7445
⑥	SOFT BRUSH	SHPPAR7446
⑦	FLOOR NOZZLE	SHPPAR7429

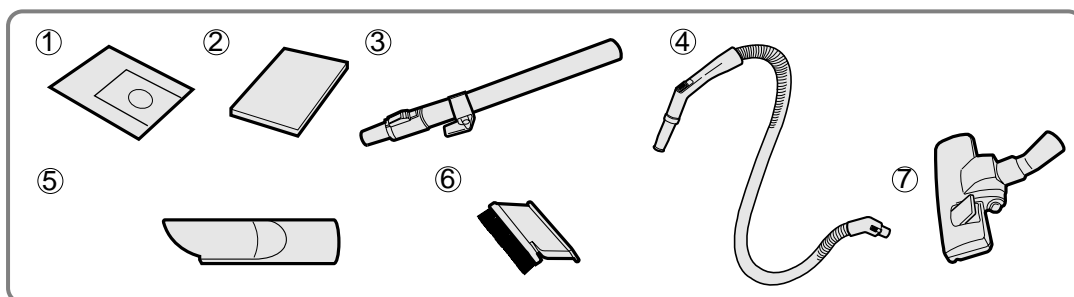

CONSUMER LIMITED WARRANTY

SHARP ELECTRONICS CORPORATION warrants to the first consumer purchaser that this Sharp brand product (the "Product"), when shipped in its original container, will be free from defective workmanship and materials, and agrees that it will, at its option, either repair the defect or replace the defective Product or part thereof with a new or remanufactured equivalent at no charge to the purchaser for parts or labor for the period(s) set forth below.

This warranty does not apply to any appearance items of the Product nor to the additional excluded item(s) set forth below nor to any Product the exterior of which has been damaged or defaced, which has been subjected to improper voltage or other misuse, abnormal service or handling, or which has been altered or modified in design or construction.

In order to enforce the rights under this limited warranty, the purchaser should follow the steps set forth below and provide proof of purchase to the servicer.

The limited warranty described herein is in addition to whatever implied warranties may be granted to purchasers by law. ALL IMPLIED WARRANTIES INCLUDING THE WARRANTIES OF MERCHANTABILITY AND FITNESS FOR USE ARE LIMITED TO THE PERIOD(S) FROM THE DATE OF PURCHASE SET FORTH BELOW. Some states do not allow limitations on how long an implied warranty lasts, so the above limitation may not apply to you.

Neither the sales personnel of the seller nor any other person is authorized to make any warranties other than those described herein, or to extend the duration of any warranties beyond the time period described herein on behalf of Sharp.

The warranties described herein shall be the sole and exclusive warranties granted by Sharp and shall be the sole and exclusive remedy available to the purchaser. Correction of defects, in the manner and for the period of time described herein, shall constitute complete fulfillment of all liabilities and responsibilities of Sharp to the purchaser with respect to the Product, and shall constitute full satisfaction of all claims, whether based on contract, negligence, strict liability or otherwise. In no event shall Sharp be liable, or in any way responsible, for any damages or defects in the Product which were caused by repairs or attempted repairs performed by anyone other than an authorized servicer. Nor shall Sharp be liable or in any way responsible for any incidental or consequential economic or property damage. Some states do not allow the exclusion of incidental or consequential damages, so the above exclusion may not apply to you.

THIS WARRANTY GIVES YOU SPECIFIC LEGAL RIGHTS. YOU MAY ALSO HAVE OTHER RIGHTS WHICH VARY FROM STATE TO STATE.

Model Specific Section

Your Product Model Number & Description:

EC-6312P Home use Vacuum Cleaner.
(Be sure to have this information available when you need service for your product.)

Warranty Period for this Product:

One (1) year parts and labor.

Additional Item(s) Excluded from Warranty Coverage (if any):

Appearance items of the product, accessories, filters, or any printed materials.

Where to Obtain Service:

At a Sharp Authorized Servicer located in the United States. To find the location of the nearest Sharp Authorized Servicer, call Sharp toll free at 1-800-BE-SHARP.

What to do to Obtain Service:

Ship prepaid or carry in your Product to a Sharp Authorized Servicer. Be sure to have Proof of Purchase available. If you ship the Product, be sure it is insured and packaged securely.

TO OBTAIN SUPPLY, ACCESSORY OR PRODUCT INFORMATION, CALL 1-800-BE-SHARP.

SHARP®

SHARP ELECTRONICS CORPORATION
Sharp Plaza, Mahwah, New Jersey 07430-2135
SHARP CORPORATION
Osaka, Japan

Printed in China

SHARP®

ASPIRADORA

INSTRUCCIONES DE OPERACION

INSTRUCCIONES DE SEGURIDAD IMPORTANTES

Cuando utilice un aparato eléctrico, deben seguirse siempre las precauciones básicas, incluyendo las siguiente:

Lea todas las instrucciones cuidadosamente antes de usar esta aspiradora.

ADVERTENCIA / Para reducir el peligro de incendio, descargas eléctricas o heridas:

- 1** No utilice en exteriores o sobre superficies mojadas.
- 2** No deje la aspiradora desatendida cuando esté enchufado. Desenchúfelo del tomacorriente cuando no lo utilice y antes de realizar el servicio.
- 3** Deberá tenerse mucho cuidado cuando se utilice por o cerca de niños. No deje que la aspiradora sea utilizada como un juguete.
- 4** Utilice el aparato sólo para el uso específico tal como se describe en este manual. Utilice sólo los accesorios y bolsas de papel recomendados por el fabricante.
- 5** No utilice esta aspiradora si el cable o clavija están dañados; si no funciona correctamente; si se ha caído al suelo, dañado, expuesto al aire libre o se ha caído en el agua. Envíe la aspiradora a un Centro de servicio autorizado de Sharp en los Estados Unidos, para su inspección y reparación.
- 6** No tire ni transporte esta aspiradora sujetando del cable eléctrico. No utilice el cable eléctrico como un mango, cierre la puerta con el cable entre medio, ni tire del cable en esquinas o bordes afilados. Mantenga el cable alejado de superficies calientes.
- 7** No desconecte la clavija tirando del cable. Para desconectarlo de un tomacorriente, sujete la clavija, no el cable.
- 8** No haga funcionar la aspiradora con una de sus aberturas de aire bloqueadas. Mantenga las aberturas de aire libres de polvo, pelusa, pelos y otros materiales similares. Cuando el filtro secundario se ensucia, lávelo en agua caliente. Los filtros deben secarse completamente antes de volverse a usar.
- 9** No deje caer ni inserte objetos en ninguna abertura.
- 10** Mantenga el pelo, cara, dedos y su ropa suelta alejados de todas las aberturas, y las partes móviles.
- 11** No utilice esta aspiradora para recoger cigarrillos, ceniza caliente, cedillas ni materiales similares, hojas de afeitar, agujas, pasadores u otros objetos puntiagudos.
- 12** No haga funcionar esta aspiradora sin una bolsa de papel y filtros instalados.
- 13** Antes de desenchufar la clavija del tomacorriente, desconecte todos los controles a sus posiciones "OFF".
- 14** Tenga especial cuidado cuando limpie las escaleras.
- 15** No toque la clavija, cable eléctrico o aspiradora con las manos mojadas.
- 16** No utilice cerca de líquidos o vapores inflamables o combustibles.
- 17** No coloque objetos pesados en la aspiradora.
- 18** No pise la manguera ni de ella a la fuerza.
- 19** No recoja objetos grandes tales como panel o trapos ya que tapan la manguera.
- 20** No exponga la aspiradora a altas temperaturas mientras lo utiliza o durante el almacenaje.
- 21** Guarde esta aspiradora en un lugar seco.
- 22** Utilice la manija de transporte en la parte de arriba del cuerpo para transportar la aspiradora de polvo.
- 23** Antes de realizar el servicio de esta aspiradora, deje que todas las partes metálicas se enfríen.
- 24** Embobine el cable sosteniendo la punta para evitar cualquier lesión

GUARDE ESTAS INSTRUCCIONES

Esta aspiradora fue diseñada sólo para uso como electrodoméstico.

ADVERTENCIA

Utilice la aspiradora sólo con el voltaje especificado en la placa de especificaciones.

ANTES DE SOLICITAR EL SERVICIO

Si tiene dificultades con su aspiradora, utilice primero este gráfico de localización y reparación de averías antes de solicitar el servicio.

NOTA Acuérdesse siempre de poner en OFF la aspiradora y de desconectar la clavija del tomacorriente antes de manipular la aspiradora.

GRAFICO DE LOCALIZACION Y REPARACION DE AVERIAS

Problema	Comprobación	Remedio posible
El motor no arranca cuando .	<ul style="list-style-type: none"> • Compruebe si la clavija del cable de alimentación está completamente insertada en el tomacorriente y que este tiene corriente. 	<ul style="list-style-type: none"> • Compruebe que la clavija de la aspiradora está insertada en el tomacorriente.
Disminuye la succión. El indicador de comprobación de la bolsa cambia a naranja sin que la bolsa esté llena.	<ul style="list-style-type: none"> • Compruebe si la bolsa de papel está llena de polvo. • Compruebe si la manguera, tubo de telescopio o cabeza de la boquilla no están tapadas. 	<ul style="list-style-type: none"> • Cambie la bolsa de papel. • Extraiga los objetos extraños que pueden haberse atascado en la cabeza de la boquilla, manguera o tubo.
La potencia de succión es débil o disminuye simultáneamente.	<ul style="list-style-type: none"> • Necesita ser cambiada la bolsa de papel? • Compruebe si la manguera, tubo telescopio, compartimiento para polvo o cabeza de la boquilla no están tapadas. 	<ul style="list-style-type: none"> • Cambie la bolsa de papel. • Extraiga los objetos extraños que pueden haberse atascado en la cabeza de la boquilla, manguera tubo o compartimiento para polvo.
El cable eléctrico no se rebobina.	<ul style="list-style-type: none"> • El cordón está enredado? 	<ul style="list-style-type: none"> • Tire del cable eléctrico unos 2-3 pies y vuelva a presionar el botón de rebobinado del cable.

Solicite el service en el caso de que el problema continúa o si el problema no está explicado en el gráfico de localización y reparación de averías.

DESCRIPCION DE LOS ACCESORIOS

Para el cambio de accesorios, llame a su concesionario local. Llame al Centro de accesorios y suministro de Sharp discando el 1-800-642-2122 o visite nuestra página de Internet de SHARP (<http://www.sharp-usa.com>).

ITEM	DESCRIPCION DE LAS PIEZAS	NUMERO DE PIEZA
①	BOLSA DE PAPEL	EC-05PC4(5PZAS EN 1PAQUETE)

Para las demás piezas, llame a su concesionario de Sharp más cercano. Si su concesionario no tiene esas piezas en inventario, puede hacer el pedido llamando a 1-800-BE-SHARP.

ITEM	DESCRIPCION DE LAS PIEZAS	NUMERO DE PIEZA
②	FILTRO SECUNDARIO	SHPPAR7434
③	TUBO EXTENSION	SHPPAR7444
④	CONJUNTO DE MANGUERA	SHPPAR7430
⑤	SOPORTE DE APENDICES	SHPPAR7445
⑥	CEPILLO EXTRAIBLE	SHPPAR7446
⑦	CABEZA DE LA BOQUILLA	SHPPAR7429

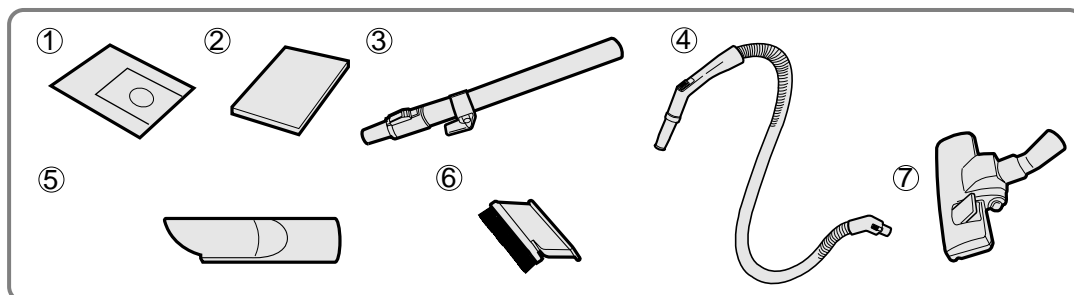

Su número de modelo y descripción del producto

SHARP ELECTRONICS CORPORATION garantiza al primer comprador del producto que este producto de marca Sharp (el "Producto"), cuando es embarcado en su recipiente original, está libre de materiales y fabricación defectuosa y acuerda que a su opción, reparará el defecto o reemplazará el producto o la parte defectuosa sin cargar al comprador las partes o trabajo durante el periodo(s) de tiempo establecido abajo.

Esta garantía no se aplica a los ítemes de apariencia del producto o a los ítemes adicionales excluidos establecidos abajo, ni a ningún producto cuyo exterior haya sido dañado o deformado, que haya sometido a mal uso, servicio o manejo anormal o se haya alterado o modificado en diseño o construcción.

Para aplicar el derecho bajo esta garantía limitada, el comprador debe seguir los pasos establecidos abajo y proporcionar una prueba de la compra al reparador.

La garantía limitada descrita aquí es una adición a otras garantías que se aplican por ley a los compradores.

TODAS LAS GARANTIAS APLICADAS INCLUYENDO LAS GARANTIAS DE VENTAS Y CORRESPONDENCIA DE USO ESTAN LIMITADAS AL PERIODO(S) DESDE LA FECHA DE LA COMPRA ESTABLECIDA ABAJO.

Algunos estados no permiten limitaciones de tiempo de las garantías implicadas, por eso la limitación de encima tal vez no se aplique a su caso.

Ni en personal de ventas ni el vendedor u otra persona queda autorizada a realizar otras garantías que no sean las descritas aquí o la extensión de la duración de las garantías más allá del periodo de tiempo descrito aquí por Sharp.

Las garantías descritas aquí deben ser solamente las garantías garantizadas por Sharp y deben ser el único y exclusivo remedio disponible para el cliente. La corrección de defectos, de la forma y durante el periodo de tiempo descrito aquí, debe constituir un cumplimiento completo de todas las obligaciones y responsabilidades de Sharp al cliente con respecto al producto y debe constituir una completa satisfacción de todas las reclamaciones, basándose en el contrato, negligencia, obligación estricta o similar. En ningún caso debe obligarse ni responsabilizarse a Sharp de los daños o defectos del producto que fueron causados por reparaciones o intentos de reparaciones causados por cualquiera que no sea un reparador de servicio autorizado. Sharp no se responsabilizará de ninguna forma de los daños económicos consecuentes o accidentales ni de los daños a la propiedad. Algunos estados no permiten la exclusión de daños consecuentes o accidentales, por eso la exclusión de encima tal vez no se aplique a su caso.

LA GARANTIA LE DA LOS DERECHOS LEGALES ESPECIFICOS. TAMBIEN PUEDE TENER OTROS DERECHOS QUE VARIAS DE ESTADO A ESTADO.

Sección específica al modelo

Su número de modelo del producto:

EC-6312P Aspiradora para uso en el hogar.
(Tenga esta información disponible cuando necesite el servicio para su producto.)

Periodo de garantía para este Producto:

Un (1) año de partes y trabajo.

Item(es) adicional(es) excluido(s) de la garantía (si los hubiera):

Ítemes de apariencia del producto, accesorios, filtros o materiales impresos.

Donde obtener el servicio:

De una estación de servicio autorizada Sharp en los Estados Unidos. Para buscar el lugar de la estación de servicio autorizada Sharp más cercana, llame a Sharp libre de cargo al número 1-800-BE-SHARP (1-800-237-4277).

Que hacer para obtener el servicio:

Haga el envío pagando el flete o lleve el producto a una estación de servicio autorizada Sharp. Tenga a mano una Prueba de Compra del aparato. Si envía el producto por correo, asegúrese de comprar un seguro y realice un embalaje correcto.

PARA RECIBIR INSUMOS, ACCESORIOS O INFORMACION DE PRODUCTOS, LLAME AL 1-800-BE-SHARP.

SHARP®

SHARP ELECTRONICS CORPORATION
Sharp Plaza, Mahwah, New Jersey 07430-2135
SHARP CORPORATION
Osaka, Japan

Printed in China

SHARP®

Free Manuals Download Website

<http://myh66.com>

<http://usermanuals.us>

<http://www.somanuals.com>

<http://www.4manuals.cc>

<http://www.manual-lib.com>

<http://www.404manual.com>

<http://www.luxmanual.com>

<http://aubethermostatmanual.com>

Golf course search by state

<http://golfingnear.com>

Email search by domain

<http://emailbydomain.com>

Auto manuals search

<http://auto.somanuals.com>

TV manuals search

<http://tv.somanuals.com>