

## 1. INTRODUCTION

Thank you for purchasing the Conserve energy-saving surge protector from Belkin. Many devices today are never truly off but instead continue to consume electricity while in a standby mode. Standby mode or “phantom power” is wasted energy and it adds up quickly. Conserve makes it easy to reduce your electricity consumption by completely turning off the power to electronic devices when they are not in use.

To find out more about how you can save energy, go to [www.belkin.com/conserve](http://www.belkin.com/conserve).

Please be sure to read through this User Guide carefully to ensure proper installation and setup of the Conserve surge protector.

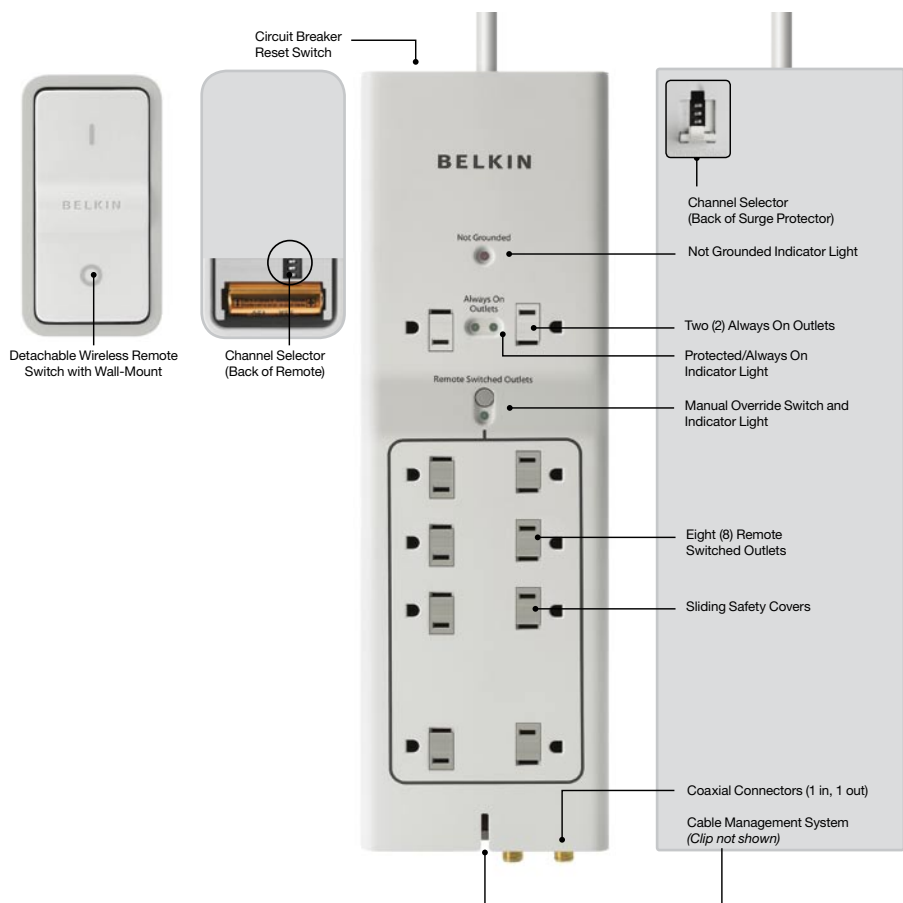

## 2. OPERATION

The Conserve energy-saving surge protector is already preset to work with the wireless remote switch. Only adjust the channel setting if:

- You have more than one Conserve surge protector and want to control each one independently.
- You want to control more than one Conserve surge protector using the same wireless remote switch.
- You think there is interference on the preset channel and you want to try other channels.

### Syncing your Conserve Surge Protector and Wireless Remote Switch

To change the channel setting, use a small screwdriver to shift the keys on the surge protector and the wireless remote switch. Make sure the keys on the wireless remote switch and the surge protector have the same configuration (up to eight possible settings). Example:

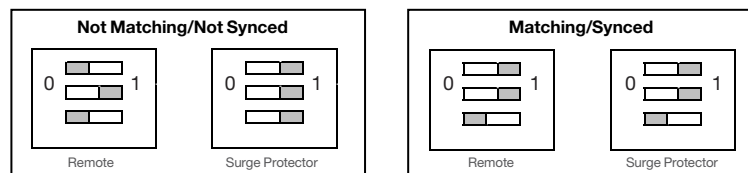

For ultimate convenience, control multiple Conserve surge protectors with a single remote switch. Adjust the channel setting on each Conserve unit to match the setting on the remote switch. This will allow you to easily turn off the power to additional devices connected to the units within range.\*

### Connecting your equipment

The Conserve surge protector has ten (10) outlets. The outlets marked “Always On Outlets” are always powered when the surge protector is plugged in. They are not switchable. These outlets are intended for use with devices that typically need to stay on at all times.

The outlets labeled “Remote Switched Outlets” are controlled via the wireless remote switch. These outlets are intended for use with devices that do not need to be on all the time or go into standby mode when not in use. See illustration for examples.

The coaxial connectors (1 in, 1 out) provide added surge protection for audio video equipment. These connectors are not controlled by the wireless remote switch, since power is not supplied through the coax.

The manual override switch on the surge protector can also be used to turn the switched outlets on or off without the wireless remote switch in the event the remote is lost or the battery needs replacing.

### Using the Wireless Remote Switch

An A23 (12V) alkaline battery is included. Before using the wireless remote switch for the first time, simply remove the battery security tab from the switch. Now the switch is ready.

A green LED on the wireless remote switch will illuminate when the switch is pressed. This indicates that the signal was sent and that the battery is OK. If you do not see the light, it is time to replace the battery. To replace the battery, see the Troubleshooting Guide on the next page.

Conserve has a range of up to 60 feet.\* Line of sight from the wireless remote switch to the surge protector is not required.

\*Actual range may vary depending on interference, building materials (e.g., masonry, metal walls), and other location-specific conditions.

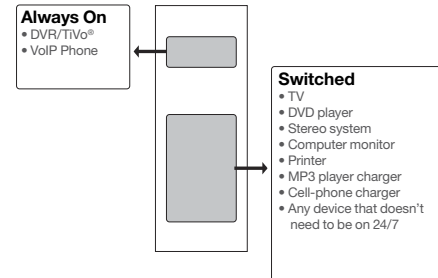

## 3. INSTALLATION & MOUNTING

### The Wireless Remote Switch with Wall-Mount

Use either the adhesive tape or screws (not included) to attach the wall bracket securely to a wall. Ideally, place the wireless remote switch near existing light switches or the entrance to a room for added convenience and accessibility. The wireless remote switch can also be kept conveniently anywhere (e.g., by a bed, on a coffee table, on a desk).

### The Surge Protector

*(Optional)* Use the two mounting holes on the back of the surge protector to secure it to the wall or baseboard. Install two screws (not included), leaving at least ¼ inch of the screw exposed. Insert the screws into the mounting holes of the surge protector and lock into place.

Use the detachable cable-management system (included) to help route and organize cables.

## 4. TROUBLESHOOTING GUIDE

### My device won't turn on

1. Check whether the device is plugged into an "Always On" outlet or a "Remote Switched" outlet.
2. If the device needs to stay on at all times, make sure it is plugged into one of the two outlets labeled "Always On".
3. Turn on the switchable outlets using the wireless remote switch. Ensure battery-life LED in the switch lights up. If it does not, replace the battery.
4. Make sure the channel settings on the surge protector and the wireless remote switch match. See Section 2 – Operation.
5. The surge protector may be overloaded. Press the circuit breaker button to reset the circuit.

### My device won't turn off

1. Make sure the device is plugged into a "Remote Switched" outlet.
2. Turn off the switchable outlets using the wireless remote switch. Ensure battery-life LED in the remote switch lights up. If it does not, replace the battery.
3. Turn off the switchable outlets using the button on the surge unit.
4. Make sure the channel settings on the surge unit and the wireless remote switch match. See Section 2 – Operation.

### Replacing the battery

1. Functional range may decrease as the battery wears out.
2. Remove the battery cover from the back of the wireless remote switch.
3. Replace the battery with an A23 (12V) alkaline battery.
4. PLEASE RECYCLE THE BATTERY. To learn more, visit Rechargeable Battery Recycling Corporation at [www.rbcc.org](http://www.rbcc.org) or Battery Solutions, Inc. at [www.batteryrecycling.com](http://www.batteryrecycling.com).

### Not Grounded indicator is lit

Your house may not be grounded properly. Consult your local electrician.

### Protected/Always On indicator is not lit

1. When the indicator is lit, the outlets are surge-protected.
2. If the indicator is not lit, the sockets of the unit are overloaded. Press the circuit breaker button to reset the unit.
3. If indicator light is not lit after resetting the circuit breaker, then the surge protector has reached the end of its useful life. Replace the surge protector to ensure proper protection.

### Order additional or replacement remote switches

1. Visit [www.belkin.com](http://www.belkin.com) to order additional wireless remote switches, or to replace lost or broken ones.

## 5. SAFETY INFORMATION

- To reduce the risk of electrical shock, unplug the unit and allow it to cool before cleaning.
- Do not "daisy-chain" this product or use it with extension cords. The Belkin Conserve's power cord must be plugged directly into an AC power source to ensure proper surge protection.
- For indoor use and in dry locations only. Not for use with aquariums or other water-related products.

## 6. TECHNICAL INFORMATION

Continuous Duty Electrical Rating:	125V/15A/1875W
Maximum Energy Dissipation:	1080 Joules • H-N: 360 Joules • H-G: 360 Joules • N-G: 360 Joules
Maximum Spike Current:	72,000A • H-N: 24,000A • H-G: 24,000A • N-G: 24,000A
UL Clamping Voltage (3-line):	UL 1449 330V
EMI/RFI Noise Filtration:	150kHz–100MHz up to 58 dB
Remote Switch Battery Type:	A23 (12V) alkaline or equivalent

UL Listed to U.S. and Canada Safety Standards: UL 1449, UL 1363.

The EMI/RFI components evaluated to the applicable requirements with UL 1283.

### FCC ID: K7S-BG200001

This device complies with Part 15 of the FCC Rules. Operation is subject to the following two conditions:

1. This device may not cause harmful interference, and
2. This device must accept any interference received, including interference that may cause undesired operation.

**Warning:** Changes or modifications not expressly approved by the party responsible for compliance could void the user's authority to operate the equipment.

**NOTE:** This equipment has been tested and found to comply with the limits for a Class B digital device, pursuant to Part 15 of the FCC Rules. These limits are designed to provide reasonable protection against harmful interference in a residential installation. This equipment generates, uses, and can radiate radio frequency energy and, if not installed and used in accordance with the instructions, may cause harmful interference to radio communications. However, there is no guarantee that interference will not occur in a particular installation. If this equipment does cause harmful interference to radio or television reception, which can be determined by turning the equipment off and on, the user is encouraged to try to correct the interference by one or more of the following measures:

- Reorient or relocate the receiving antenna.
- Increase the separation between the equipment and receiver.
- Connect the equipment into an outlet on a circuit different from that to which the receiver is connected.
- Consult the dealer or an experienced radio/TV technician for help.



# BELKIN®

[www.belkin.com](http://www.belkin.com)

### Belkin Tech Support

US: 800-223-5546, ext. 2263

310-898-1100, ext. 2263

UK: 0845 607 77 87

Australia: 1800 235 546

New Zealand: 0800 235 546

Singapore: 65 64857620

Europe: [www.belkin.com/support](http://www.belkin.com/support)

### Belkin International, Inc.

501 West Walnut Street

Los Angeles, CA 90220, USA

310-898-1100

310-898-1111 fax

© 2008 Belkin International, Inc. All rights reserved. All trade names are registered trademarks of respective manufacturers listed.

## Free Manuals Download Website

<http://myh66.com>

<http://usermanuals.us>

<http://www.somanuals.com>

<http://www.4manuals.cc>

<http://www.manual-lib.com>

<http://www.404manual.com>

<http://www.luxmanual.com>

<http://aubethermostatmanual.com>

Golf course search by state

<http://golfingnear.com>

Email search by domain

<http://emailbydomain.com>

Auto manuals search

<http://auto.somanuals.com>

TV manuals search

<http://tv.somanuals.com>