

12

1st
Insert Valve into Sideburner Tube and snap valve cup into bottom of shelf (see inset for proper engagement) Place Sideburner Knob.
2nd
Attach long wire from beneath console to electrode beneath Sideburner.

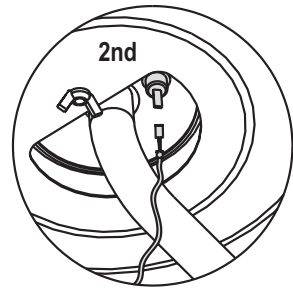

IMPORTANT

Proper tube-to-valve engagement

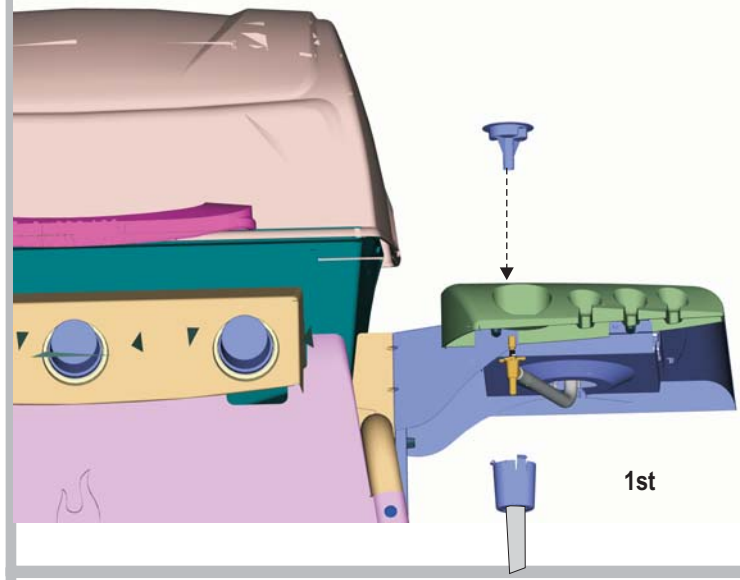

1st

13

Items to Assemble:
1 Grease Clip
1 Grease Can

Hang grease clip from center of grill bottom.
Hang grease can from grease clip.

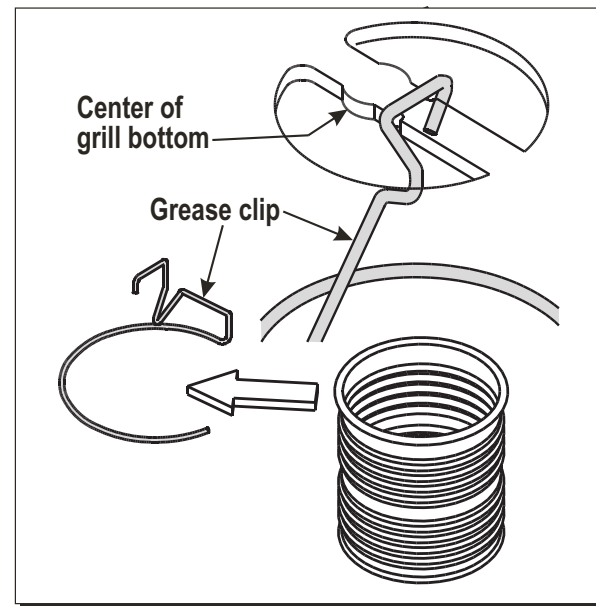

CAUTION

• Failure to install can in clip will cause hot grease to drip from bottom of grill with risk of fire or property damage.

14

Items to Assemble:
1 Chain with Coupling
1 Match-Holder

Remove coupling from chain
Place end of chain through hole, reattach coupling to end of chain.
Thread eyelet on other end of chain into loop of match holder.

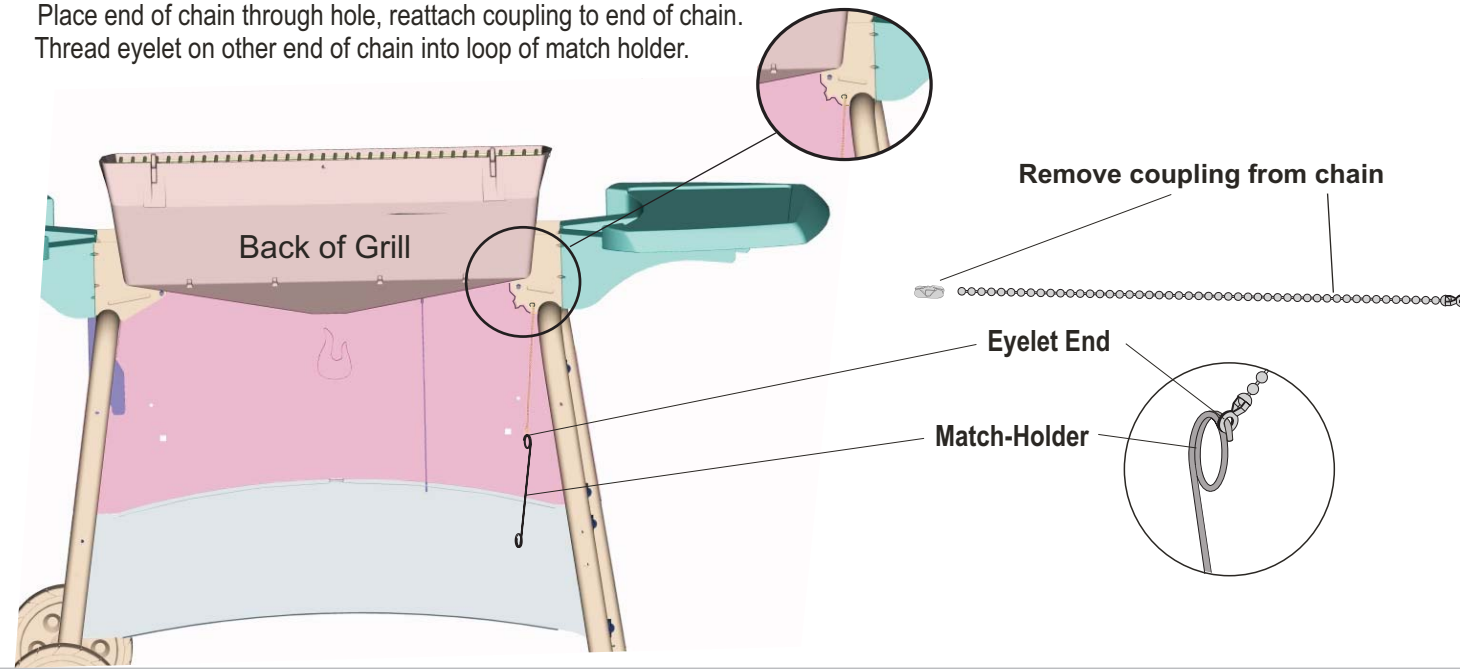

See Use & Care Manual for "Match Lighting Instructions"

15

Items to Assemble:
1 LP Tank

Loosen wing-nut on tank holder.
Center base of tank in notches between wheels.
Lower tank holder onto tank and tighten the wing-nut.

LP tank is shipped empty. Fill and leak check before attaching to grill and regulator.

See Use and Care to perform the "Burner Flame Check" and important safety instructions before using

CAUTION

• Tank collar opening must face to front of cart once tank is attached.
• Failure to install tank correctly may allow gas hose to be damaged in operation, resulting in the risk of fire.

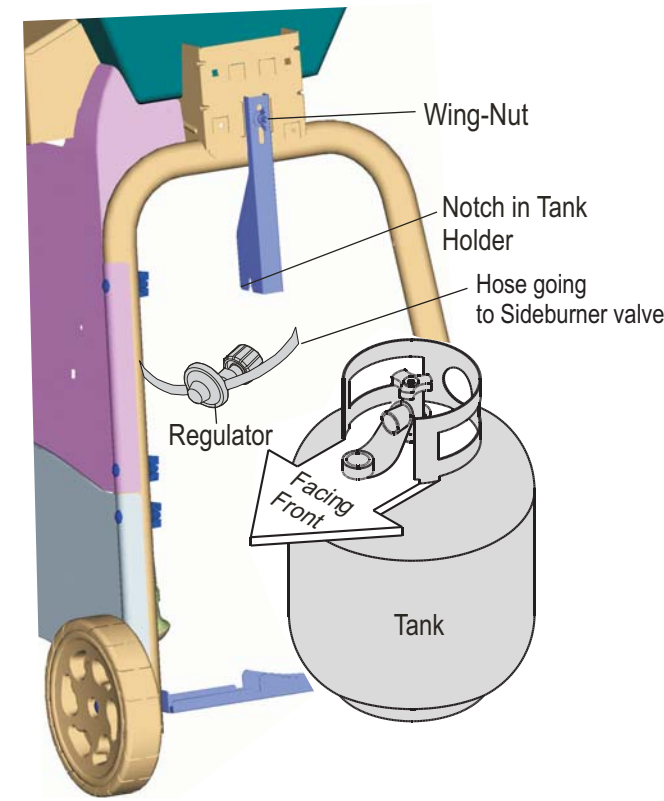

Parts List - Model 4638247

Key Qty.	Description	Part #
A	1 Grease Cup	4150349
B	1 Condiment Wire	4151005
C	3 Tent Frame	4151014
D	1 Griddle	4152038
E	1 Warming Rack	4152043
F	1 Cooking Grid, 12"	4152045
G	1 Cooking Grid, 15"	4152046
H	1 Handle	4154474
I	1 Condiment Tray	4154518
J	1 Sideburner Tool Holder	4154519
K	1 Sideburner Grate	4156179
L	2 Wheel	4156957
M	1 LP Tank	4158015
N	3 Burner Tent	4500226
O	1 Tank Retainer	4503105
P	1 Tank Support	4503114
Q	1 Storage Shelf	4503107
R	1 Upper Panel	4503119
S	1 Lower Panel	4503121
T	2 #10x1/2" Screw, Self-tap	4080043
U	2 Pivot Pin	4080066
V	3 3/16 Pal Nut	4153096
W	1 Ignitor Wire	4153184
X	2 Leg Extender	4154516
Y	2 Hitch Pin	4156515
Z	2 Carry-over Tube	4500228
AA	1 Right Leg	4503147
BB	1 Left Leg	4503148
CC	1 Console Assembly	4530040

Key Qty.	Description	Part #
DD	1 Ignitor Knob	4154208
EE	1 Sideburner Valve Cup	4154476
FF	1 Grill Bottom	4580387
GG	3 Burner	5068016
HH	1 Sideburner Ignitor Wire	5156110
II	1 Left Shelf	4520016
JJ	1 Sideburner Assembly	4520018
KK	1 Sideburner Burner	5068017
LL	1 Grill top	4580128
MM	3 Control Knob	4154507
NN	1 Sideburner Knob	4154471
OO	1 Logo Plate	4157147
--	1 Hardware, Cart Assy	4254009
--	1 Hardware, Shelf	4254011
PP	1 Grease Clip	5156607

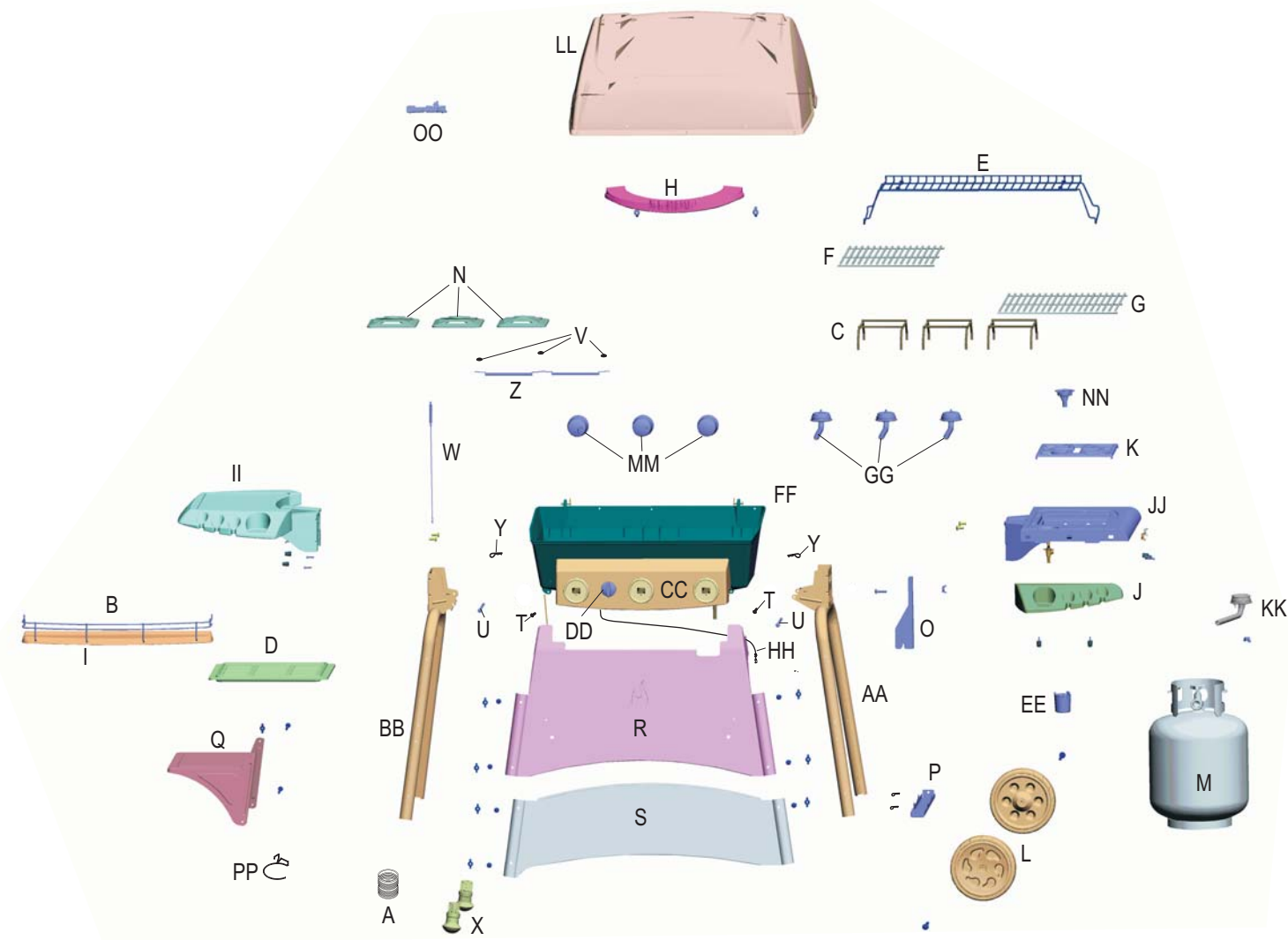

Smoke Flavoring Pellets Usage Instructions

Thank you for trying 100% Natural Hickory Smoke Flavoring Pellets. Now you can add true wood smoke flavor to your food while cooking with gas!

To use in your Char-Broil™ Big Easy™ grill, construct a foil pouch the approximate size of the pellet package. Poke a 1/4" diameter hole into one side of the pouch. Preheat grill to desired temperature. Place the pouch, with the hole facing up, on top of the burner tent inside the grill. Please note, the burner tent should NOT be inverted for use with smoke flavoring pellets. When smoking starts, place food on grill and close lid.

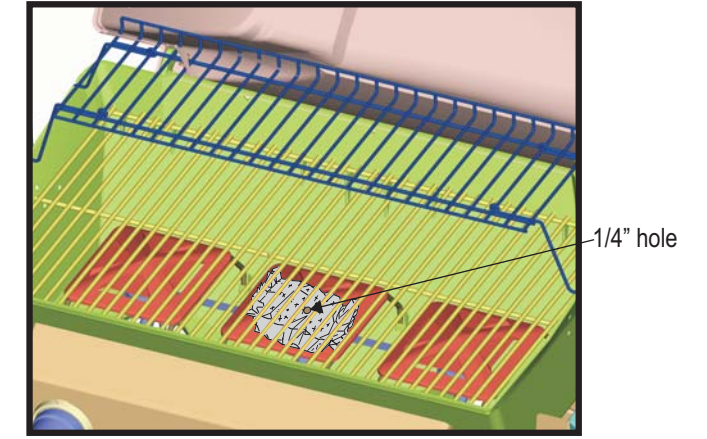

NO TOOLS REQUIRED

the Big Easy®

THE GRILL THAT COOKS
BREAKFAST LUNCH AND DINNER

the Big Easy®

4638247
ASSEMBLY MANUAL



THIS GRILL IS FOR OUTDOOR USE ONLY

CAUTION: Read and follow all safety statements, assembly instructions, and use and care directions before attempting to assemble and cook.

INSTALLER/ASSEMBLER: Leave these instructions with consumer.

CONSUMER: Keep this manual for future reference.

WARNING

Failure to follow all manufacturer's instructions could result in serious personal injury and/or property damage.

CAUTION

Some parts may contain sharp edges – especially as noted in the manual! Wear protective gloves if necessary.

If you have any questions or need assistance during assembly, please call 1-800-241-7548.

Visit us on the web at:
www.charbroil.com

Char-Broil

Free Manuals Download Website

<http://myh66.com>

<http://usermanuals.us>

<http://www.somanuals.com>

<http://www.4manuals.cc>

<http://www.manual-lib.com>

<http://www.404manual.com>

<http://www.luxmanual.com>

<http://aubethermostatmanual.com>

Golf course search by state

<http://golfingnear.com>

Email search by domain

<http://emailbydomain.com>

Auto manuals search

<http://auto.somanuals.com>

TV manuals search

<http://tv.somanuals.com>