

BRAUN

MILLENNIUM
SERIES32244 Rev. B
January 2008

Operator's Manual for:

NL955 Series

Private Use Wheelchair Lifts

DOT — Private Use Lift

"DOT — Private Use Lift" verifies that this platform lift meets only the "private use lift" requirements of FMVSS No. 403. This lift may be installed on all vehicles appropriate for the size and weight of the lift, except for buses, school buses, and multi-purpose passenger vehicles other than motor homes with a gross vehicle weight rating (GVWR) that exceeds 4,536 kg (10,000 lb).

 **THE BRAUN CORPORATION**
"Providing Access to the World"®

International Corporate Hdqrs: P.O. Box 310 Winamac, IN 46996 USA
1-800-THE LIFT® (574) 946-6153 FAX: (574) 946-4670



Patent #5,261,779

Patent #6,065,924

Patent #6,238,169

Patent #6,464,447

Patent #6,599,079

Patent #6,692,217

Patent #6,739,824

Patents Pending

Download from www.Somanuals.com. All Manuals Search And Download.

⚠ WARNING



Read manual before operating lift. Failure to do so may result in serious bodily injury and/or property damage. Keep manual in lift storage pouch.

Congratulations

We at The Braun Corporation wish to express our fullest appreciation on your new purchase. With you in mind, our skilled craftsmen have designed and assembled the finest lift available.

This manual includes safety precautions, lift operating instructions, manual operating instructions, and instructions for maintenance and lubrication procedures.

Your lift is built for dependability, and will bring you years of pleasure and independence, as long as maintenance is performed regularly and the lift is operated by an instructed person.

Sincerely,

THE BRAUN CORPORATION

A handwritten signature in black ink that reads "Ralph W. Braun". The signature is written in a cursive style with a large, prominent "R" and "B".

Ralph W. Braun
Chief Executive Officer

Contents

Warranty and Registration Instructions	2, 3	Automatic Floor Level Switching	21
Lift Terminology		Outer Barrier and Side Entry	21-23
Lift Terminology Illustration	4	Outer Barrier Latch	23
Introduction	5	Outer Barrier and Latch Operation	24
Direction	5	Lift Passengers	
Lift Components	6, 7	Passenger Orientation (Boarding Direction)	25
Vehicle and Lift Interlocks	7	Vehicle (Floor Level) Loading and	
Lift Actions and Functions	8	Unloading	25
Lift Operation Safety		Wheelchair-Equipped Occupant Seat Belts	26
Safety Symbols	9	Operation Procedure Review	26, 27
Lift Operation Safety Precautions	10-13	Preventive Maintenance	27, 28
Operation Notes and Details		Lift Operating Instructions	29-35
Introduction	14	NHTSA Operations Checklist	36
General Safety	14, 15	Manual Operating Instructions	37-39
Control Switches	15-17	Decals and Antiskid	40-42
Lift Features		Maintenance and Lubrication	43-51
Lift-Tite™ Latches.....	18, 19		
Inboard Locator and Bridge Plate	20, 21		

Warranty and Registration Instructions

Immediately upon receiving your lift, examine the unit for any damage. Notify the carrier at once with any claims.

Two warranty/registration cards (shown below) are located in the lift-mounted owner's manual storage pouch. The sales representative must process one of the cards. The consumer must fill out the other card and mail it to The

Braun Corporation. The warranty is provided on the back cover of this manual. The **warranty cards must be processed to activate the warranty.**

Two Braun Serial No./Series No. Identification tags are posted on the lift. One I.D. tag (shown below) is posted on the pump side vertical arm. A second I.D. tag is located on the opposite pump

side tower. Both I.D. tags provide the product identification information appearing on the Warranty/Registration card. Record the information in the space provided on the next page.

This information must be provided when filing a warranty claim or ordering parts.

Series No. Pump Code
Model No. Serial No. Cylinder Code

OWNER'S WARRANTY REGISTRATION	
NL955E3143-03-00001-56-14CF	
PURCHASED FROM _____	
OWNER _____	
NAME _____	DATE RETAILED _____
ADDRESS _____	
CITY _____	
TELEPHONE _____	STATE _____ ZIP _____
TO VALIDATE WARRANTY REGISTRATION CARDS MUST BE RETURNED TO THE BRAUN CORPORATION.	

Sample
Warranty/Registration
Card

Sample
Serial No./Series No.
Identification Tag

The Braun Corporation	
1-800-THE-LIFT™ BRAUNLIFT.COM™	
DOT Private Use LIFT MODEL#	
NL955E3143	
Max. Lifting Capacity - 750Lbs.	
SERIAL NUMBER	
03-00001	
PUMP CODE	CYLINDER
56	14CF
MFG DATE	
07/08/2005	
 e5*72/245**95/54*0110*00 U.S. PATENT 5261779-5806632-6692217	

Warranty and Registration Instructions

Model No. _____ Pump Code _____

Series No. _____ Cylinder Code _____

Serial No. _____ Date of Manufacture _____

Note: This information **must be provided** when filing a warranty claim or ordering parts. Keep for future use.

Lift Terminology Illustration

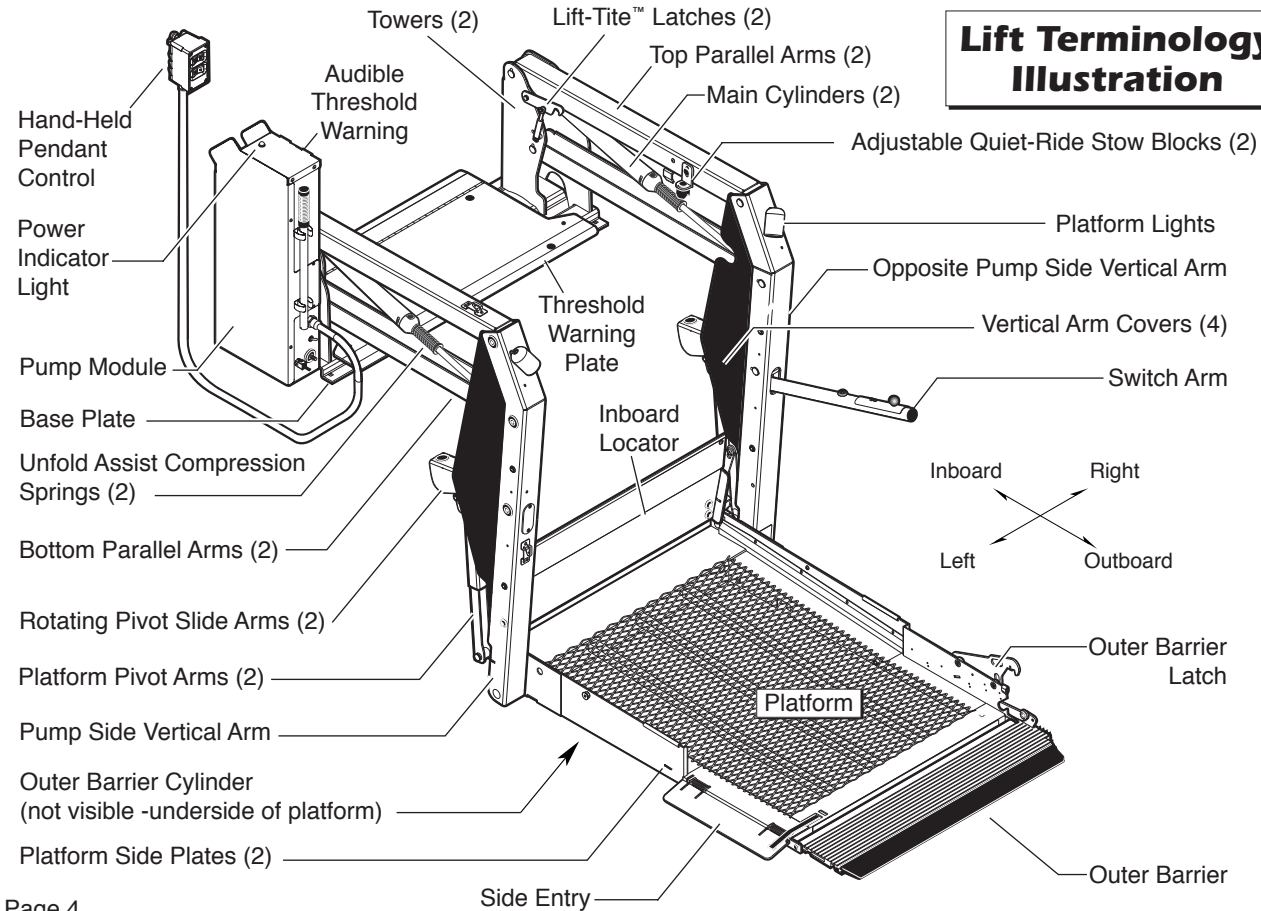

Lift Terminology

Introduction:

Braun NL955 Millennium Series lifts comply fully with the National Highway Traffic Safety Administration (NHTSA) specifications. The Braun NL955 is consumer oriented (designed to allow operation by the wheelchair passenger). NL955 lift models provide fully automatic operation of all lift functions as well as optional automatic door operators (if so equipped).

Lift models vary per platform size (lift model numbers indicate lift dimensions). A standard NL955 lift model is depicted in the Lift Terminology Illustration. Refer to

the Lift Terminology Illustration for identification of lift components.

Lift operation procedures are identical for all NL955 Series lift models. The operating instructions contained in this manual and appearing on lift-posted operating instructions decals address the lift control switches and the corresponding lift functions. Instructions are provided for manual operation of the lift in event of power or equipment failure.

Terminology: Become familiar with the terminology that will be used throughout this manual. Become familiar with the identification of lift components and their functions. Contact your lift sales representative or call The Braun Corporation at 1-800-THE LIFT® if any of this information is not fully understood.

Direction: The terms “left,” “right,” “inboard,” and “outboard” will be used throughout this manual to indicate direction (as viewed from outside the vehicle looking directly at the lift). Refer to the Lift Terminology Illustration for clarification of direction terms.

Lift Terminology

Lift Components

Refer to the Lift Terminology Illustration on page 4.

Pump Module: The lift-mounted pump module consists of the hydraulic pump, the manual hand pump, the electronic control board and electrical components that power the lift electric/hydraulic systems. The pump module is equipped with three function-labeled control switches.

Hand-held Pendant Control: The hand-held attendant's pendant control is connected to the pump module. The hand-held pendant is equipped with four push button switches, (UNFOLD,

FOLD, DOWN, and UP). The momentary switches activate the automatic lift functions. The lift function labels illuminate to identify the function(s).

Lift Frame: The lift frame consists of the base plate, threshold warning plate, towers, parallel arms, vertical arms, platform pivot arms and switch arm. Two main hydraulic cylinders are housed in the parallel arms. The electrical/hydraulic powered lift frame components mechanically unfold, lower, raise and fold the lift platform assembly.

Switch Arm: An additional UP/DOWN switch is provided on the switch arm.

Platform Assembly: The platform assembly consists of the steel tubing frame with grating surface upon which the wheelchair is positioned, the outer barrier, outer barrier latch, the inboard locator, side entry and the hydraulic cylinder assembly that powers the outer barrier.

Lift-Tite™ Latches: The spring-loaded latches prevent the platform from unfolding from the stowed position in the event of platform drift. Further details regarding Lift-Tite™ latches are provided on pages 18 and 19.

Outer Barrier: The cylinder-powered automatic outer barrier provides a ramp for wheelchair loading and unloading at ground

Lift Terminology

level. The NL955 platform is equipped with a side entry that allows boarding and exiting in tight parking situations. The outer barrier and side entry function together in unison.

Outer Barrier Latch: The spring-loaded latch locks the outer barrier in the vertical position when the platform raises above ground level.

Inboard Locator: NL955 Series lift models are equipped with an automatic inboard locator that also serves as the bridge plate. The bridge plate bridges the gap between the lift platform and the vehicle floor. The inboard locator/bridge plate automatically rotates from the horizontal position

to the vertical position as the lift lowers and raises. Further details regarding the automatic mechanical inboard locator are provided on pages 18 and 19.

Vehicle and Lift Interlocks

Braun Corporation NL955 Series lifts comply fully with all NHTSA vehicle and lift interlock specifications. Vehicle movement is prohibited unless the lift door is closed, ensuring the lift is stowed. The lift will not function unless the vehicle is parked and secured.

The NL955 features an audible threshold warning system that will activate if the threshold area

is occupied when the platform is one inch or more below floor level.

The inboard locator and outer barrier sense weight to prohibit lift operation. The lift will not function if the inboard locator or the outer barrier are occupied. The lift platform cannot be folded (stowed) if occupied

Lift Terminology

Lift Actions and Functions

DEPLOY (A-C)

A. UNFOLD (Out) - Platform

Unfold: Unfold is the action of the platform rotating out and down from the fully-stowed (vertical) position to floor level (horizontal) position when the UNFOLD switch is pressed.

B. DOWN - Platform Lower:

Down is the action of the platform lowering from floor level position to fully-lowered (ground level) position when the DOWN switch is pressed.

C. DOWN - Outer Barrier

Unfold (Deploy) - When the platform reaches the fully-low-

ered (ground) position and the DOWN switch is continued to be pressed, the outer barrier rotates downward from vertical position to ramp position.

STOW (D-F)

D. UP - Outer Barrier Fold

(Raise): When the lift is fully lowered and the outer barrier is in the ramp position, pressing the UP switch first rotates the outer barrier upward from ramp position to vertical position.

E. UP - Platform Raise: Up is the action of the platform raising from ground level to floor level (fully-raised) position when the UP switch is pressed.

F. FOLD (In) - Platform Fold:

Fold is the action of the platform rotating up and in from the floor level (horizontal) position to fully-stowed (vertical) position when the FOLD switch is pressed.

Stowed Position: The lift is stowed when the lift platform has been fully raised and folded fully (vertical position).

Floor Level: Floor level is the position (height) the platform assembly reaches in order for the wheelchair passenger to enter and exit the vehicle (fully raised). The platform automatically stops at floor level when unfolding from the stowed position and when raising from ground level.

Lift Operation Safety

Safety Symbols

SAFETY FIRST! Know That ...

A All information contained in this manual and supplements (if included), is provided for your safety. Familiarity with proper operation instructions as well as proper maintenance procedures are necessary to ensure safe, troublefree operation. Safety precautions are provided to identify potentially hazardous situations and provide instruction on how to avoid them.

B

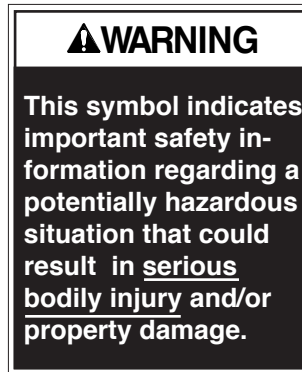

C

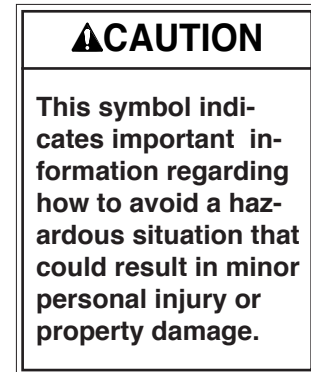

D **Note:** Additional information provided to help clarify or detail a specific subject.

These symbols will appear throughout this manual as well as on the labels posted on your lift. **Recognize the seriousness of this information.**

Lift Operation Safety

Lift Operation Safety Precautions

WARNING

If the lift operating instructions, manual operating instructions and/or lift operation safety precautions are not fully understood, contact The Braun Corporation immediately. Failure to do so may result in serious bodily injury and/or property damage.

 **WARNING** Read manual and supplement(s) before operating lift. Read and become familiar with all safety precautions, operation notes and details, operating instructions and manual operating instructions before operating the lift. **Note:** Wheelchair passengers and all transit agency personnel (drivers and wheelchair lift attendants) must read and become familiar with the contents of this manual and supplement(s) before operation.

 **WARNING** Load and unload on level surface only.

 **WARNING** Engage vehicle parking brake before operating lift.

 **WARNING** Provide adequate clearance outside the vehicle to accommodate the lift before opening lift door(s) or operating lift.

 **WARNING** Inspect lift before operation. Do not operate lift if you suspect lift damage, wear or any abnormal condition.

 **WARNING** Keep operator and bystanders clear of area in which the lift operates.

Lift Operation Safety

- ⚠WARNING** Whenever a wheelchair passenger (or standee) is on the platform, the:
 - Passenger must face outward.
 - Wheelchair brakes must be locked.
 - Inboard locator and outer barrier must be up (vertical).
 - Outer barrier latch must be fully engaged.

- ⚠WARNING** Load and unload clear of vehicular traffic.

- ⚠WARNING** Do not overload or abuse. The load rating applies to both the raising and lowering functions - continuous lifting capacity is 750 lbs.

- ⚠WARNING** Discontinue lift use immediately if any lift or vehicle interlock does not operate properly.

- ⚠WARNING** Do not operate or board the lift if you or your lift operator are intoxicated.

- ⚠WARNING** Do not raise front wheelchair wheels (pull wheelie) when loading (boarding) the platform.

- ⚠WARNING** Open lift door(s) fully and secure before operating lift.

- ⚠WARNING** Position and secure (buckle, engage, fasten, etc.) the wheelchair-equipped occupant seat belt (torso restraint) before loading onto the wheelchair lift platform.

- ⚠WARNING** Lift attendants must ensure that lift occupants keep hands, arms and all other body parts within the lift occupant area and clear of moving parts.

Lift Operation Safety

Lift Operation Safety Precautions

⚠️ WARNING

If the lift operating instructions, manual operating instructions and/or lift operation safety precautions are not fully understood, contact The Braun Corporation immediately. Failure to do so may result in serious bodily injury and/or property damage.

- ⚠️ WARNING** Platform must be positioned at floor level (bridge plate height) when loading or unloading in and out of vehicle.
- ⚠️ WARNING** Do not use platform inboard locator or outer barrier as a barrier (brake). Stop and brake wheelchair when loading onto the platform (manually stop and brake manual wheelchairs — stop powered wheelchairs with the wheelchair controls).
- ⚠️ WARNING** Turn powered (electric) wheelchairs off when on lift platform.
- ⚠️ WARNING** Press the DOWN switch until the entire platform rests on ground level (lowered fully) and the outer barrier is fully unfolded (ramp position) before loading or unloading a passenger at ground level.
- ⚠️ WARNING** Outer barrier must be fully unfolded (ramp position) until the entire wheelchair crosses the barrier when loading or unloading at ground level.

⚠️ WARNING Accidental activation of control switch(es) may cause unintended operation(s).

Lift Operation Safety

- ⚠WARNING** Maintenance and lubrication procedures must be performed as specified in this manual by authorized (certified) service personnel.
- ⚠WARNING** Replace missing, worn or illegible decals.
- ⚠WARNING** Keep this operator's manual in lift-mounted manual storage pouch when not in use.
- ⚠WARNING** Never modify (alter) a Braun Corporation lift.
- ⚠WARNING** Do not use accessory devices not authorized by The Braun Corporation.
- ⚠WARNING** Do not remove any guards or covers.
- ⚠WARNING** Keep clear of any hydraulic leak.
- ⚠WARNING** Failure to follow these safety precautions may result in serious bodily injury and/or property damage.

Operation Notes and Details

WARNING

Read and become familiar with all lift operation safety precautions, operation notes and details, operating instructions and manual operating instructions prior to operating the lift. If this information is not fully understood, contact The Braun Corporation immediately. Failure to do so may result in serious bodily injury and/or property damage.

NL955 Series “Private Use” lift models are designed to allow operation by the wheelchair passenger. NL955 Series lifts are typically installed in vehicles equipped with fully-automatic door operators. The NL955 provides fully automatic operation of all lift functions as well as optional automatic door operators (if so equipped).

Note: An attendant must manually open and close lift door(s) in applications where power door operator(s) are not provided.

It is the responsibility of the lift operator (attendant and/or wheelchair passenger) to properly activate all power (lift and door) functions. Read

and become familiar with all lift operation safety precautions, operation notes and details, lift operating instructions and manual operating instructions before attempting lift operating procedures.

General Safety: Before operating the lift, always engage the vehicle transmission in Park “P” and engage the vehicle parking brake. **Note:** Lift and vehicle interlocks prevent lift operation until the vehicle is immobilized.

Lift operators (attendants), wheelchair passengers and bystanders must keep clear of the area in which the power doors (if equipped), and the lift operates (clear of all moving parts). The lift occupant (passenger)

Operation Notes and Details

must keep hands, arms and all other body parts within the lift occupant area and clear of moving

parts. Follow all lift operation and wheelchair passenger information detailed in this manual.

Control Switches

Lift Power Switch



Lift Power ON/OFF Switch: This switch must be in the ON position in order to activate the lift controls. The green Power Indicator Light mounted on top of the pump module illuminates to signal power to the lift.

Lift-mounted Control Switches: The lift-mounted control switches activate the automatic lift functions and optional door operators. The switches are function labeled. Press the switches in the direction of the function label to activate the intended lift function.

Press switches **upward** for these functions:

Door(s)	Platform	
CLOSE	FOLD	UP
Yellow	Orange	Red



Yellow Orange Red

OPEN	UNFOLD	DOWN
Door(s)	Platform	

Press switches **downward** for these functions:

Operation Notes and Details

Control Switches (continued):

Hand-held Pendant Control: The hand-held attendant's pendant control is equipped with four push button switches, (UNFOLD, FOLD, DOWN, and UP). The momentary switches activate the automatic lift functions. Simply press the switch labeled for the intended lift function.

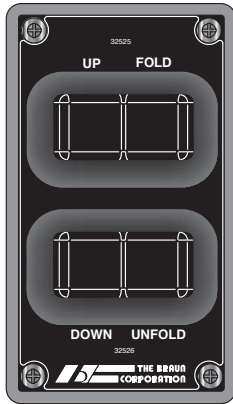

When there is power to the lift, the lift function labels illuminate to identify the function(s).

Switch Arm UP/DOWN Switch: A spring-loaded horizontal-slide style switch is built in the switch arm. The switch arm UP/DOWN switch activates the platform, outer barrier and inboard locator functions. Slide the switch knob out to the UP position to raise the platform. Slide the knob in to the DOWN position to lower the platform.

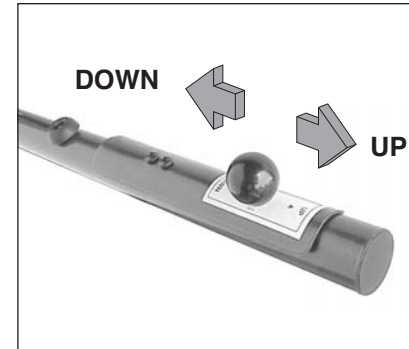

Operation Notes and Details

Power Door Operator(s):

Optional power door operators cannot be activated using the hand-held pendant. Open and close power doors using the pump module OPEN/CLOSE switch, optional remote control or auxiliary 3rd Station control. In the event the vehicle is not

equipped with power door operator(s), manually open and close the door(s).

Auxiliary Control Switches:

A six-touch remote control system, a third station control and an outside control station are available as **options**. All auxiliary controls activate lift functions and automatic door operators.

Do not press lift-mounted switches and auxiliary control station switches at the same time. Do not attempt to interface after-market control systems.

WARNING

Discontinue lift use immediately if any lift component does not operate properly. Failure to do so may result in serious bodily injury and/or property damage.

Braun Corporation After-market Control Systems Policy:

The Braun Corporation manufactures dedicated control systems for its products. These control systems have been designed and tested for use in conjunction with specific Braun products. Braun control systems are the **only** control systems authorized for use with Braun products.

Do not attempt to interface aftermarket control systems with Braun products. **To do so may result in serious bodily injury and/or property damage.**

Operation Notes and Details

Lift Features

Become familiar with all lift features and the proper operation of the lift components **before** attempting lift operation. Refer to the Lift Terminology section

for identification of and description of lift components. Contact The Braun Corporation immediately if any of this information is not fully understood. Call 1-800-THE LIFT®.

Lift-Tite™ Latches: NL955 Series lifts are equipped with Lift-Tite™ Latches. Lift-Tite™ Latches prevent the platform from unfolding from the stowed position in

⚠ WARNING

Discontinue lift use immediately if any lift component does not operate properly. Failure to do so may result in serious bodily injury and/or property damage.

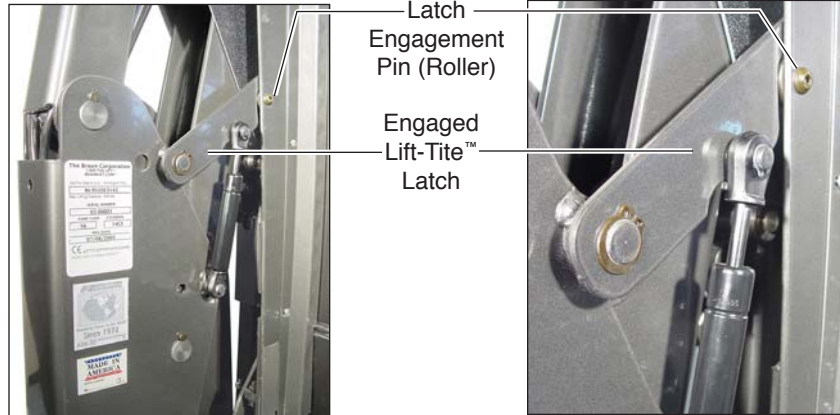

Operation Notes and Details

the event of platform drift. Due to the “all-hydraulic” operation of the dual-cylinder NL955, hydraulic fluid expansion, contraction or seepage may occur. Any of these conditions may result in platform drift (failure to hold the platform in the folded or raised position). Platform drift may occur during lift shipment and/or between extended periods of non-lift use.

In the event that the platform does not unfold when the UNFOLD switch is pressed, press the FOLD switch momentarily to disengage the Lift-Tite™ latches (platform drift has occurred). Then, press the UNFOLD switch to unfold the platform to floor level (stan-

dard operation). When manually operating a lift equipped with Lift-Tite™ latches, insert the pump handle in the pump and stroke until the platform folds fully (stops). Then, open the hand pump valve (turn counterclockwise) to unfold

the platform. Folding the platform fully first will ensure that the Lift-Tite™ latches will disengage properly when the release valve is opened. Manual Operating Instructions are provided on pages 37-39.

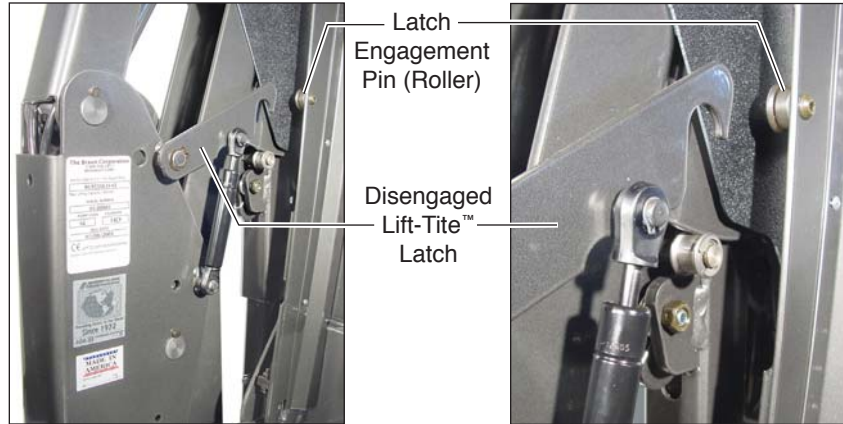

Operation Notes and Details

Lift Features (continued):

Inboard Locator and Bridge Plate: NL955 Series lift models are equipped with an automatic inboard locator that also serves as the bridge plate (inboard locator photos below).

When the UNFOLD switch is pressed and the platform unfolds from stow position to floor level, this mechanical locator/bridge plate is automatically deployed to the bridging (horizontal) position to provide a bridge plate between the platform and the lift base plate (vehicle floor). The inboard edge

of the bridge plate rests on the threshold warning plate (base plate).

The locator/bridge plate automatically folds (rotates) to the vertical (roll stop) position when the platform lowers to the ground (DOWN switch is pressed). As



Fully-Deployed (vertical)
Inboard Locator

Fully-Unfolded (horizontal)
Inboard Locator (bridging position)

Inboard Locator and Bridge Plate

The inboard locator/bridge plate **must overlap** the base plate a **minimum 1/2"**.



Operation Notes and Details

the UP switch is pressed and the platform raises from ground level, the inboard locator automatically unfolds (rotates) to the horizontal (bridging) position when it reaches vehicle floor level. The bridge plate must overlap the lift base plate a minimum 1/2".

When the FOLD switch is pressed and the platform folds from floor level to the stow (vertical) position, the bridge plate automatically travels inboard to the stowed position.

Interlock: The inboard locator senses weight to prohibit lift operation if occupied.

Automatic Floor Level Switching: When the platform unfolds from the stowed position, the platform stops automatically at floor level when fully unfolded. When raising the platform from ground level, the platform automatically stops at floor level when raised fully.

Although the NL955 features automatic floor level switching, the lift operator (wheelchair passenger or attendant), **must view** the platform to **be certain** the platform is properly positioned at vehicle floor level and the bridge plate is properly positioned when a passenger is entering or exiting the vehicle. If the lift platform does not automatically stop at floor level as outlined,

discontinue lift operation immediately.

Outer Barrier and Side Entry: The NL955 platform is equipped with an outer barrier and a side entry. See photos A, B and C. The cylinder-powered outer barrier and side entry provide a

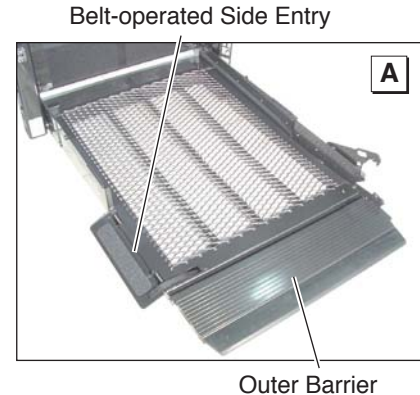

Operation Notes and Details

Lift Features (continued)

ramp for wheelchair loading and unloading at ground level. The side entry is useful in tight parking situations by reducing wheelchair caster “turn-out” when boarding and exiting the platform. The barrier and side entry function in unison. **Discontinue lift oper-**

ation immediately if the outer barrier or side entry do not operate properly.

Outer Barrier: When the platform lowers fully to ground level, the roll stop cylinder compression spring automatically unfolds (rotates) the outer barrier to the ramp position (fully unfolded).

Although the outer barrier is lift-powered, activation of the barrier is controlled by the lift operator. Activating either DOWN switch unfolds the barrier. The barrier is cylinder-powered to automatically fold (rotate) to the vertical position when the UP switch is activated (barrier raises before platform raises).

**Fully-Unfolded (Ramp position)
Outer Barrier and Side Entry**

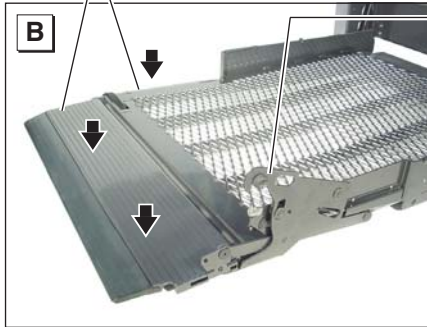

**Disengaged
Barrier Latch**

Note: The platform must raise **approximately three inches before the latch engages fully.**

Fully-Engaged Barrier Latch

**Fully-Folded
(Up-vertical)
Outer Barrier
and
Side Entry**

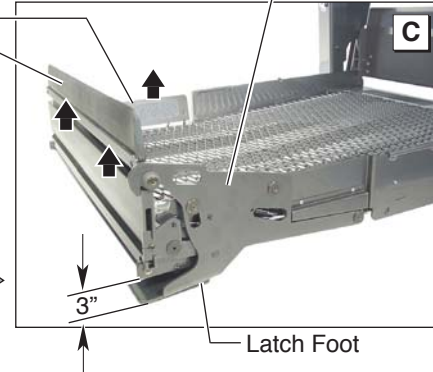

Operation Notes and Details

Interlock: The outer barrier senses weight to prohibit lift operation if occupied.

Side Entry: When the platform lowers fully to ground level, the spring-loaded side entry unfolds (rotates) to the ramp position simultaneously with the outer

barrier (when DOWN switch is activated). See photos A and B. The belt and chain driven side entry is powered by the barrier cylinder to automatically fold (rotate) to the vertical position when the UP switch is activated.

Outer Barrier Latch: A spring-loaded latch engages the outer barrier when the barrier rotates upward from ramp position to the vertical position (UP switch is activated to raise the platform above ground level).

Note: The platform must raise approximately three inches **before** the latch engages **fully** (see photo C on page 22).

The latch disengages the barrier when the platform lowers fully

(reaches ground level) and the latch foot contacts the ground (latch raises above the barrier).

⚠ WARNING

Discontinue lift use immediately if any lift component does not operate properly. Failure to do so may result in serious bodily injury and/or property damage.



The lift operator or attendant must **be certain** the **entire platform** reaches and rests safely on the ground.

Operation Notes and Details

Lift Features (continued):

Interlock: Lift platform movement will be interrupted unless the barrier is raised and the outer barrier latch is positively engaged.

Outer Barrier and Latch Operation: The lift operator must activate the DOWN switch to lower the platform fully to the ground. The lift operator or attendant **must view** the platform as it lowers to **be certain** the **entire platform** reaches and rests safely on the ground. Stop activating the DOWN switch if any portion of the platform is obstructed while descending or the platform does not reach ground level **for any reason** (contact with an obstruction, mechanical

failure, exceeding the lift “floor-to-ground” capacity, etc.).

After the platform is fully lowered (platform reaches the ground), the lift operator should continue to press the DOWN switch to unfold the outer barrier and the side entry **fully** (ramp position).

Note: The outer barrier and side entry **must be fully unfolded** until the entire wheelchair has crossed when loading or unloading at ground level. **Discontinue lift operation immediately if the barrier or latch do not operate properly.**

Bridging: The NL955 incorporates a bridging feature. This feature stops the down travel of the platform if the outboard end

of the platform contacts a raised surface (such as a curb), preventing the operator from lowering the inboard end of the platform.

Switch Arm: The switch arm automatically unfolds to the deployed position when the platform unfolds and folds automatically to the stowed position when the platform folds. The passenger may choose to grip the switch arm when on the lift platform.

Note: The switch arm is equipped with an UP/DOWN control switch (page 16). **Discontinue lift operation immediately if the switch arm does not operate properly.**

Operation Notes and Details

Lift Passengers

Do not attempt to load or unload a passenger in a wheelchair or other apparatus that does not fit on the platform area. Do not exceed the 750 pound load capacity of the lift.

Passenger Orientation (Boarding Direction): The wheelchair passenger **must face outward** whenever on the platform.

The passenger must be positioned in the **center of the platform** to prevent side-to-side load imbalance. Other persons should **not** ride on the platform with the wheelchair passenger.

The wheelchair **brakes must be locked**, the inboard locator and the outer barrier must be in the

fully-up (vertical) position, and the outer barrier latch must be **fully engaged whenever a wheelchair passenger is on the platform**.

Do not use the outer barrier as a brake. Stop and brake the wheelchair when fully loaded on the platform. Manually stop and brake manual wheelchairs. Stop powered wheelchairs with the wheelchair controls. Turn powered (electric) wheelchairs off when on the platform.

Interlock: An audible threshold warning will activate if the threshold area is occupied when the platform is one inch or more below the level. The threshold warning plate identifies the platform threshold area.

Vehicle (Floor Level) Loading and Unloading: The platform **must be fully raised** (at floor level) and the bridge plate must be properly positioned when loading or unloading a passenger in or out of the vehicle. Although the NL955 features automatic floor level switching, **it is the responsibility of the lift operator to ensure the platform and the bridge plate are properly positioned at floor level when loading and unloading passengers**.

If the outer barrier, inboard locator or any other lift component does not operate as outlined in this manual, **discontinue lift use immediately** and contact your sales representative or call The Braun Corporation at 1-800-THE LIFT®.

Operation Notes and Details

One of our national Product Support representatives will direct you to an authorized service technician who will inspect your lift.

WARNING

Position and secure (buckle, engage, fasten, etc.) the wheelchair-equipped occupant seat belt before loading onto the wheelchair lift platform. Failure to do so may result in serious bodily injury and/or property damage.

Wheelchair-Equipped Occupant Seat Belts

The Braun Corporation recommends wheelchair passengers position and buckle their wheelchair-equipped seat belt (torso restraint) as specified by the manufacture **before** loading onto a wheelchair lift.

Different types of disabilities require different types of wheelchairs and different types of wheelchair-equipped occupant restraint belt systems (torso restraint). It is the responsibility of the wheelchair passenger to have his or her wheelchair equipped with an occupant restraint (seat belt) under the direction of their health care professional.

Wheelchair lift attendants should be instructed on any special needs and/or procedures required for safe transport of wheelchair passengers.

Operation Procedure Review

The Braun Corporation recommends that the wheelchair lift user and/or attendant review the safety precautions and operation procedures appearing in this manual and on lift-posted decals with your wheelchair lift sales representative, **before** attempting lift operation. Any questions or concerns can be answered by your sales representative at that time.

Operation Notes and Details

Using your own wheelchair, operate the lift through all functions and enter and exit the vehicle with the sales representative on hand to ensure the lift is right for you as the end user (applicable for your use based on your physical abilities and the physical characteristics of your personal wheelchair). Become familiar with the proper operation of your lift before operating the lift by yourself.

This lift operator's **manual must be stored in the lift-mounted manual storage pouch when not in use.**

Preventive Maintenance

Maintenance is necessary to ensure safe and trouble-free lift operation. Preventive lift maintenance consisting of **careful** inspections of your lift system and cleaning the lift should be a part of your routine. Simple inspections can detect potential lift operational problems.

Regular preventive maintenance will reduce potential lift operation downtime and increase the service life of the lift, as well as enhancing safety.

During routine inspections, operate the lift through a minimum of one complete cycle and note the following:

- Do the automatic door(s) open fully (if equipped)?
- Does the lift safely clear the door(s) when unfolding and folding?
- Do the lift control switches function properly?
- Do the automatic inboard locator and outer barrier operate properly?
- Does the outer barrier latch operate properly?
- Does the switch arm function properly?
- Is the power source adequate or weak?

Operation Notes and Details

WARNING

Maintenance and lubrication procedures must be performed by authorized service personnel as specified in this manual. Failure to do so may result in serious bodily injury and/or property damage.

Exposure to harsh weather elements, environment conditions, or heavy usage, etc. may require more frequent maintenance and lubrication procedures.

Preventive maintenance visual inspections **do not** take the place of the procedures specified in the Maintenance and Lubrication Schedule provided on pages 44-51 of this manual. Refer to the Maintenance and Lubrication section in this manual for further details.

Lift Operating Instructions

WARNING

Read and become familiar with all lift operation safety precautions, operation notes and details, operating instructions and manual operating instructions prior to operating the lift. If this information is not fully understood, contact The Braun Corporation immediately. Failure to do so may result in serious bodily injury and/or property damage.

Before lift operation, park the vehicle on a level surface, away from vehicular traffic. Place the vehicle transmission in “Park” and engage the parking brake.

Photos appearing in the Lift Operating Instructions depict lift functions being activated by lift-mounted control switches only. Lift-posted Warnings and Lift Operating Instructions decal 31893 provides lift operating instructions. Replace any missing, worn or illegible decals.

If your lift does not function as intended or an audible warning signal is activated, review the NHTSA Operations Checklist on page 36. Follow the Manual Operating Instructions on pages 37-39 in the event of a power or equipment failure.

WARNING

Whenever a passenger is on the platform, the:

- Passenger must face outward.
- Wheelchair brakes must be locked.
- Inboard locator and outer barrier must be UP.

Failure to do so may result in serious bodily injury and/or property damage.

Lift Operating Instructions



To Open Door(s):

Automatic Door Operator(s):

Press yellow OPEN switch until door(s) are **fully open**. Release switch.

Manual Door(s):

Manually open door(s) **fully** and secure.

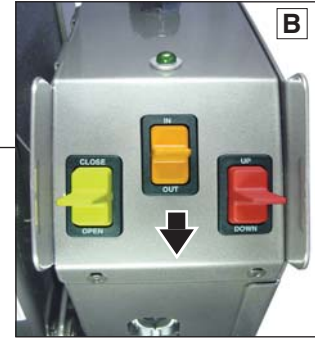

To Unfold Platform (Out):

Press orange UNFOLD switch until platform **stops** (unfolds fully – reaches floor level). Release switch.



Lift Operating Instructions



To Unload Passenger:

- 1. **Read notes below!** Load passenger onto platform **facing outward** and **lock** wheelchair brakes.

- Note:** Outer barrier **must** be UP and barrier latch **must** be fully engaged **before** loading passenger onto platform. **Lower head** to clear vehicle door jamb header.

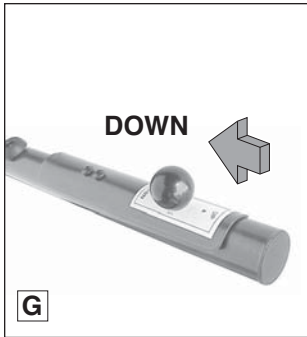
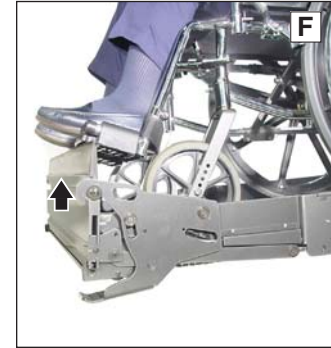

- 2. Press red DOWN switch until the **entire** platform reaches ground level (stops) and outer barrier unfolds **fully** (see Photos H and I). Release switch.

- Switch Arm: Slide knob in to DOWN position. See Photo G.



Lift Operating Instructions



To Unload Passenger: (continued)

3. Unlock wheelchair brakes and unload passenger from platform.

Note: Outer barrier **must be fully unfolded** (ramp position) until the entire wheelchair has crossed the roll stop. See Photos K and L.

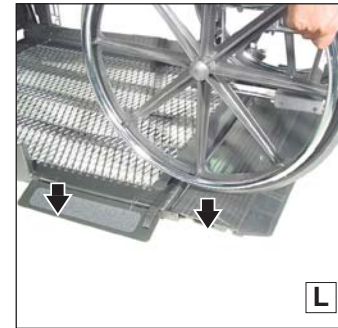
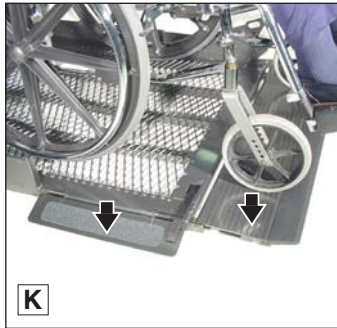

Lift Operating Instructions

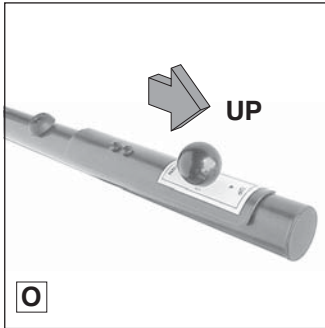

To Load Passenger:

1. Load passenger onto platform **facing outward** and **lock wheelchair brakes**.

Note: Outer barrier **must** be **fully unfolded** (ramp position) until the entire wheelchair has crossed the roll stop. See Photos K and L.

2. Press red UP switch until platform stops (reaches floor level). Release switch. See Photo S.

Switch Arm: Slide knob out to UP position.

Note: Outer barrier **must** be UP and barrier latch **must** be fully engaged **before** raising platform. Platform will raise above ground level approximately three inches **before** latch engages **fully**.

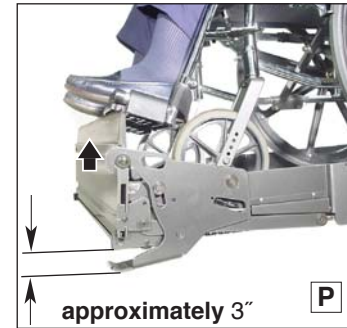

Lift Operating Instructions



To Load Passenger (continued):

3. Unlock wheelchair brakes and load passenger from platform into vehicle. **Note:** Lower head to clear door jamb header.



To Fold Platform (In):

- Press orange FOLD switch until platform **stops** (fully folded). Release switch.



Lift Operating Instructions



To Close Door(s):

Automatic Door Operator(s):

- ◀ Press yellow CLOSE switch until door(s) are **fully closed**. Release switch.

Manual Door(s):

Manually close door(s) **fully**.

NHTSA Operations Checklist

The following operations have been verified upon installation. This operational checklist can be used at any time to verify the lift is fully functional.

Verified:

- Vehicle movement is prevented unless the lift door is closed, ensuring the lift is stowed.
- Lift operation shall be prevented unless the vehicle is stopped and vehicle movement is prevented.
- The platform will not fold/stow if occupied.
- The inboard locator will not raise if occupied.
- The outer barrier will not raise if occupied.
- A warning will activate if the threshold area is occupied when the platform is at least one inch below floor level.
- Lift platform movement shall be interrupted unless the outer barrier is deployed.



Manual Operating Instructions

If you experience power or equipment failure, refer to the Manual Operating Instructions to operate the lift. Instructions and photos are provided for all steps that

differ from standard lift operation procedures. Manual Instructions Decal 31894 (posted on pump cover) provides manual operating instructions also. Refer to the Lift

Operating Instructions for all normal lift operation procedures (such as loading and unloading passengers). **Follow all Lift Operation Safety Precautions!**

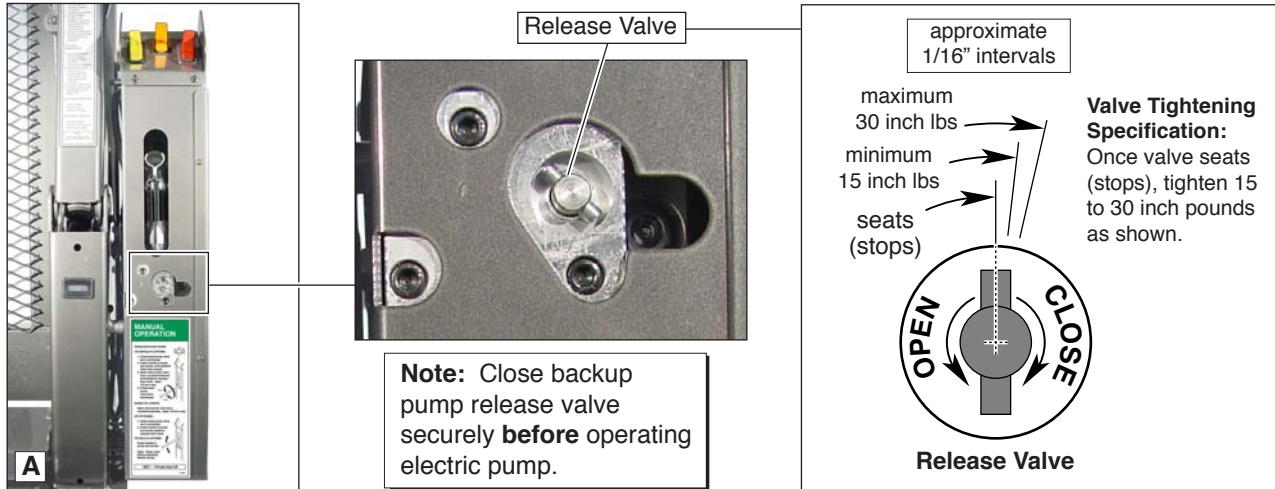

Manual Operating Instructions

Refer to photos and illustration of release valve on page 37.

Hand Pump Handle



To Unfold Platform (Out):

Using hand pump handle (Photo B):

1. Close hand pump valve (place slotted end of pump handle onto backup pump release valve and turn **clockwise**).
2. Insert handle in pump and stroke until platform folds fully (stops). See Photo E on page 39.
3. Open hand pump valve (turn **counterclockwise**) until platform reaches floor level. **Open 1/2 turn only**.
4. Close hand pump valve (turn **clockwise**).

Note: Valve must be tight, but **do not** overtighten.

Down (To Lower):

Place slotted end of pump handle onto back-up pump release valve and turn **counterclockwise** (open — **1/2 turn only**) until the platform reaches ground level and the outer barrier unfolds.



Manual Operating Instructions

Refer to photos and illustration of release valve on page 37.



Up (To Raise):

Using hand pump handle:

- Place slotted end of pump handle onto back-up pump release valve and turn **clockwise** to close securely. See Photo D.

Note: Valve must be tight, but **do not** overtighten.

- Insert handle into back-up pump and stroke until platform reaches **floor level** (see Photo E).

To Fold Platform (In):

Insert handle into back-up pump and stroke until platform **stops** (folds **fully**). See Photo E.

Note: Close back-up pump release valve securely **before** operating electric pump. Store pump handle in clamps shown in Photo B on page 38.

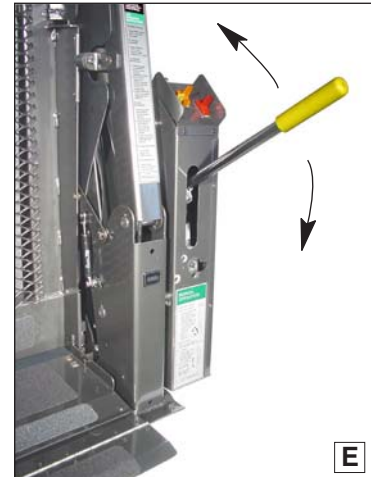

Decals and Antiskid



Note: Clean surfaces as detailed on page 42 before posting decals.

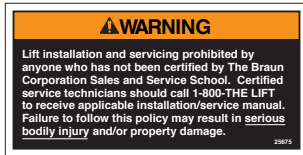

Decals

31893

The lift is only as safe as the operator. Replace any missing, worn or illegible decals! Part numbers are provided for missing, worn or illegible decals. Call 1-800-THE LIFT® for replacements.

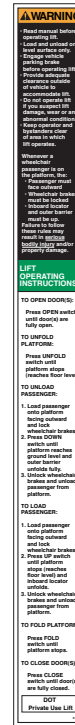
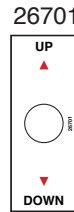
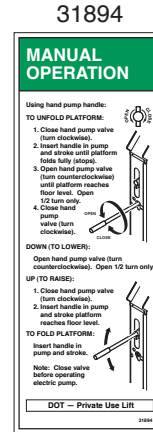

Decals and Antiskid

Decals

32410

LCD Lift Codes

Listed below are codes that the lift controller displays during lift operation. The codes will be displayed on an LCD screen located on the lift control board inside the pump module.

Non-Flashing Numbers

- 01 – Platform raised
- 02 – Platform unfolding
- 03 – Platform unfolding paused
- 04 – Platform at floor level
- 05 – Platform beginning to lower
- 06 – Platform lowering (threshold cannot be occupied from this point down)
- 07 – Outer barrier moving to horizontal position
- 08 – Platform at ground level
- 09 – Outer barrier moving to vertical position
- 10 – Platform raising
- 11 – Platform raising (paused at floor)
- 12 – Platform holding (limited pressure)
- 13 – Platform holding (full pressure)
- 14 – Timeout (opening lift fail or late-stall state)
- 15 – Platform holding stopped
- 16 – Platform failed
- 17 – Platform between ground and 5" above ground
- 18 – Platform above 3"
- 19 – Outer barrier moving to horizontal position
- 20 – The doors are not fully opened (only applicable when door operators are installed)
- 21 – The doors are opening (only applicable when door operators are installed)
- 22 – The doors are closing (only applicable when door operators are installed)
- 23 – Illegal functionality defined
- 29 – Interlock fault not recognized (or has been diagnosed but a motion button is still pressed)
- 30 – Platform location unknown
- 31 – Platform location transition state; attempting to locate position
- 35 – Two or more motion buttons are being pressed
- 36 – The retention belt cannot be buckled while trying to lift or unlift
- 37 – Motion button being pressed is not a valid motion
- 50 – Outer barrier is not up above inboard barrier locked position
- 51 – Threshold is occupied when platform is 1" or more below floor level
- 52 – Inner rolloft is not up and locked below inner rolloft locked position
- 53 – Inner rolloft occupied sensor is not activated between floor and inner rolloft up position
- 54 – Outer barrier is occupied before it is up
- 55 – Outer barrier is not latched when above the inner rolloft locked position (Millennium only)
- 56 – Outer barrier is not up and latched and bridge switch did not deactivate

- 57 – Outer barrier is not up and latched and ground detect switch did not deactivate (Century and 1800 only)
- 58 – Outer barrier is not up and latched and the platform is 2" above the ground
- 59 – Outer barrier is not up after pausing platform travel
- 60 – The without gas springs are worn, replace before using
- 70 – Low voltage detected; must turn off power switch to reset LCD
- 77 – Vehicle secure (interlock has not been activated)
- 90 – Position will be set if you keep holding the button until it beeps
- 91 – Position is out of a predetermined acceptable range of floor position
- 92 – Bridge switch is not made, needs adjusting
- 93 – Inner rolloft occupied switch is not made, position needs to be moved or switch should be adjusted
- 94 – Outer barrier is not made, fix and try again
- 95 – Outer barrier latch is not made (check for jam on Century and 1800 lifts, check latch on Millennium lifts)
- 99 – Controller program is not valid; replace controller

Flashing Numbers

- Flashing 65 – Unlift button is pressed
- Flashing 66 – Fold button is pressed
- Flashing 67 – Down button is pressed
- Flashing 68 – Up button is pressed
- Flashing 76 – Bridge switch is activated
- Flashing 79 – Outer barrier latch switch is activated
- Flashing 79 – Ground detect switch is activated
- Flashing 72 – Outer barrier up switch is activated
- Flashing 73 – Inner rolloft up switch is activated
- Flashing 74 – Inner rolloft occupied switch is activated
- Flashing 78 – Outboard barrier occupied switch is activated
- Flashing 78 – Threshold tape switch "A" is activated
- Flashing 79 – Threshold tape switch "B" is activated
- Flashing 80 – Position set button is pressed
- Flashing 81 – Single function UP / FOLD / CLOSE button is pressed
- Flashing 82 – Single function OPEN / UNFOLD / DOWN button is pressed
- Flashing 87 – CLOSE button is pressed
- Flashing 88 – OPEN button is pressed
- Flashing 89 – Door full open switch is activated (on jumper is installed on control board)

32201

PLATFORM FOLD RELIEF VALVE ADJUSTMENT

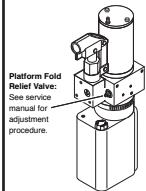

Platform Fold Relief Valve:
See service manual for adjustment procedure.

32201

25580

BRAUN MILLENNIUM SERIES

30787



18229



25652



Decals and Antiskid

Antiskid

Inspect your lift for any missing or worn antiskid. Order as needed.

WARNING

Replace missing or worn antiskid. Failure to do so may result in serious bodily injury and/or property damage.

Note: Clean surfaces with isopropyl alcohol before decal or antiskid application. Use a clean cloth or paper towels. **Do not** use oily shop rags. Wipe surface free of residue with dry portion of cleaning cloth.

Available Antiskid

Size	Color	Part No.
2" x 12"	Black	#24172-BK
2" x 12"	Yellow	#24172-YL
3" x 8"	Black	#31188-BK
3" x 12"	Black	#24173-BK
3" x 12"	Yellow	#24173-YL
6" x 12"	Black	#24174-BK
6" x 12"	Yellow	#24174-YL

Maintenance and Lubrication

Proper maintenance is necessary to ensure safe, troublefree operation. Inspecting the lift for any wear, damage or other abnormal conditions should be a part of a regular service program. Simple inspections can detect potential problems.

The maintenance and lubrication procedures specified in the following schedule **must** be performed by a Braun authorized service representative at the scheduled intervals according to the number of cycles.

NL Series lifts are equipped with hardened pins and self-lubricating bushings to decrease wear, provide smooth operation and extend the service life of the lift.

When servicing the lift at the recommended intervals, inspection and lubrication procedures specified in the previous sections should be repeated. **Clean** the components and the surrounding area **before applying lubricants**.

LPS2 General Purpose Penetrating Oil is recommended where Light Oil is called out. Use of improper lubricants can attract dirt or other contaminants which could result in wear or damage to the components. Platform components exposed to contaminants when lowered to the ground may require extra attention.

Lift components requiring grease are lubricated during assembly procedures. When these components are replaced, grease must be applied during installation procedures. Specified lubricants are available from The Braun Corporation (part numbers provided on page 44).

WARNING

Maintenance and lubrication procedures must be performed as specified by an authorized service technician. Failure to do so may result in serious bodily injury and/or property damage.

Maintenance and Lubrication

All listed inspection, lubrication and maintenance procedures should be repeated at “750 cycle” intervals following the scheduled “4500 Cycles” maintenance. These intervals are a general guideline for scheduling maintenance procedures and will vary according to lift use and conditions. Lifts exposed to severe conditions (weather, environment, contamination, heavy usage, etc.) may require inspection and maintenance procedures to be performed more often than specified.

Maintenance Indicator: The Lift Ready green LED mounted on top of the pump cover will begin to blink after every 750 cycles. The blinking LED will not affect the functions of the lift, but is a

reminder to complete necessary maintenance and lubrication. Once the lift has been serviced, fully stow the lift. Once stowed, press the UP button on the hand pendant and the Floor Level Set button on the back side of the pump cover until the Lift Ready green LED stops blinking.

Discontinue lift use immediately if maintenance and lubrication procedures are not properly performed, or if there is any sign of wear, damage or improper operation. Contact your sales representative or call The Braun Corporation at 1-800-THE LIFT®. One of our national Product Support representatives will direct you to an authorized service technician who will inspect your lift.

See the Maintenance/Lubrication Schedule for recommended applications per number of cycles.

Lubricant	Type	Specified (recommended) Lubricant	Available Amount	Braun Part No.
LO - Light Oil	Light Penetrating Oil (30 weight or equivalent)	LPS2, General Purpose Penetrating Oil	11 oz. Aerosol Can	15807
DE - Door-Ease	Stainless Stick Style (tube)	Door-Ease Stick (tube)	1.68 oz.	15806
LG - Light Grease	Light Grease (Multipurpose)	Lubriplate	14 oz. Can	15805

Maintenance and Lubrication

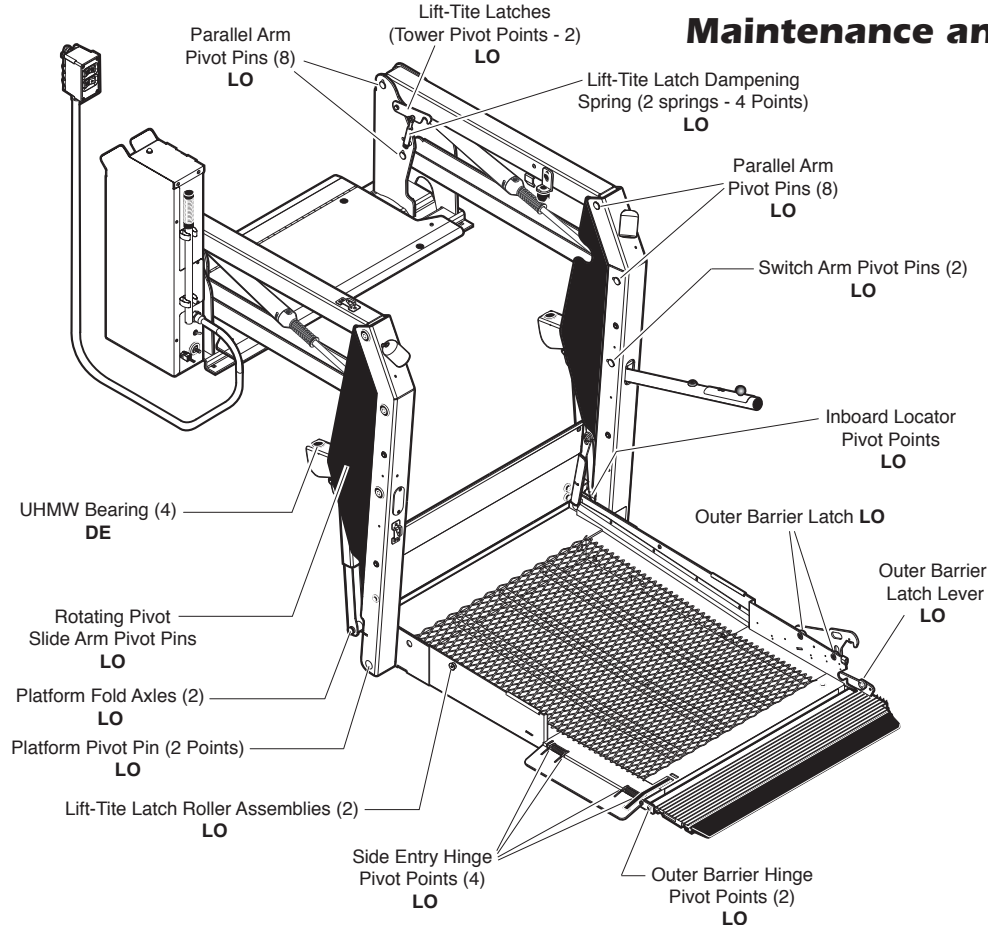

Note: LPS2 General Purpose Penetrating Oil is available in eleven ounce aerosol cans from The Braun Corporation (part number 15807).

Note: Clean lubrication points **before** applying lubricants.

Maintenance and Lubrication Schedule

750 Cycles	Outer barrier hinge pivot points (2)	Apply Light Oil - See Lubrication Diagram
	Outer barrier latch (pivot/slide points)	Apply Light Oil - See Lubrication Diagram
	Outer barrier latch lever pivot points	Apply Light Oil - See Lubrication Diagram
	Lift-Tite™ latches (tower pivot points - 2)	Apply Light Oil - See Lubrication Diagram
	Lift-Tite™ latch gas (dampening) spring pivot points (2 springs - 4 points)	Apply Light Oil - See Lubrication Diagram
	Inspect Lift-Tite™ latches and gas springs for wear or damage (bent, deformed or misaligned), positive securement (external snap rings) and proper operation	Resecure, replace defective parts or otherwise correct as needed. Note: Apply Light Grease to Lift-Tite™ latch tower pivot point if replacing latch.
	Inspect outer barrier for proper operation	Correct or replace defective parts.
	Inspect outer barrier latch for proper operation, positive securement, and detached or missing spring	Correct or replace defective parts and/or relubricate. See Lubrication Diagram
	Inspect lift for wear, damage or any abnormal condition	Correct as needed.
Inspect lift for rattles	Correct as needed.	

Maintenance and Lubrication Schedule

1500 Cycles	Perform all procedures listed in previous section also	
	Platform pivot pin bearings (2)	Apply Light Oil - See Lubrication Diagram
	Platform fold axles (2)	Apply Light Oil - See Lubrication Diagram
	Inboard locator lever bearings (2)	Apply Light Oil - See Lubrication Diagram
	Inboard locator lever slot (2)	Apply Light Oil - See Lubrication Diagram
	Rotating pivot slide arm pivot pins (2)	Apply Light Oil - See Lubrication Diagram
	Parallel arm pivot bearings (16)	Apply Light Oil - See Lubrication Diagram
	Switch arm pivot pin bearings (2)	Apply Light Oil - See Lubrication Diagram
	Hydraulic cylinder bushings (8)	Apply Light Oil - See Lubrication Diagram
	Inspect Lift-Tite™ latch rollers for wear or damage, positive securement and proper operation (2)	Correct, replace defective parts and/or relubricate.
Inspect inboard locator for:	Resecure, replace or correct as needed. See Platform Angle Instructions and Platform Floor Level Adjustment Instructions.	
	<ul style="list-style-type: none"> • Wear or damage • Proper operation. Inboard locator should just rest on top surface of the base plate. 	
continued		

Maintenance and Lubrication Schedule

continued	Perform all procedures listed in previous section also	
1500 Cycles	Inspect switch arm components for wear or damage, and for proper operation.	Replace defective parts.
	Inspect microswitches for securement and proper adjustment.	Resecure, replace or adjust as needed.
	Make sure lift operates smoothly.	Realign towers and vertical arms. Lubricate or correct as needed.
	Inspect external snap rings/e-clips: <ul style="list-style-type: none"> • Rotating pivot slide arm pivot pins (2 per pin) • Rotating pivot slide arm roller axles (2 per pin) • Platform cylinder pivot pins (2 per pin) • Platform fold axles (1 per axle) • Inboard locator lever bracket pins (1 per pin) • Lift-Tite™ latch gas (dampening) spring (2 per spring) 	Resecure or replace if needed.
	Inspect platform fold axles and bearings for wear or damage and positive securement.	Replace defective parts and resecure as needed. Apply Light Oil.
	Inspect Side Entry for proper operation, positive securement and wear or damage to nylon belt and roller chain.	Correct or replace defective parts.

Maintenance and Lubrication Schedule

1500 Cycles	<p>Remove pump module cover and inspect:</p> <ul style="list-style-type: none"> • Hydraulic hoses, fittings and connections for wear or leaks. • Harness cables, wires, terminals and connections for securement or damage. • Control board, circuit breaker, power switch and lights for securement or damage. 	<p>Resecure, replace or correct as needed.</p>
4500 Cycles	<div style="border: 1px solid black; padding: 2px; margin-bottom: 10px;"> <p>Perform all procedures listed in previous sections also</p> </div> <p>Inspect cotter pins on platform pivot pin (2).</p> <p>Hydraulic Fluid (Pump) - Check level. Note: Fluid should be changed if there is visible contamination. Inspect the hydraulic system (cylinder, hoses, fittings, seals, etc.) for leaks if fluid level is low.</p> <p>Inspect cylinders, fittings and hydraulic connections for wear, damage or leaks.</p> <p>Inspect outer barrier cylinder hose assembly (hose, fasteners, connections, etc.) for wear, damage or leakage.</p>	<p>Resecure, replace or correct as needed.</p> <p>Use Braun 32840-QT (Exxon® Univis HVI 26) hydraulic fluid (do not mix with Dextron III or other hydraulic fluids). Check fluid level with platform lowered fully and roll stop unfolded fully. Fill to within 1/2" of the bottom of the 1-1/2" fill tube (neck).</p> <p>Tighten, repair or replace if needed.</p> <p>Tighten, repair or replace if needed.</p>

continued

Maintenance and Lubrication Schedule

continued	Perform all procedures listed in previous section also	
4500 Cycles	Inspect parallel arms, bushings and pivot pins for visible wear or damage.	Replace if needed.
	Inspect parallel arm pivot pin mounting bolts (8).	Tighten or replace if needed.
	Inspect platform pivot pin, bushings and vertical arms for wear, damage and positive securement.	Replace defective parts and resecure as needed. Apply Light Grease during reassembly procedures.
	Inspect upper/lower fold arms, rotating pivot slide arms, slide support arms and associated pivot pins, bushings, and bearings for visible wear or damage.	Replace if needed.
	Inspect gas springs (cylinders) for wear or damage, proper operation and positive securement.	Tighten, replace or correct as needed
	Inspect rotating pivot slide arm UHMW slide bearings (buttons).	Apply Door-Ease or replace if needed. See Lubrication Diagram.
	Inspect vertical arm plastic covers.	Resecure or replace if needed.
	Inspect power cable.	Resecure, repair or replace if needed.

Maintenance and Lubrication Schedule

4500 Cycles	Mounting Decals and Antiskid	Check to see that the lift is securely anchored to the vehicle and there are no loose bolts, broken welds, or stress fractures. Replace decals if worn, missing or illegible. Replace antiskid if worn or missing. See Decals and Antiskid section on pages 40-42.
Consecutive 750 Cycle Intervals	Repeat all previously listed inspection, lubrication and maintenance procedures at 750 cycle intervals.	

"Providing Access to the World"®



**Over 300 Braun
Dealers Worldwide**

Braun™ Three-Year Limited Warranty

The Braun Corporation of Winamac, Indiana, warrants that it will repair (or replace at Braun's sole option) any defect in material or workmanship in its wheelchair lift for three years, providing the lift is installed, operated and maintained properly. This warranty is limited to the original purchaser and does not cover defects in the motor vehicle on which it is installed, or defects in the lift caused by a defect in any part of the motor vehicle.

This warranty commences on the date the lift is put in service, providing the warranty registration card is completed and received by The Braun Corporation within 20 days of purchase. If no warranty card is received, the warranty will expire three years from the date of manufacture as identified on the lift serial number tag.

This warranty also covers the cost of labor for the repair (or replacement at Braun's sole option) of parts for one year when performed by an authorized Braun representative. (A labor schedule determines cost allowance for repairs and is available upon request).

This warranty does not cover normal maintenance, service, or periodic adjustments necessitated by use or wear. The Braun Corporation will not, under any circumstances, pay for loss of use, incidental, or consequential damages related to the lift or vehicle in which it is installed.

This warranty will become null and void if the lift has been damaged through accident, misuse, or neglect, or if the lift has been altered in any respect.

All illustrations, descriptions and specifications in this manual are based on the latest product information available at the time of publication. The Braun Corporation reserves the right to make changes at any time without notice.

Free Manuals Download Website

<http://myh66.com>

<http://usermanuals.us>

<http://www.somanuals.com>

<http://www.4manuals.cc>

<http://www.manual-lib.com>

<http://www.404manual.com>

<http://www.luxmanual.com>

<http://aubethermostatmanual.com>

Golf course search by state

<http://golfingnear.com>

Email search by domain

<http://emailbydomain.com>

Auto manuals search

<http://auto.somanuals.com>

TV manuals search

<http://tv.somanuals.com>