

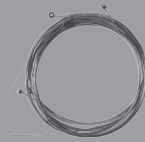

Electric Guitars



Acoustic Guitars



Guitar Strings



Stringwinder



Guitar Stand



Books

Purchase First Act products at your favorite local retail store or online.



Drum Sticks



Lap Harp

MG.M3.06
All rights reserved.
©2008 First Act Inc.
Patents Pending.
D487,627
D496,387, D516,116, and
US Patent Nos. D496,390,
are trademarks of First Act Inc.
First Act and the First Act logo

First Act Inc.
745 Boylston Street
Boston, MA 02116 USA
firstact.com
Phone: 888.551.1115
Email: info@firstact.com



FIRST ACT
ACOUSTIC GUITAR
QUICK START GUIDE

OTHER FIRST ACT® PRODUCTS :



10 & 20 ft. Cables



Auto Tuner

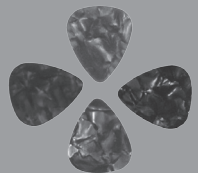

Picks



Guitar Case



Microphone



Drums



Guitar Capo



Guitar Strap

ACOUSTIC GUITAR

QUICK START GUIDE

This guide shows you how to tune and change the strings on your guitar. It will also show you how to check your guitar's action, and how to make adjustments. These things will help you keep your guitar in good working order and provide you with years of enjoyment.

For more on tuning, tips, and tricks visit us online at firstact.com
Happy playing!

TUNING YOUR GUITAR

Standard Tuning:

NOTE	E	A	D	G	B	E
STRING	6	5	4	3	2	1

Here are three ways to tune a guitar:

1. Tune to another instrument:

For example, you can use a piano keyboard to tune. Play the piano keys one at a time, and tune the corresponding guitar string to it.

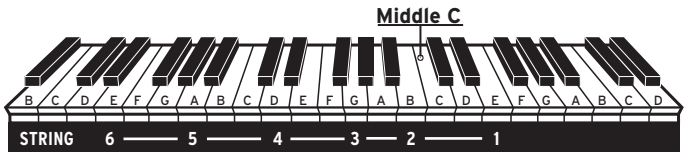

2. Use an electronic tuner

An electronic tuner detects the pitch of each string, and indicates if the pitch is too high or too low.

3. Tune the guitar to itself, this is called relative tuning:

E STRING

First, tune the 6th string to an E on a piano or a keyboard, or any other instrument that is already in tune.

A STRING

Press the 6th string behind the 5th fret and tune the open 5th string to it by turning the 5th tuning key until the two strings sound the same.

D STRING

Press the 5th string behind the 5th fret and tune the open 4th string to it by turning the 4th tuning key.

G STRING

Press the 4th string behind the 5th fret and tune the open 3rd string to it by turning the 4th tuning key.

B STRING

Press the 3rd string behind the 4th fret and tune the open 2nd string to it by turning the 2nd tuning key.

E STRING

Press the 2nd string behind the 5th fret and tune the open 1st string to it by turning the 1st tuning key.

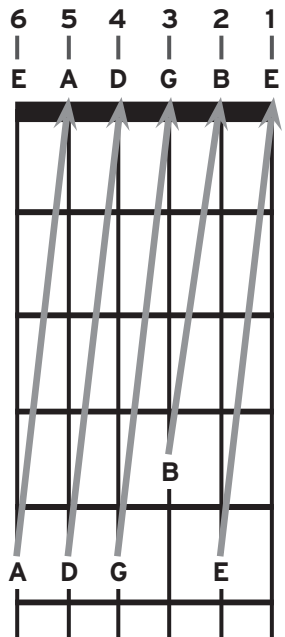

CHANGING STRINGS

Strings should be replaced when they become dirty, discolored, or produce a dull sound. Change one string at a time to maintain the string tension on the neck. You can change acoustic guitar strings in five easy steps:

1 Loosen the string by turning the tuning peg.

FOR BRIDGES WITH PINS

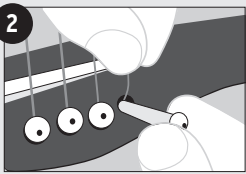

Remove the bridge pin. Pull the ball end of the string out of the hole, unwind the string from the string post, and remove it from the guitar.

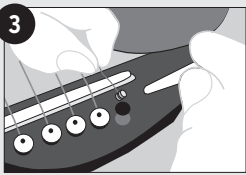

Stick the ball end of the new string into the hole. Push the pin in place and pull up on the string until the ball catches under the bridge. Press down on the pin until it is secure.

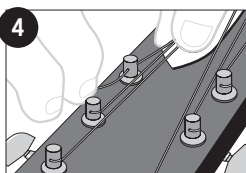

Feed the end of the string through the hole in the tuning peg. Leave some slack so the string will wind around the post a few times.

FOR BRIDGES WITHOUT PINS

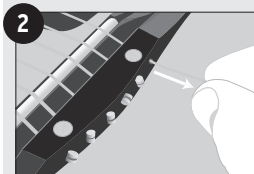

Unwind the string from the string post and remove it from the guitar.

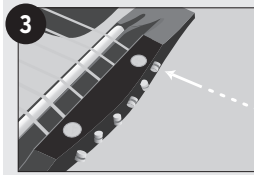

Thread the new string through the hole in the bridge. Pull the string through until the ball catches at the bridge.

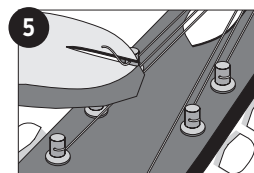

Bend the end of the string and tighten it by turning the tuning peg. Carefully trim the excess string with wire cutters.

FOR MORE ON TUNING & RESTRINGING, VISIT FIRSTACT.COM

TRUSS ROD ADJUSTMENTS

Some guitars have a truss rod. This is a device installed in the neck of the guitar to stabilize and control the straightness of the neck and to support it against the tension of the strings.

Bow: A neck with a "bow" in the middle will cause bad action and impair intonation. The truss rod can be tightened to eliminate a bowed neck. (To tighten the truss rod, turn clockwise.)



Hump: A neck with a "hump" in the middle will cause string rattle and false tones. The truss rod can be loosened to eliminate a hump in the neck. (To loosen the truss rod, turn counter-clockwise.)



It's best to have a professional repairperson adjust your guitar's truss rod. If you're doing it yourself, **be very careful**. Too much of a turn can damage the neck of your guitar.

If you are familiar with making adjustments yourself, you can locate the truss rod at the end of the neck, just above the nut of the guitar. Loosen the 3rd and 4th strings to access the truss rod.

Adjustments should only be made to the truss rod in very small increments. Start with less than a quarter of a turn. It's helpful to mark your truss rod so you can monitor your progress or return it to its original position.

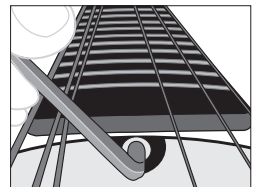

ADJUSTING THE ACTION

The "action" of a guitar refers to its playability – i.e. the height of the strings above the frets. On acoustic guitars, the action is determined by the saddle, which is inserted into the bridge. The saddle can be lowered by filing it down.

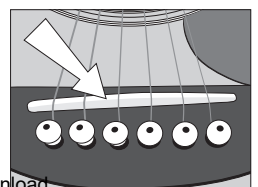

Visit firstact.com for guitar tips and tricks, tuning and stringing instructions, guitar chord charts, and more!

Free Manuals Download Website

<http://myh66.com>

<http://usermanuals.us>

<http://www.somanuals.com>

<http://www.4manuals.cc>

<http://www.manual-lib.com>

<http://www.404manual.com>

<http://www.luxmanual.com>

<http://aubethermostatmanual.com>

Golf course search by state

<http://golfingnear.com>

Email search by domain

<http://emailbydomain.com>

Auto manuals search

<http://auto.somanuals.com>

TV manuals search

<http://tv.somanuals.com>