

WP 700 S Art. 7851  
WP 1500 S Art. 7857

**D Gebrauchsanweisung**  
Solar-Wasserspielpumpen-Set

---

**GB Operating Instructions**  
Solar-Powered Fountain Pump Set

---

**F Mode d'emploi**  
Pompe solaire pour jets d'eau

---

**NL Gebruiksaanwijzing**  
Waterspelpompset Solar

---

**S Bruksanvisning**  
Fontän Pump Set med solcellsdrift

---

**I Istruzioni per l'uso**  
Pompa a energia solare per giochi d'acqua

---

**E Manual de instrucciones**  
Set de bomba solar para juegos de agua

---

**DK Brugsanvisning**  
Solcelledrevet Springvandspumpe Sæt

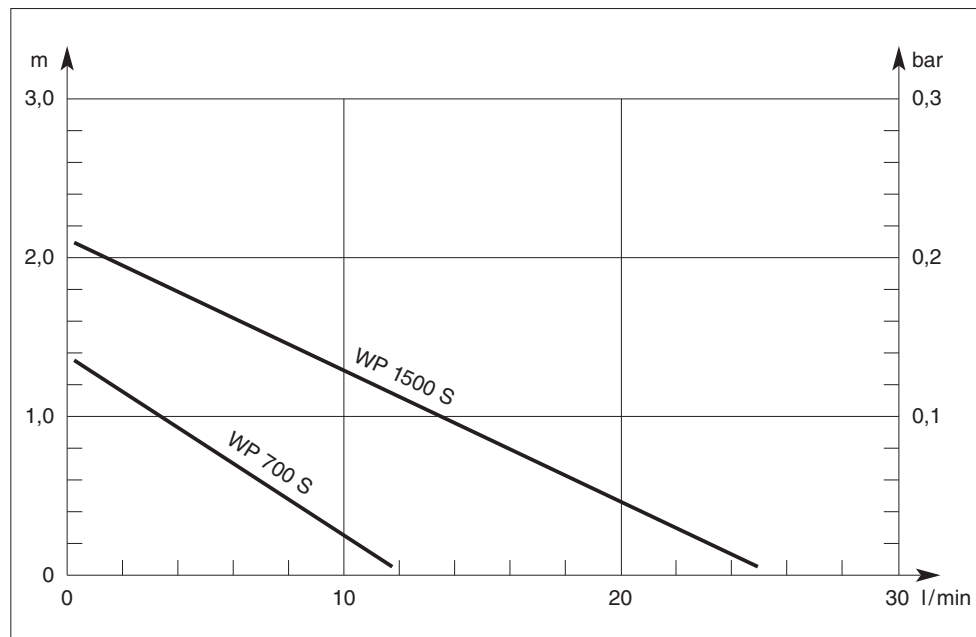

**D**

Bitte lesen Sie diese  
Gebrauchsanweisung  
vor Inbetriebnahme  
Ihres Gerätes sorgfältig.

Gebrauchsanweisung Seite  
3 - 10

**GB**

Please read these operating  
instructions carefully before  
using the unit.

Operating instructions Page  
11 - 17

**F**

Nous vous remercions de  
bien vouloir lire attentive-  
ment ce mode d'emploi  
avant l'utilisation de votre  
pompe.

Mode d'emploi Page  
18 - 24

**NL**

Lees deze gebruiksaanwij-  
zing voor ingebruikname  
van het apparaat zorgvuldig  
door.

Gebruiksaanwijzing Pagina  
25 - 31

**S**

Läs igenom bruksanvisnin-  
gen noggrant innan Du tar  
Din GARDENA Pump i bruk.

Bruksanvisning Sida  
32 - 37

**I**

Prima di mettere in uso  
la nuova pompa, leggere  
attentamente le istruzioni.

Istruzioni per l'uso pagina  
38 - 44

**E**

Antes de la puesta en  
marcha del aparato, acon-  
sejamos una atenta lectura  
del presente manual de  
instrucciones.

Manual de  
instrucciones Página  
45 - 51

**DK**

Læs venligst brugsanvis-  
ningen omhyggeligt igen-  
nem.

Brugsanvisning Side  
52 - 58

# GARDENA Solar-Powered Fountain Pump Set

## WP 700 S / WP 1500 S

Welcome to GARDENA aquamation ...



Please read these operating instructions carefully and observe the notes given.  
Use the instructions to familiarise yourself with the equipment, the operating controls, their correct use, and the notes on safety.

For safety reasons, children under 16 as well as persons not familiar with these operating instructions should not use this pump.

Keep these operating instructions in a safe place.

## The Applications Range of Your Pump

### *Intended purpose*

GARDENA Fountain Pumps have been designed for private use. They are not designed for operating watering tools and systems.

### *Attention*

⚠ GARDENA Fountain Pumps have not been designed for constant use in the industrial sector.  
Corrosive, easily combustible, aggressive or explosive substances (e.g. petrol, petroleum, nitro thinner) as well as salt-water or food / drinking water must not be pumped.



## For Your Safety

### *Visual check*

Before operating the pump, look to see if there is any damage of the pump. A damaged pump must not be used. In case of damage, please have the pump checked by our GARDENA Service Centre or by an authorised electrician.

### *Do not use power cable to carry the pump*

Do not use the power cable to carry the pump or to pull the plug out of the socket. Protect the power cable from heat, oil and sharp edges.

### *Temperature of the liquid used*

The temperature of the liquid used must not be below 4 °C or above 35 °C.

### *Wear and reduced output*

Sand and other abrasive substances in the liquid cause increased wear and reduce the output of the pump.

### *Caution! Low voltage*

GARDENA pumps and plug connections have been designed exclusively for the use with low voltage. When connected to 230 V your life is at risk! Use the solar panel only to operate the GARDENA Fountain Pump WP 700 S or WP 1500 S.

### *Observe local noise prevention regulations*

Please observe the local noise prevention regulations.

## Applications: Examples – System Extensions – Product Recommendations

**Water jets for  
26,5 mm (G 3/4) thread  
connections**

→ Example for application:  
**Water jets may be integrated into water features.**

Model	Art. No.	Cascade	Water Bell	Foaming Jet Spray	Water Fleur-de-Lis	Water-fall	Cascade Rotating
		7814*	7816	7818	7820	7822	7823
WP 700 S	7851	×	×	—	—	×	×
WP 1500 S	7857	×	×	×	—	×	×

\* contained in delivery volume

### Pond aeration

→ Example for application:  
**To aerate the pond.**

→ Product:  
GARDENA Pond Aerator Art. No. 7936

### Filling the filter tank with zeolith

Zeolith fulfils the following functions:

- Filters the water (→ protection for the pump).
- Bonds with excessive nutrients and causes their decomposition by bacteria (→ Ion exchange and the bonding of e.g. nitrate).
- Helps to keep the pond clean and maintain the biological balance.
- Provides stability for the pump

GARDENA Zeolith, 1 l Art. No. 7914  
GARDENA Zeolith, 5 l Art. No. 7915

#### Note:

To ensure the zeolith functions correctly, we recommend you replace or clean it every 6 months (e.g. in salt water).

### Information

- Always unplug the pump first before working on it.
- Before assembling system extensions first unscrew the pre-assembled cascade and if necessary also the telescopic tube of the pump and then screw one of the water jets on again (→ the ball-and-socket joint ensures that the water jet is vertical.)
- Follow the Safety and Assembly Information attached to the operating instructions.

## Operation

### Installing the pump

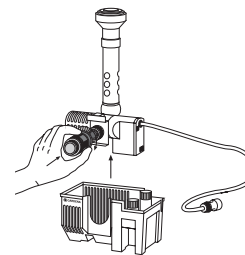

1. Remove the pump from the filter basket and screw the regulator supplied onto the second opening of the pump up to the limit stop (→ max. delivery capacity on the vertical outlet). Then replace the pump in the filter basket.
2. Put the pump on a stable base to ensure that the upper edge of the filter tank is completely immersed in water.

### Caution: Submersion depth

Please note the maximum submersion depth (see "Technical Data").

### Assembling the solar panel

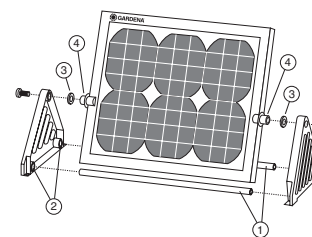

Insert both aluminium poles ① into the holes in the side sections ②. Place one of the O-rings ③ on each of the swivel pins ④ of the solar panel ⑤ then screw both side sections to the solar panel.

**Important:** when tightening the screws, ensure that you do not screw them too tight to ensure that the solar panel can still be easily adjusted.

### Positioning the solar panel

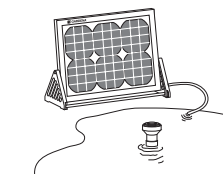

Position the solar panel in such a way that it will be exposed to direct sunlight. No shadow should be cast on it. The ideal positioning angle is 30° from the vertical.

⚠ The solar panel must not be positioned near easily flammable substances.

After adjusting tighten the screws firmly.

### Permanent installation of the solar panel

- The solar panel can be permanently installed in an outdoor area. For this purpose you should attach the appliance to a wall, e.g. with wooden bolts.
- For permanent installation of the appliance you should ensure that it is exposed to maximum solar radiation.
- The special glazing of the solar panel ensures complete protection against hailstones and other adverse weather conditions.

### Starting the pump

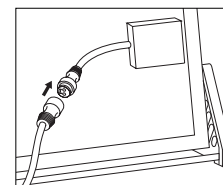

Connect the power cable of the pump to the socket of the solar panel.

The pump will start as soon as enough energy has been generated from solar radiation in the solar panel.

**Avoid dry operation**

Avoid dry operation of the pump as dry running will produce undesirable heat and destroy the pump.

**Horizontal or second outlet**

- Loosen the regulator by turning it anti-clockwise until you achieve the desired water flow from the vertical pipe of the fountain/water feature.
- You may connect other terminals to the second outlet. For example, a separately installed water jet may be operated via the GARDENA Fountain/Light Bracket, Art. No. 7886. If necessary fix the bracket with two screws.

**Information:**

This significantly reduces the volume of the vertical water jet.

- If the max. delivery capacity of the second outlet is to be used then the vertical outlet should be closed with the end cap supplied.
- Example: **Hose pipe connection with the GARDENA Fountain/Light Bracket**  
We recommend the use of a 3/4" (19 mm) GARDENA Pond Hose Pipe, Art. No. 7895, connected to with the GARDENA "Profi" Maxi-Flow-System with Tap Connector (Art. No. 2801 and 2802) and the GARDENA "Profi" Maxi-Flow-System Hose Connectors (Art. No. 2817).

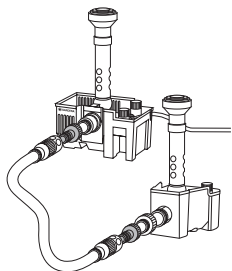
**Care Instructions****Cleaning the filter tank**

Filter tank and pump should be free from dirt particles!

**How to clean:**

- Disconnect the plug from the solar panel!
- Remove the pump from the water.
- If necessary remove the gravel.
- Clean the pump and the filter using a water jet.
- If there are deposits of dirt inside the pump then dismantle the casing (→ see "Dismantling") and carefully clean the interior fittings with water.

**Information:** Do not use any hard objects or strong detergents!

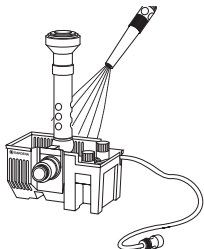
**Blocked feed impeller**

If the feed impeller becomes blocked, the pump and the filter should be cleaned (see above).

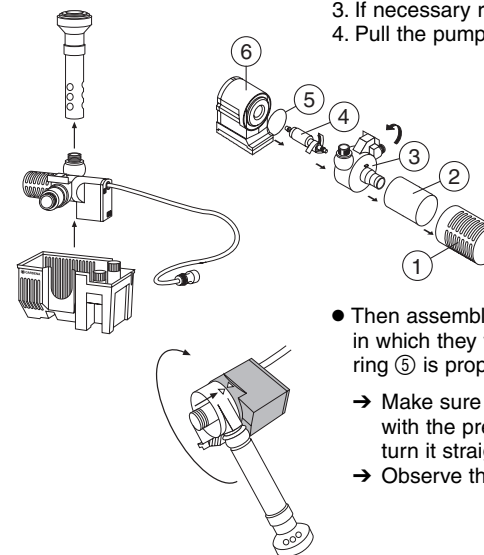
**Dismantling**

1. Disconnect the plug from the solar panel!
2. Remove the pump from the water.
3. If necessary remove the gravel.
4. Pull the pump pointing vertically upwards out of the filter tank.
5. Pull the suction filter casing ① forwards and remove it.
6. Remove the foam filter ② from the suction piece of the pump.
7. Turn the pump casing ③ to the left to the limit stop and then pull it straight towards the front and remove it! Do not tilt!
8. Pull the feed impeller ④ out of the motor casing ⑥.

- Then assemble all the fittings reversing the order and direction in which they were dismantled. Please take care that the seal ring ⑤ is properly re-fitted.
  - Make sure while assembling that you attach the pump casing with the pressure joint being cated, press it firmly and then turn it straight to the right.
  - Observe the markings.

**Storage****Where to store**

**⚠ The pump should be stored out of the reach of children.**

1. Remove the pump from the pond and store away from frost before the first frost sets in.
2. Clean and check the pump carefully.
3. Store the pump in a container filled with water.  
*The mains plug must not be submerged.*

**Information****Complaints/Repairs**

If you have any problems with your Fountain Pump, please contact our Service or return the defective unit together with a short description of the problem – in case of guarantee, with the warranty card duly completed and signed – postage paid to one of the GARDENA Service Centres listed on the back of this leaflet.

**Product liability**

We expressly point out that, in accordance with the product liability law, we are not liable for any damage caused by our units if it is due to improper repair or if parts exchanged are not original GARDENA parts or parts approved by us, and, if the repairs were not carried out by a GARDENA Service Centre or an authorised specialist. The same applies to spare parts and accessories.

## Technical Data

Type	WP 700 S	WP 1500 S
Art. No.	7851	7857
Rated power	8 W	17 W
Flow	12 l/min	25 l/min
Max. delivery head	1.4 m	2.1 m
Max. submersion depth	1.0 m	2.0 m
Connection cable	12 V DC	12 V DC
Fitting	26.5 mm (G 3/4) male thread	26.5 mm (G 3/4) male thread
Max. media temperature	35 °C	35 °C
Mains voltage	12 - 24 V DC	12 - 24 V DC
Noise level $L_{WA}$ <sup>1)</sup>	48 dB(A)	48 dB(A)
<b>Solar panel</b>		
Solar cells	monocrystalline silicium cells	monocrystalline silicium cells
Cover	shock-resistant compound glass	shock-resistant compound glass
Power	10 W at 16.6 V/0.6 A	10 W at 16.6 V/0.6 A

1) Measuring method according to EN 60335-1

## EU Certificate of Conformity

The undersigned

GARDENA Kress + Kastner GmbH · Hans-Lorenser-Str. 40 · D-89079 Ulm

hereby certifies that, when leaving our factory, the units indicated below are in accordance with the harmonised EU guidelines, EU standards of safety and product specific standards.

This certificate becomes void if the units are modified without our approval.

<b>Description of the units:</b> Solar-Powered Fountain Pumps	<b>EU directives:</b> Machinery Directive 98/37/EC Directive 93/68/EC	<b>Year of CE marking:</b> 1999
<b>Type:</b> WP 700 S / WP 1500 S	<b>Harmonised European standards:</b> EN 292-1 EN 292-2 EN 60335-1 EN 60335-2-41	Ulm, 01.06.1999  Thomas Heintl Technical Dept. Manager

## Guarantee

GARDENA guarantees this product for 3 years (from date of purchase). This guarantee covers all serious defects of the unit that can be proved to be material or manufacturing faults. Under warranty we will either replace the unit or repair it free of charge if the following conditions apply:



- The unit must have been handled properly and in keeping with the require-

ments of the operating instructions. Neither the purchaser nor a non-authorized third party have attempted to repair the unit.

Parts subject to wear (e.g. feed impeller) are excluded from this guarantee.

This manufacturer's guarantee does not affect the user's existing warranty claims against the dealer/seller.

In the event of a fault, please send the defective unit together with the receipt and a description of the fault, postage paid, to one of the GARDENA Service Centres on the back of this page.

<b>Garantiekarte</b>	Solar-Wasserspielpumpen-Set	<b>WP 700 S</b> 
<b>Warranty Card</b>	Solar-Powered Fountain Pump Set	
<b>Bon de garantie</b>	Pompe solaire pour jets d'eau	<b>WP 1500 S</b> 
<b>Garantiekaart</b>	Waterspelpompset Solar	
<b>Garantikort</b>	Fontän Pump Set med solcellsdrift	
<b>Certificato di garanzia</b>	Pompa a energia solare per giochi d'acqua	
<b>Tarjeta de garantía</b>	Set de bomba solar para juegos de agua	
<b>Garantibevis</b>	Solcelledrevet Springvandspumpe Sæt	

Wurde gekauft am:	Händlerstempel
Was purchased on:	Dealer's stamp / Receipt
Achetée le (date et lieu d'achat) :	Cachet du revendeur
Werd gekocht op:	Stempel van de handelaar
Försäljningsdatum:	Återförsäljarens stämpel
Data di acquisto:	Timbro del rivenditore
Fecha de compra:	Sello del comerciante
Købsdato:	Firmastempel

Beanstandung:  
 Reasons for complaint:  
 Défaut constaté :  
 Klacht:  
 Reklamation:  
 Reclamo:  
 Reclamación:  
 Reklamation:



**Deutschland**

GARDENA Kress + Kastner GmbH  
GARDENA Service  
Hans-Lorensen-Straße 40  
D-89079 Ulm  
Produktfragen: (07 31) 490-123  
Reparaturen: (07 31) 490-290

**Argentina**

Argensem S.A.  
Venezuela 1075  
(1618) El Talar - Buenos Aires

**Australia**

NYLEX Corporation Ltd.  
25-29 Nepean Highway  
P.O. Box 68  
Mentone, Victoria 3194

**Austria**

GARDENA Österreich Ges. m.b.H.  
Stettnerweg 11-15  
2100 Korneuburg

**Belgium**

MARKT (Belgium) NV/SA  
Sterrebeekstraat 163  
1930 Zaventem

**Brazil**

M. Cassab  
Av. das Nações Unidas, 20.882  
Santo Amaro, CEP 04795-000  
São Paulo - S.P.

**Bulgaria / България**

ДЕНЕКС ООД  
бул. „Черни връх“ 43  
София 1407

**Canada**

GARDENA Canada Ltd.  
100, Summerlea Road  
Brampton, Ontario  
Canada L6T 4X3

**Chile**

Antonio Martinic Y CIA. LTDA.  
Gilberto Fuenzalida 185 Loc.  
Las Condes - Santiago de Chile

**Costa Rica**

Compania Exim  
Euroiberoamericana S.A.  
350 Sur del Automercado  
Los Yoses  
San Pedro

**Cyprus**

FARMOKIPIKI LTD  
P.O. Box 7098  
74, Digeni Akrita Ave.  
1641 Nicosia

**Czech Republic**

GARDENA spol. s.r.o.  
Ripská 20  
62700 Brno

**Denmark**

GARDENA Danmark A/S  
Naverland 8  
2600 Glostrup

**Finland**

Habitec Oy  
Martinkyläntie 52  
01720 Vantaa

**France**

GARDENA France  
Service Après-Vente  
BP 50080  
95948 ROISSY CDG Cedex

**Great Britain**

GARDENA UK Ltd.  
27-28 Brenkley Way  
Blezard Business Park  
Seaton Burn  
Newcastle upon Tyne  
NE13 6DS

**Greece**

Agrokip G. Psomadopoulos & Co.  
20, Lykourgou str.  
Kallithea - Athens

**Hungary**

GARDENA Magyarország Kft.  
Késmárk utca 22  
1158 Budapest

**Iceland**

Heimilistaeki hf  
Saetun 8  
P.O. Box 5340  
125 Reykjavik

**Republic of Ireland**

Michael McLoughlin & Sons  
Hardware Limited  
Long Mile Road  
Dublin 12

**Italy**

GARDENA Italia S.r.l.  
Via Donizetti 22  
20020 Lainate (Mi)

**Japan**

KAKUDAI Mfg. Co. Ltd.  
1-4-4, Itachibori Nishi-ku  
Osaka 550

**Luxembourg**

Magasins Jules Neuberg  
Grand Rue 30  
Case Postale No. 12  
Luxembourg 2010

**Netherlands**

MARKT (Holland) BV  
Postbus 219  
1380 AE Weesp

**Neth. Antilles**

Jonka Enterprises N.V.  
Sta. Rosa Weg 196  
P.O. Box 8200  
Curaçao

**New Zealand**

NYLEX New Zealand Limited  
Private Bag 94001  
South Auckland Mail Centre  
10 Offenhauser Drive  
East Tamaki, Manukau

**Norway**

GARDENA Norge A/S  
Postboks 214  
2013 Skjetten

**Poland**

GARDENA Polska Sp. z o.o.  
Szymanów 9 d  
05-532 Baniocza

**Portugal**

MARKT (Portugal), Lda.  
Recta da Granja do Marquês  
Edif. GARDENA  
Algueirão  
2725-596 Mem Martins

**Russia / Россия**

АО АМИДА ТТЦ  
ул. Мосфильмовская 66  
117330 Москва

**Singapore**

Variware  
Holland Road Shopping Centre  
227-A 1st Fl., Unit 29  
Holland Avenue  
Singapore 1027

**Slowenia / Croatia**

Silk d.o.o. Trgovina  
Brodišče 15  
1236 Trzin

**South Africa**

GARDENA South Africa (Pty.) Ltd.  
P.O. Box 11534  
Vorna Valley 1686

**Spain**

ANMI Andreu y Miriam S.A.  
Calle Pere IV, 111  
08018 Barcelona

**Sweden**

GARDENA Svenska AB  
Box 9003  
20039 Malmö

**Switzerland**

GARDENA Kress + Kastner AG  
Bitziberg 1  
8184 Bachenbülach

**Ukraine / Украина**

АОЗТ АЛЬЦЕСТ  
ул. Гайдара 50  
г. Киев 01033

**Turkey**

Dost Diş Ticaret Mümesillik A.Ş.  
Yeşilbağlar Mah. Başkent  
Cad. No. 26  
Pendik - İstanbul

**USA**

GARDENA  
3085 Shawnee Drive  
Winchester, VA 22604

7851-20.960.05/0001  
GARDENA Kress + Kastner GmbH  
Postfach 27 47, D-89070 Ulm  
<http://www.gardena.de>



## Free Manuals Download Website

<http://myh66.com>

<http://usermanuals.us>

<http://www.somanuals.com>

<http://www.4manuals.cc>

<http://www.manual-lib.com>

<http://www.404manual.com>

<http://www.luxmanual.com>

<http://aubethermostatmanual.com>

Golf course search by state

<http://golfingnear.com>

Email search by domain

<http://emailbydomain.com>

Auto manuals search

<http://auto.somanuals.com>

TV manuals search

<http://tv.somanuals.com>