

iHome®

Model iH24
The Portable System
For Your iPod®

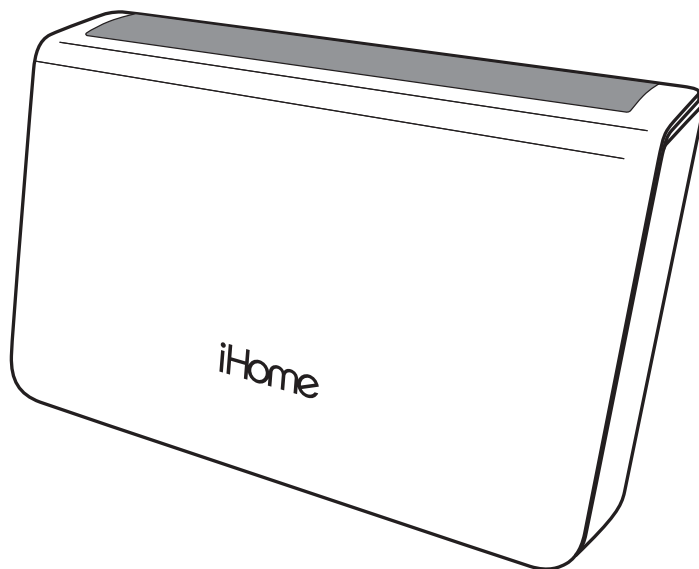

THIS UNIT WILL NOT CONTROL OR CHARGE 3G iPod

Questions? Visit www.ihomeaudio.com

Download from www.Somanuals.com. All Manuals Search And Download.

Table of Contents

Quick Start	1
Controls and Indicators / iH24 Display	2
Using the iH24	3-4
Replacing iH24 Backup Batteries	5
Install/Replace Batteries for Portable Use	5
Using The Remote Control Unit	6
A Consumer Guide to Product Safety	7
Troubleshooting	8-9
Warranty Information	10

Maintenance

Maintenance

- Place the unit on a level surface away from sources of direct sunlight or excessive heat.
- Protect your furniture when placing your unit on a natural wood and lacquered finish. A cloth or other protective material should be placed between it and the furniture.
- Clean your unit with a soft cloth moistened only with mild soap and water. Stronger cleaning agents, such as Benzine, thinner or similar materials can damage the surface of the unit.

FCC Information

This device complies with Part 15 of the FCC Rules, operation is subject to the following two conditions: (1) This device may not cause harmful interference, and (2) this device must accept any interference received, including interference that may cause undesired operation.

This equipment complies with the limits for a Class B digital device as specified in Part 15 of FCC Rules. These limits provide reasonable protection against radio and TV interference in a residential area.

However, your equipment might cause TV or radio interference even when it is operating properly. To eliminate interference you can try one or more of the following corrective measures:

- Reorient or relocate the receiving antenna.
- Increase the distance between the equipment and the radio or TV.
- Use outlets on different electrical circuits for the equipment and the radio or TV.
- Consult your dealer or an experienced radio/television technician if the problem still exists.

Modifying or tampering with your system's internal components can cause a malfunction and might invalidate the system's warranty and void your FCC authorization to operate it.

This Class B digital apparatus complies with Canadian ICES-003.

Cet appareil numérique de la classe B est conforme à la norme NMB-003 du Canada.
Download from www.Somanuals.com. All Manuals Search And Download.

iH24 Quick start

1: AC power

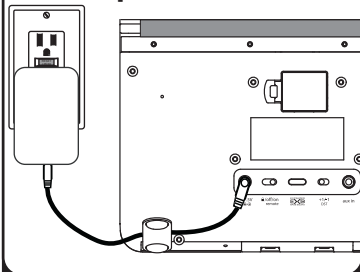

Connect AC adaptor cable to jack on back of the iH24 and plug the other end into a wall socket to play and charge iPod.

2: batteries

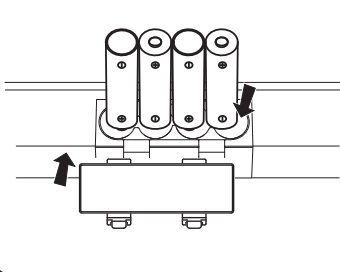

For portable operation, open battery compartment on the bottom of the unit. Insert 4 "AA" (LR) batteries as indicated.

3: Stand Feet

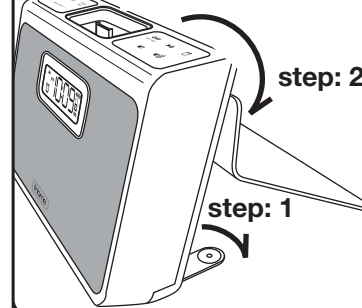

Fold out the support stand feet located on the bottom of the unit

Use this insert

thin iPod with video (30 GB)
Insert 9

iPod touch 2G
insert 16

iPod nano 4G
insert 17

For this iPod

thin (30 GB) iPod with video
thin (80GB) iPod classic

iPod Touch 2G

iPod nano 4G

4: inserts

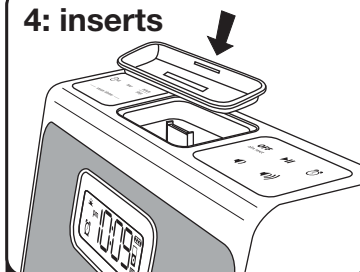

Select the dock insert for your iPod® model from the table below and place insert in dock.

Never dock an iPod without the proper insert in place.

5: iPod

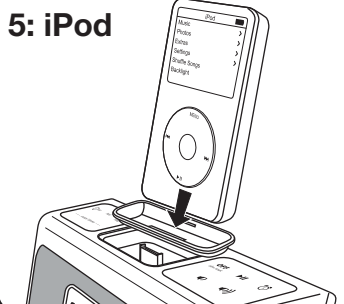

Insert iPod® into dock (iPod must not be in a "skin" or case). When connected to AC power, iPod will charge while docked. Press the iPod/play Button on the iH24 to play your iPod.

NOTE: If you do not have an insert for your iPod, please visit www.ihomeaudio.com or call iHome toll free at 800-288-2792 to purchase one.

Controls and Indicators

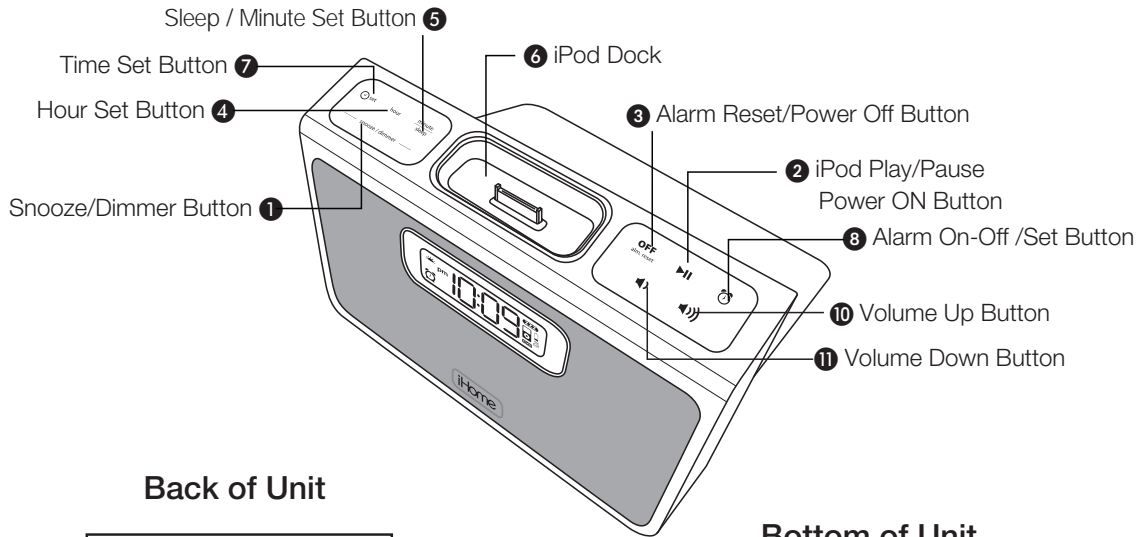

Back of Unit

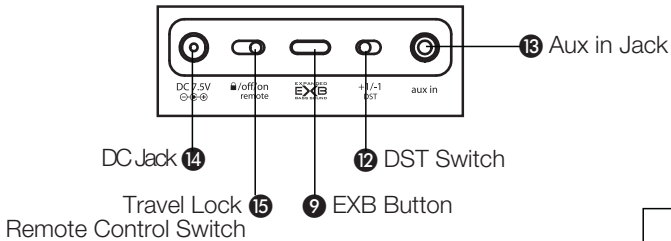

Bottom of Unit

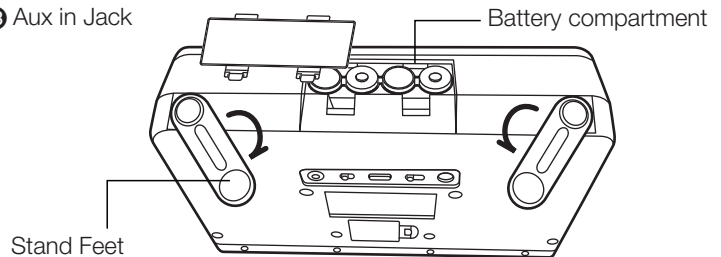

iH24 Display

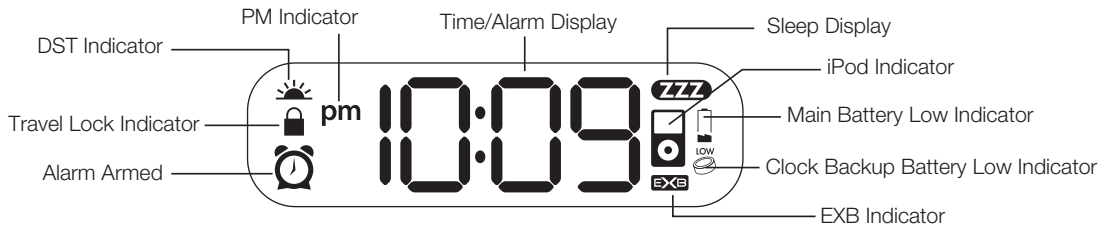

Connect iH24 to Power Source

- a) Plug the AC adaptor cable into the AC Adaptor Jack and the other end into a standard 120v wall socket. Adaptor must be plugged in to charge iPod.
- b) For portable operation, install 4 "AA" (LR) batteries in battery compartment on the bottom of the unit. Make sure polarity matches diagram in compartments. **Note:** Unit will not charge iPod while operating on batteries.

Setting the Clock

- a) Depending on your location and the time of year, move the **DST** (Daylight Saving Time) **switch** on the back of the unit to +1 to add one hour (a DST icon ☀️ will appear on the display) or to -1 to subtract 1 hour.
- b) Press and hold the **Time Set Button** ⌚ until the display flashes. Press the Alarm Set Button to toggle between 24 hour (military) and 12 hour (standard) time display modes.
- c) Press the **Hour Set Button** to adjust the hour display (a PM indicator appears when time is set to PM; there is no AM indicator)
- d) Press the **Minute Set Button** to adjust the minute display. Hold to advance rapidly. When the correct time is displayed, press the **Time Set button** ⌚ again. Two beeps will indicate clock setting is complete.

Using the Alarm

Setting the Alarm

- a) Press and hold the **Alarm Set Button** ⌚ until the alarm time flashes to wake to iPod (buzzer alarm sounds if no iPod is detected).
- b) Press the **Hour Set Button** to set the desired alarm hour (a PM indicator appears when time is set to PM; there is no AM indicator)
- c) Press the **Minute Set Button** to set the alarm minute time. When the desired alarm time is displayed, press the **Alarm Set Button** ⌚ again. Two beeps will indicate alarm setting is complete. Alarm is now armed, indicated by the alarm clock icon.

Arming and Disarming Alarm (Turn Alarm Function ON and OFF)

- a) Press the **Alarm On/Off Button** to arm or disarm alarm functions. When armed, the alarm icon appears in the display.

Resetting the Alarm to Come on the Next Day

- a) When the alarm is sounding, press the **Alarm Reset/Power Off Button** to stop the alarm and reset it to come on the following day.
Snooze
- a) Press the **Snooze/Dimmer Button** after the alarm sounds. The alarm will be silenced and come on again 9 minutes later. Snooze can be pressed several times during the 1 hour alarm cycle.

Sure Alarm



The iH24 has a sure alarm feature so the buzzer alarm will still sound in the event of power failure, if backup battery is installed.

iPod

Playing and charging your iPod

- a) After selecting and placing the proper insert for your iPod model, gently dock iPod in Dock. When docked, iPod will charge until fully charged when the iH24 is connected to an outlet with AC adaptor. **Unit will not overcharge iPod.**
- b) Press the **iPod Play Button** ▶|| to play iPod, and again to pause.
- c) Press **Volume UP** (⏮) or **DOWN** (⏭) buttons to adjust iH24 volume up or down.
- e) Press **Alarm Reset/Power Off Button** to turn iH24 and iPod off.

Using Sleep Mode

- Press the **Sleep Button** while the iPod is playing to enter sleep mode, and continue to press to step through the available sleep times: 90, 60, 30 or 15 minutes. The sleep mode icon  will appear on the display. The iH24 will play for the number of minutes set, growing gradually softer until shutting off both the unit and the iPod at the set time. Press the **Volume Up**  or **Down**  controls to set your own sleep volume. Sleep volume setting is separate from your alarm or regular listening volume selection.



Using the Aux in Jack

- Use an audio patch cord (available at www.ihomeaudio.com) to play nondocking iPod models or other audio devices through the iH24 **Aux in Jack** (one end in the device's line out or headphones jack, the other in the iH24 Aux in jack). Make sure there is no iPod docked in the iH24 when using the Aux in jack. Press the  **iPod Play Button**.



Using Dimmer

- Press the **Snooze/Dimmer Button** during normal operation to adjust the brightness of LCD display. While operating on AC current, the switch will toggle between high, medium, low and off settings. In battery mode, the display is off by default. Press once to activate the display for about 3 seconds.

Using the Travel Lock

- You can disable the iH24 controls to avoid turning on the device or changing settings while in transit and to save battery life during extended periods of non-use. To do so, move the **Travel Lock Switch**  (located on the back of the unit) to the Locked icon position. A **Lock Icon**  will appear on the display indicating the unit is locked and controls are inactive. Move the switch to the **Remote** position to restore normal function with remote control capability, or to the **Off** position to restore function with the remote disabled.

Using the EXB Button

- Press the **EXB Button**  located on the back panel of the unit to enable the EXB sound enhancement circuitry. This circuitry is designed to provide a broader audio image with enhanced low range and mid range sound reproduction to bring added life to compressed MP3 files. The EXB icon  will appear in the display when EXB is active. Press button again to disable the EXB effect.

Replacing iH24 Backup Battery

Install/Replace Backup Battery

The iH24 uses a backup battery system to provide continuous alarm operation and clock settings in the event of a power failure. If the Backup Battery Low Icon located on the right of the display is flashing, it is time to replace the backup batteries. Please make sure the AC adaptor is connected, otherwise all settings may be lost during battery replacement.

Open the battery compartment cover located on the back of the unit.

Insert 1 "CR2032" battery with the + facing out. Replace battery compartment cover.

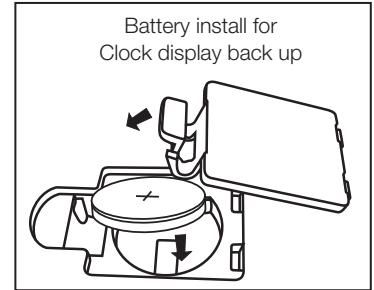

Install/Replace Batteries for Portable Use

The iH24 uses 4 "AA" batteries for portable playing. If sound becomes weak or distorted while operating on batteries, it's time to replace the batteries. The iH24 will not charge iPod while operating on batteries.

- Open the battery compartment cover located on the bottom of the unit.
- Insert 4 AA (LR) batteries in the compartment as indicated, making sure the polarity (+ and -) matches the diagram.
- Replace battery compartment cover.

Batteries information:

- Do not mix old and new batteries.
- Do not mix alkaline, standard (carbon -zinc) or rechargeable (nickel-cadmium) batteries.

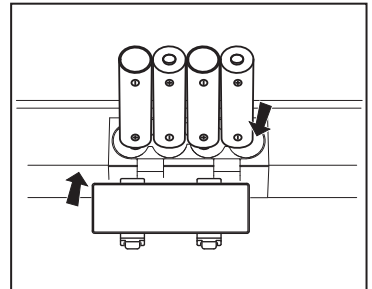

Using The Optional Remote Control Unit

Install/Replace the Remote Control Battery (for models with remote control)

To order a remote control, visit www.ihomeaudio.com

The remote control battery is already installed at the factory. When the remote control stops operating or its range seems reduced, replace the battery with a new one.

1. The battery door is located on the back end of the unit.
2. Slide the battery door to release the battery door latch and remove the battery door.
3. Insert a "CR2032" 3-volt lithium battery. Make sure the polarity (the + and - side of the battery) is correct.
4. Replace the battery compartment door back in the remote control.

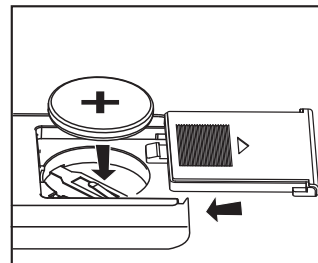

NOTE: PLEASE DISCARD BATTERIES PROPERLY

Operating the remote control

The Remote Control controls basic functions on the iH24 and certain iPod® functions when the iPod® is docked in the iH24. For best results, aim remote control towards the remote sensor by the lower right corner of the display.

Move the **Travel Lock Switch**  to **Remote** position to enable the remote control.

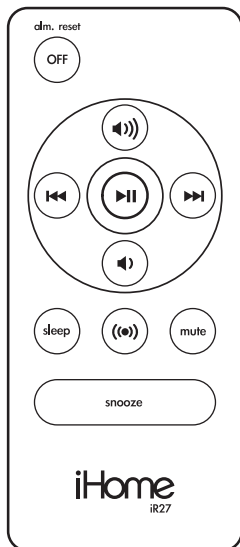

alm. reset



Turns iH24 OFF or resets alarm when alarm is sounding



Volume Buttons raise and lower volume on the unit.



Skip to previous or next track when iPod is playing, or hold to scan current playing track.



Selects iPhone/iPod and plays track. In play mode, press to pause



Selects Sleep Time function



Turn EXB sound enhancement ON or OFF



Toggles sound ON or OFF



Snooze mode when alarm sounds, otherwise dims display

IMPORTANT SAFETY INSTRUCTIONS

When used in the directed manner, this unit has been designed and manufactured to ensure your personal safety. However, improper use can result in potential electrical shock or fire hazards. Please read all safety and operating instructions carefully before installation and use, and keep these instructions handy for future reference. Take special note of all warnings listed in these instructions and on the unit.

1. **Water and Moisture** – The unit should not be used near water. For example: near a bathtub, washbowl, kitchen sink, laundry tub, swimming pool or in a wet basement.
2. **Ventilation** – The unit should be situated so that its location or position does not interfere with its proper ventilation. For example, it should not be situated on a bed, sofa, rug or similar surface that may block ventilation openings. Also, it should not be placed in a built-in installation, such as a bookcase or cabinet, which may impede the flow of air through the ventilation openings.
3. **Heat** – The unit should be situated away from heat sources such as radiators, heat registers, stoves or other appliances (including amplifiers) that produce heat.
4. **Power Sources** – The unit should be connected to a power supply only of the type described in the operating instructions or as marked on the appliance.
5. **Power-Cable Protection** – Power supply cables should be routed so that they are not likely to be walked on or pinched by items placed upon or against them. It is always best to have a clear area from where the cable exits the unit to where it is plugged into an AC socket.
6. **Cleaning** – The unit should be cleaned only as recommended. See the Maintenance section of this manual for cleaning instructions.
7. **Objects and Liquid Entry** – Care should be taken so that objects do not fall and liquids are not spilled into any openings or vents located on the product.
8. **Attachments** – Do not use attachments not recommended by the product manufacturer.
9. **Lightning and Power Surge Protection** – Unplug the unit from the wall socket and disconnect the antenna or cable system during a lightning storm or when it is left unattended and unused for long periods of time. This will prevent damage to the product due to lightning and power-line surges.
10. **Overloading** – Do not overload wall sockets, extension cords, or integral convenience receptacles as this can result in a risk of fire or electric shock.
11. **Damage Requiring Service** – The unit should be serviced by qualified service personnel when:
 - A. the power supply cable or plug has been damaged.
 - B. objects have fallen into or liquid has been spilled into the enclosure.
 - C. the unit has been exposed to rain.
 - D. the unit has been dropped or the enclosure damaged.
 - E. the unit exhibits a marked change in performance or does not operate normally.
12. **Periods of Nonuse** – If the unit is to be left unused for an extended period of time, such as a month or longer, the power cable should be unplugged and batteries removed from the unit to prevent damage or corrosion.
13. **Servicing** – The user should not attempt to service the unit beyond those methods described in the user's operating instructions. Service methods not covered in the operating instructions should be referred to qualified service personnel.

Questions? Visit www.ihomeaudio.com

Troubleshooting

Symptom	Possible Problem	Solution
Unit doesn't respond (no power)	AC adaptor isn't plugged into a wall outlet or the connector is not plugged into the power supply jack on the back of the unit	Plug the AC adaptor into a wall outlet and plug the connector into the supply jack on the unit
	Wall outlet is not functioning or switched off	Plug another device into the same outlet to confirm the outlet is working. Make sure any associated power switch is ON.
	Batteries are weak or dead	Replace with new batteries
iPod does not dock properly	Using no or wrong iPod insert	Make sure the dock insert is the proper fit for your iPod
	iPod not installed properly	Remove your iPod from the dock and check for obstruction on the connectors in the dock and on your iPod. Make sure there is no "skin" or case on the iPod. Then reseat it in the dock.
Battery Low icon always flashing	Batteries are weak	Replace with new batteries
	Batteries were not installed properly	Check to make sure the polarity (+ and – ends) matches the diagram in the battery compartment
iPod does not charge	Operating on battery power	Unit must be running on AC power to charge iPod. It will not charge your iPod when operating on battery power.
iPod does not respond to the unit	iPod is not installed properly	Remove your iPod from the dock and check for obstruction on the connectors in the dock and on your iPod. Then reseat it in the dock.
	Your iPod software is too old	Upgrade software on your iPod via iTunes
	iPod is locked up	Please make sure your iPod is working properly before docking into the unit. Please refer to your iPod manual for details.
	Using 1 st or 2 nd generation iPod, iPod shuffle or other devices.	iH24 cannot control those iPods or other devices.
Buttons/Controls don't work	Travel Lock is in Lock position	Move Travel Lock to Off or Remote position
iPod does not come on immediately	If your iPod is not used for some time, it may enter deep sleep mode	Press the Menu button on your iPod
	iPod battery is too run down/weak	Charge your iPod for about 5 minutes

NOTE: THIS UNIT DOES NOT CONTROL OR CHARGE 3G iPod

Troubleshooting

Symptom	Possible Problem	Solution
Unit doesn't respond (no power)	AC adaptor isn't plugged into a wall outlet or the connector is not plugged into the power supply jack on the back of the unit	Plug the AC adaptor into a wall outlet and plug the connector into the supply jack on the unit
	Wall outlet is not functioning or switched off	Plug another device into the same outlet to confirm the outlet is working. Make sure any associated power switch is ON.
	Batteries are weak or dead	Replace with new batteries
iPod does not dock properly	Using no or wrong iPod insert	Make sure the dock insert is the proper fit for your iPod
	iPod not installed properly	Remove your iPod from the dock and check for obstruction on the connectors in the dock and on your iPod. Make sure there is no "skin" or case on the iPod. Then reseat it in the dock.
Battery Low icon always flashing	Batteries are weak	Replace with new batteries
	Batteries were not installed properly	Check to make sure the polarity (+ and – ends) matches the diagram in the battery compartment
iPod does not charge	Operating on battery power	Unit must be running on AC power to charge iPod. It will not charge your iPod when operating on battery power.
iPod does not respond to the unit	iPod is not installed properly	Remove your iPod from the dock and check for obstruction on the connectors in the dock and on your iPod. Then reseat it in the dock.
	Your iPod software is too old	Upgrade software on your iPod via iTunes
	iPod is locked up	Please make sure your iPod is working properly before docking into the unit. Please refer to your iPod manual for details.
	Using 1 st or 2 nd generation iPod, iPod shuffle or other devices.	iH24 cannot control those iPods or other devices.
Buttons/Controls don't work	Travel Lock is in Lock position	Move Travel Lock to Off or Remote position
iPod does not come on immediately	If your iPod is not used for some time, it may enter deep sleep mode	Press the Menu button on your iPod
	iPod battery is too run down/weak	Charge your iPod for about 5 minutes

NOTE: THIS UNIT DOES NOT CONTROL OR CHARGE 3G iPod

Troubleshooting

Symptom	Possible Problem	Solution
iPod didn't charge	Operating iH24 on batteries. The iH24 only charges iPod while operating on AC power	Make sure the iH24 is plugged into a working AC outlet to charge your iPod
	iPod is not installed properly	Remove your iPod from the dock and check for obstruction on the connectors in the dock and on your iPod. Then replace it in the dock.
	iPod is locked up/ frozen	Please make sure your iPod is working properly before docking into the unit. Please refer to your iPod manual for details.
	iPod battery has problem	
Sound is distorted	Volume level is set too high	Decrease the volume
	Sound source is distorted	If the iPod original sound source (MP3) is of poor quality, distortion and noise are easily noticed with high-power speakers. Try a different audio source such as a music CD.
		If you are using an external sound source like older generation of iPod, try reducing the output volume on the device itself.
		Try turning bass boost OFF on your iPod/sound source.
	Batteries are weak	Replace current batteries with new ones
Remote Control didn't work	Remote Control is not pointed toward the iH24 remote sensor or sensor is blocked	Point the Remote Control toward the iH24, move within 10 feet of the unit, make sure sensor is unobstructed
	Battery weak	Replace current battery with new battery
	Travel Lock is in Lock or Off position	Move Travel Lock switch to Remote position

Limited 90-Day Warranty Information

Home Products, a division of SDI Technologies Inc. (hereafter referred to as SDI Technologies), warrants this product to be free from defects in workmanship and materials, under normal use and conditions, for a period of 90 days from the date of original purchase.

Should this product fail to function in a satisfactory manner, it is best to first return it to the store where it was originally purchased. Should this fail to resolve the matter and service still be required by reason of any defect or malfunction during the warranty period, SDI Technologies will repair or, at its discretion, replace this product without charge (except for a \$10.00 charge for handling, packing, return UPS/postage, and insurance). This decision is subject to verification of the defect or malfunction upon delivery of this product to the Factory Service Center listed below. The product must include proof of purchase, including date of purchase. The fee for service without proof of purchase is \$30.00.

Before returning this product for service, please first replace the batteries (if applicable) with fresh ones, as exhausted or defective batteries are the most common cause of problems encountered.

If service is still required:

1. Remove the batteries (if applicable) and pack the unit in a well padded, heavy corrugated box.
2. Enclose a photocopy of your sales receipt, credit card statement, or other proof of the date of purchase, if within the warranty period.
3. Enclose a check or money order payable to the order of SDI Technologies, for the sum of \$10.00 (\$30.00 without proof of purchase).
4. Send the unit prepaid and insured, to the Factory Service Center listed below.

Consumer Repair Department
SDI Technologies Inc.
1330 Goodyear Drive
El Paso, TX 79936-6420

Disclaimer of Warranty

NOTE: This warranty is valid only if the product is used for the purpose for which it was designed. It does not cover (i) products which have been damaged by negligence or willful actions, misuse or accident, or which have been modified or repaired by unauthorized persons; (ii) cracked or broken cabinets, or units damaged by excessive heat; (iii) damage to digital media players, CD's or tape cassettes (if applicable); (iv) the cost of shipping this product to the Factory Service Center and its return to the owner.

This warranty is valid only in the United States of America and does not extend to owners of the product other than to the original purchaser. In no event will SDI Technologies or any of its affiliates, contractors, resellers, their officers, directors, shareholders, members or agents be liable to you or any third party for any consequential or incidental damages, any lost profits, actual, exemplary or punitive damages. (Some states do not allow limitations on implied warranties or exclusion of consequential damages, so these restrictions may not apply to you.) This warranty gives you specific legal rights, and you may also have other rights which vary from state to state.

Your acknowledgment and agreement to fully and completely abide by the above mentioned disclaimer of warranty is contractually binding to you upon your transfer of currency (money order, cashier's check, or credit card) for purchase of your SDI Technologies product.

© 2009 SDI Technologies, Inc. All rights reserved

**Questions? Visit www.ihomeaudio.com
For any other questions: 1-800-288-2792 Toll Free**

Free Manuals Download Website

<http://myh66.com>

<http://usermanuals.us>

<http://www.somanuals.com>

<http://www.4manuals.cc>

<http://www.manual-lib.com>

<http://www.404manual.com>

<http://www.luxmanual.com>

<http://aubethermostatmanual.com>

Golf course search by state

<http://golfingnear.com>

Email search by domain

<http://emailbydomain.com>

Auto manuals search

<http://auto.somanuals.com>

TV manuals search

<http://tv.somanuals.com>